

MUNICIPALITY OF LANCASTER

PREPARED BY THE
MINNESOTA DEPARTMENT OF TRANSPORTATION
OFFICE OF TRANSPORTATION SYSTEM MANAGEMENT

IN COOPERATION WITH
U.S. DEPARTMENT OF TRANSPORTATION
FEDERAL HIGHWAY ADMINISTRATION

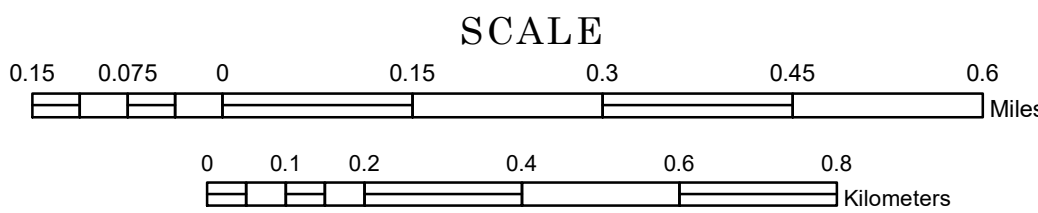

1 in = 800 ft

2024

Projection:
Transverse Mercator
NAD 1986
UTM Zone 15

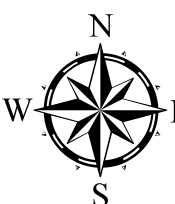

North American Datum
of 1986

ROAD AND ROADWAY FEATURES		PUBLIC SERVICE FEATURES	
INTERSTATE		MINOT OFFICE	
US HIGHWAY		MINOT TRUCK STATION	
MIN HIGHWAY		HIGHWAY PATROL DISTRICT OFFICE	
COUNTY STATE AID HIGHWAY		STATE TRAVEL INFORMATION CENTER	
COUNTY ROAD		REST AREA (FULL SERVICE)	
MUNICIPAL STREET		REST AREA (NIGHT SERVICE)	
MUNICIPAL STATE AID STREET		WAYSIDE (NIGHT OR PH TOLLY)	
PRIVATE STREET/ROAD		PUBLIC ACCESS POINT	
TOWNSHIP ROAD		LOCAL PARK	
UNORGANIZED TERRITORY ROAD		FAIRGROUNDS	
RAMP OR CONNECTOR		PORT OF ENTRY	
INTERSTATE EXIT		PARK AND RIDE LOT	
GREAT RIVER ROAD		PUBLIC UNIVERSITY/COLLEGE	
OTHER ROADS		PRIVATE UNIVERSITY/COLLEGE	
FARMROAD		ELEMENTARY SCHOOL	
INDIAN SERVICE		MIDDLE SCHOOL	
MILITARY		STATE GAME	
RAILROAD AND RAILWAY FEATURES		AVIATION FEATURES	
RAILWAY		COMMERCIAL AIRPORT	
EMPIRE BUILDER STATION (AIRLINE)		GENERAL AIRPORT	
NORTHSTAR STATION (COMMUTER)		AIRSTRIP	
LIGHT RAIL		SEAPLANE	
BLUE LINE STATION		AIRPORT RUNWAY	
GREEN LINE STATION		CULTURAL FEATURES	
INFRASTRUCTURE FEATURES		STATE HISTORICAL MARKER	
LONG BRIDGE (100' OR GREATER SPAN)		HISTORIC DISTRICT	
MAJOR BRIDGE (20' TO 100' SPAN)		HISTORIC SITE	
MINOR BRIDGE (2' TO 20' SPAN)		MONUMENT	
ROAD TUNNEL (100' OR GREATER SPAN)		CEMETERY	
RAILROAD BRIDGE (100' OR GREATER SPAN)		BOUNDARY FEATURES	
RAILROAD BRIDGE (LESSER 100' SPAN)		TRIBAL LAND	
SKYWAY		COUNTY	
PEDESTRIAN BRIDGE		MUNICIPALITY	
PEDESTRIAN TUNNEL		ADJACENT MUNICIPALITY	
DAM		FEDERAL ADJUSTED URBAN AREA (2014)	
LOCK AND DAM		MILITARY	
PUBLIC FACILITIES		STATE PARK	
STATE CAPITOL		REGIONAL PARK	
FEDERAL COURTHOUSE		NATIONAL FOREST	
COUNTY COURTHOUSE		NATIONAL AND STATE FOREST	
ARMORY		STATE FOREST	
CITY HALL		NATIONAL TRAIL	
TOWN HALL		WILDLIFE REFUGE AREA	
COMMUNITY CENTER		WILDLIFE MANAGEMENT AREA	
ARENA		HYDROLOGIC FEATURES	
STADIUM		RIVER OR STREAM (PERMANENT)	
POST OFFICE		LAKE, POND OR RESERVOIR	
POLICE STATION		STREAM (PERMANENT FLOW)	
FIRE STATION		DRAINAGE DITCH	
PUBLIC LIBRARY		WETLAND	
PUBLIC MUSEUM		ISLAND OR LAND	
EVENT CENTER		REGIONAL WATERSHED	
CITY CENTERS			
TRIBAL GOVERNMENT CENTER			
CITY CENTER			
LOCALLY KNOWN PLACE			
UNINCORPORATED COMMUNITY			

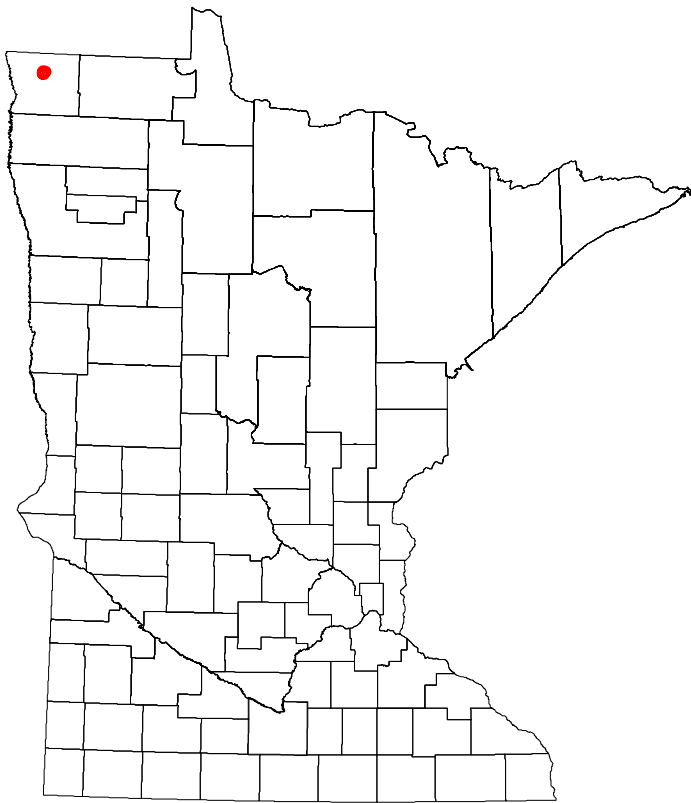

Population (U.S. Census 2020): 364

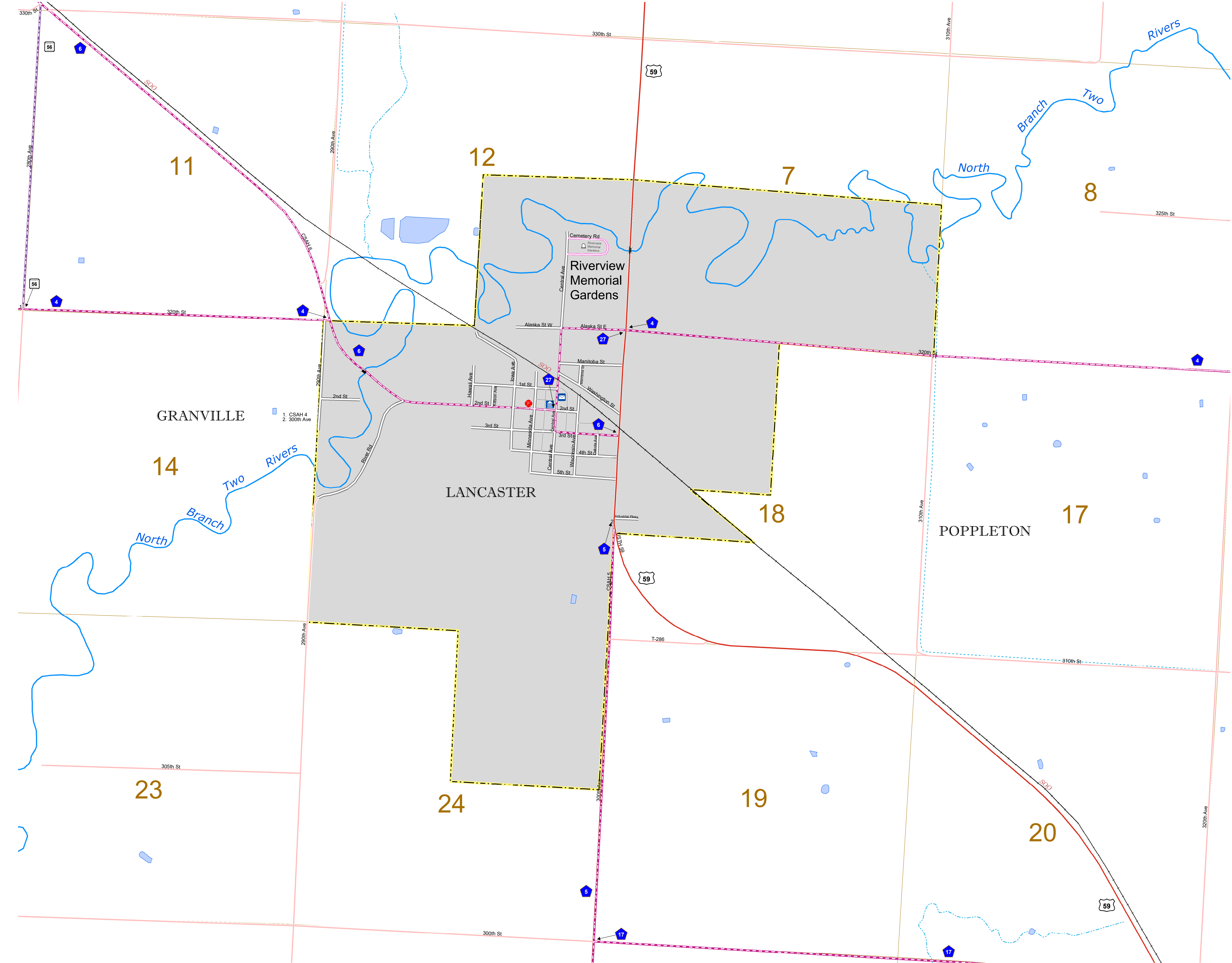

To request information from this document in an alternative format, call 651-366-4718 or 1-800-657-3774 (Greater Minnesota); 711 or 1-800-627-3529 (Minnesota Relay). You may also send an e-mail to ADArequest.dot@state.mn.us. (Please request at least one week in advance.)

LAST EDITED ON 11-19-2024