

26

27

MUNICIPALITY OF
CLEMENTS

PREPARED BY THE
MINNESOTA DEPARTMENT OF TRANSPORTATION
OFFICE OF TRANSPORTATION SYSTEM MANAGEMENT

IN COOPERATION WITH
U.S. DEPARTMENT OF TRANSPORTATION
FEDERAL HIGHWAY ADMINISTRATION

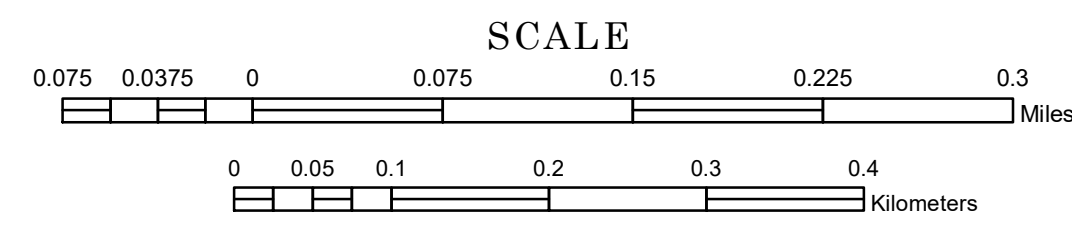

1 in = 400 ft

2024

Projection:
Transverse Mercator
NAD 1986
UTM Zone 15

North American Datum
of 1986

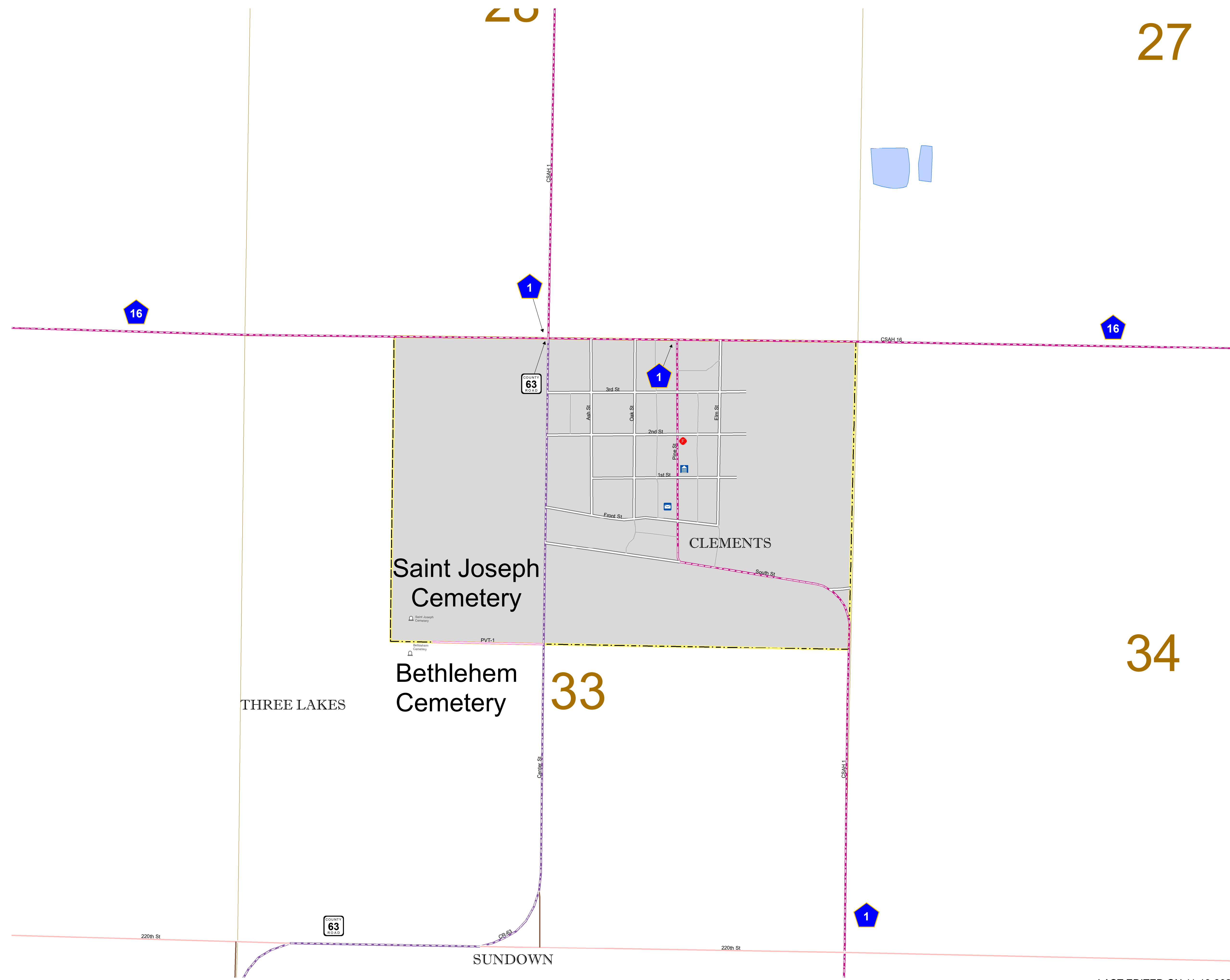

ROAD AND ROADWAY FEATURES		PUBLIC SERVICE FEATURES	
INTERSTATE		MINOT OFFICE	
US HIGHWAY		MINOT TRUCK STATION	
MIN HIGHWAY		HIGHWAY PATROL DISTRICT OFFICE	
COUNTY STATE AID HIGHWAY		STATE TRAVEL INFORMATION CENTER	
COUNTY ROAD		REST AREA (FULL SERVICE)	
MUNICIPAL STREET		REST AREA (NIGHT TRUCK STOP)	
MUNICIPAL STATE AID STREET		WAYSIDE (NIGHT OR PM TRUCK STOP)	
PRIVATE STREET/ROAD		PUBLIC ACCESS POINT	
TOWNSHIP ROAD		LOCAL PARK	
UNORGANIZED TERRITORY ROAD		FAIRGROUNDS	
RAMP OR CONNECTOR		PORT OF ENTRY	
INTERSTATE EXIT		PARK AND RIDE LOT	
GREAT RIVER ROAD		PUBLIC UNIVERSITY/COLLEGE	
OTHER ROADS		PRIVATE UNIVERSITY/COLLEGE	
FARMROAD		ELEMENTARY SCHOOL	
STATE PARK		MIDDLE SCHOOL	
NATIONAL PARK		HIGH SCHOOL	
NATIONAL MONUMENT		AVIATION FEATURES	
STATE FOREST		COMMERCIAL AIRPORT	
NATIONAL FOREST		GENERAL AIRPORT	
NATIONAL WILDLIFE STATE GAME		AIRSTRIPE	
RAILROAD AND RAILWAY FEATURES		SEAPLANE	
RAILWAY		AIRPORT RUNWAY	
EMPIRE BUILDER STATION (AMTRAK)		CULTURAL FEATURES	
NORTHSTAR STATION (COMMUTER)		STATE HISTORIC MARKER	
LIGHT RAIL		HISTORIC DISTRICT	
BLUE LINE STATION		HISTORIC SITE	
GREEN LINE STATION		MONUMENT	
INFRASTRUCTURE FEATURES		CEMETERY	
LONG BRIDGE (100' OR GREATER SPAN)		BOUNDARY FEATURES	
MAJOR BRIDGE (20' TO 100' SPAN)		TRIBAL LAND	
MINOR BRIDGE (2' TO 20' SPAN)		COUNTY	
ROAD TUNNEL (100' OR GREATER SPAN)		MUNICIPALITY	
RAILROAD BRIDGE (100' OR GREATER SPAN)		ADJACENT MUNICIPALITY	
RAILROAD BRIDGE (UNDER 100' SPAN)		FEDERAL ADJUSTED URBAN AREA (2014)	
SKYWAY		MILITARY	
PEDESTRIAN BRIDGE		STATE PARK	
PEDESTRIAN TUNNEL		REGIONAL PARK	
LOCK AND DAM		NATIONAL FOREST	
PUBLIC FACILITIES		NATIONAL AND STATE FOREST	
STATE CAPITOL		STATE FOREST	
FEDERAL COURTHOUSE		NATIONAL TRAIL	
COUNTY COURTHOUSE		WILDLIFE REFUGE AREA	
ARMORY		WILDLIFE MANAGEMENT AREA	
CITY HALL		HYDROLOGIC FEATURES	
TOWN HALL		RIVER OR STREAM (PERMANENT)	
COMMUNITY CENTER		LAKE, POND OR RESERVOIR	
ARENA		STREAM (INTERMITTENT)	
STADIUM		DRAINAGE DITCH	
POST OFFICE		WETLAND	
POLICE STATION		WETLAND	
FIRE STATION		ISLAND OR LAND	
PUBLIC LIBRARY		REGIONAL WATERSHED	
PUBLIC MUSEUM			
EVENT CENTER			
CITY CENTERS			
TRIBAL GOVERNMENT CENTER			
CITY CENTER			
LOCALLY KNOWN PLACE			
UNINCORPORATED COMMUNITY			

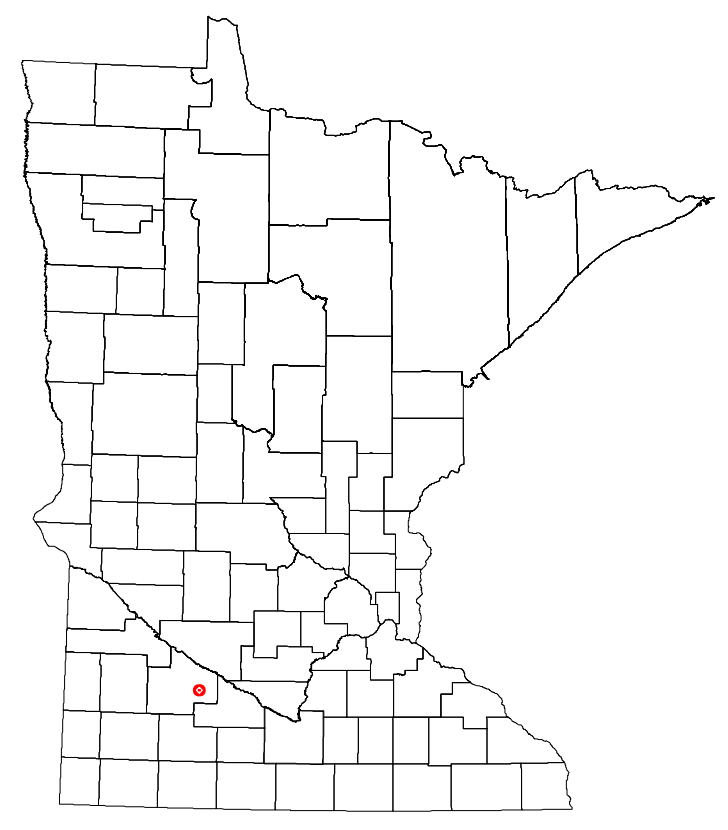

To request information from this document in an alternative format, call 651-366-4718 or 1-800-657-3774 (Greater Minnesota); 711 or 1-800-627-3529 (Minnesota Relay). You may also send an e-mail to ADArequest.dot@state.mn.us. (Please request at least one week in advance.)

LAST EDITED ON 11-19-2024

Population (U.S. Census 2020): 155