

TOWNSHIP OF MAY

PREPARED BY THE
MINNESOTA DEPARTMENT OF TRANSPORTATION
OFFICE OF TRANSPORTATION SYSTEM MANAGEMENT

IN COOPERATION WITH
U.S. DEPARTMENT OF TRANSPORTATION
FEDERAL HIGHWAY ADMINISTRATION

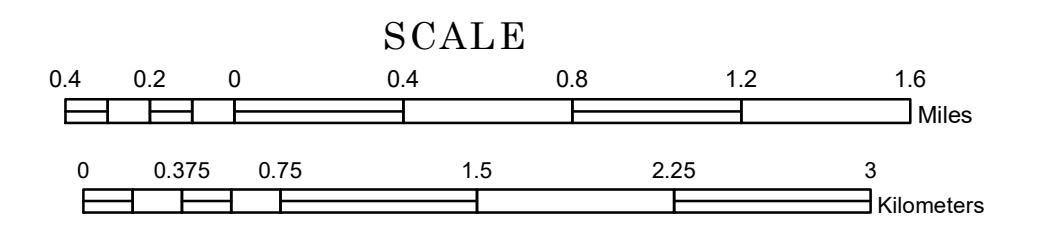

1 in = 2,400 ft
2024

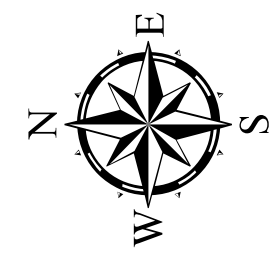

Projection:
Transverse Mercator
NAD 1986
UTM Zone 15

North American Datum
of 1986

ROAD AND ROADWAY FEATURES		BOUNDARY FEATURES	
INTERSTATE	CONCRETE	TRIAL LAND	STATE OF MINNESOTA
US HIGHWAY	BITUMINOUS	COUNTY	MUNICIPALITY
MN HIGHWAY	GRAVEL	UNINCORPORATED TOWNSHIP	CIVIL TOWNSHIP
COUNTY STATE AID HIGHWAY	DIRT/UNIMPROVED	CONGRESSIONAL TOWNSHIP	SECTION
COUNTY ROAD	OTHER	MILITARY	VOYAGEURS NATIONAL PARK
TOWNSHIP ROAD	UNKNOWN	UNINCORPORATED COMMUNITY	BOUNDARY WATERS CANOE AREA WILDERNESS
UNORGANIZED TERRITORY ROAD			STATE PARK
OTHER ROADS:			REGIONAL PARK
Municipal	RAMP OR CONNECTOR		NATIONAL FOREST
Private	INTERSTATE EXIT		NATIONAL AND STATE FOREST
National Monument	GREAT RIVER ROAD		STATE FOREST
National Wildlife Refuge	AVIATION FEATURES		WILDLIFE REFUGE AREA
State Park	COMMERCIAL AIRPORT		WILDLIFE MANAGEMENT AREA
Preserve	GENERAL AIRPORT		HYDROLOGIC FEATURES
	AIRSTRIP		LAKE, POND OR RESERVOIR
	SEAPLANE		STREAM (INTERMITTENT)
	AIRPORT RUNWAY		DRAINAGE DITCH
			WETLAND
			ISLAND OR LAND
			REGIONAL WATERSHED

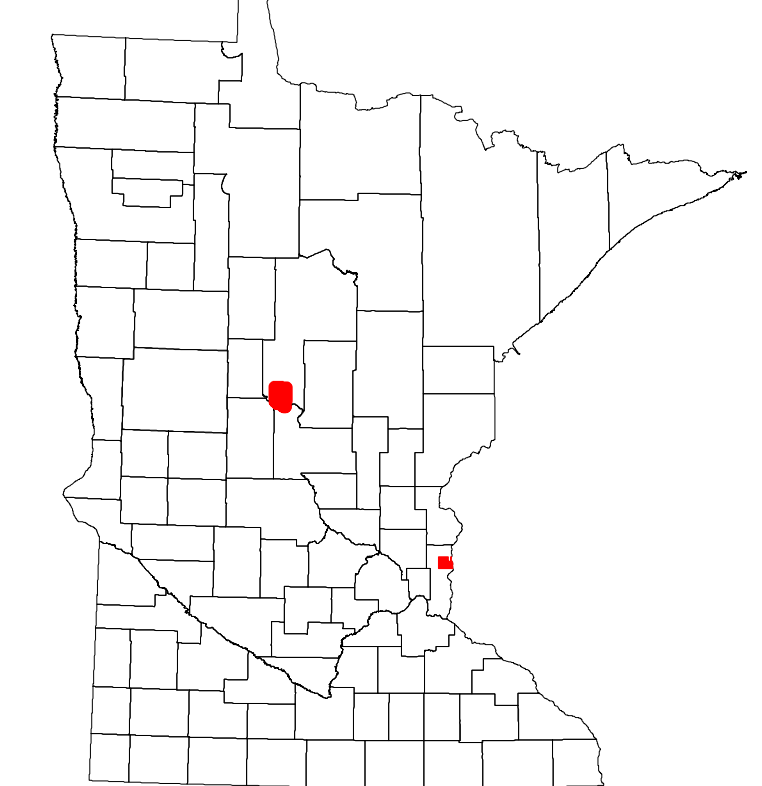

Population (U.S. Census 2010): 852

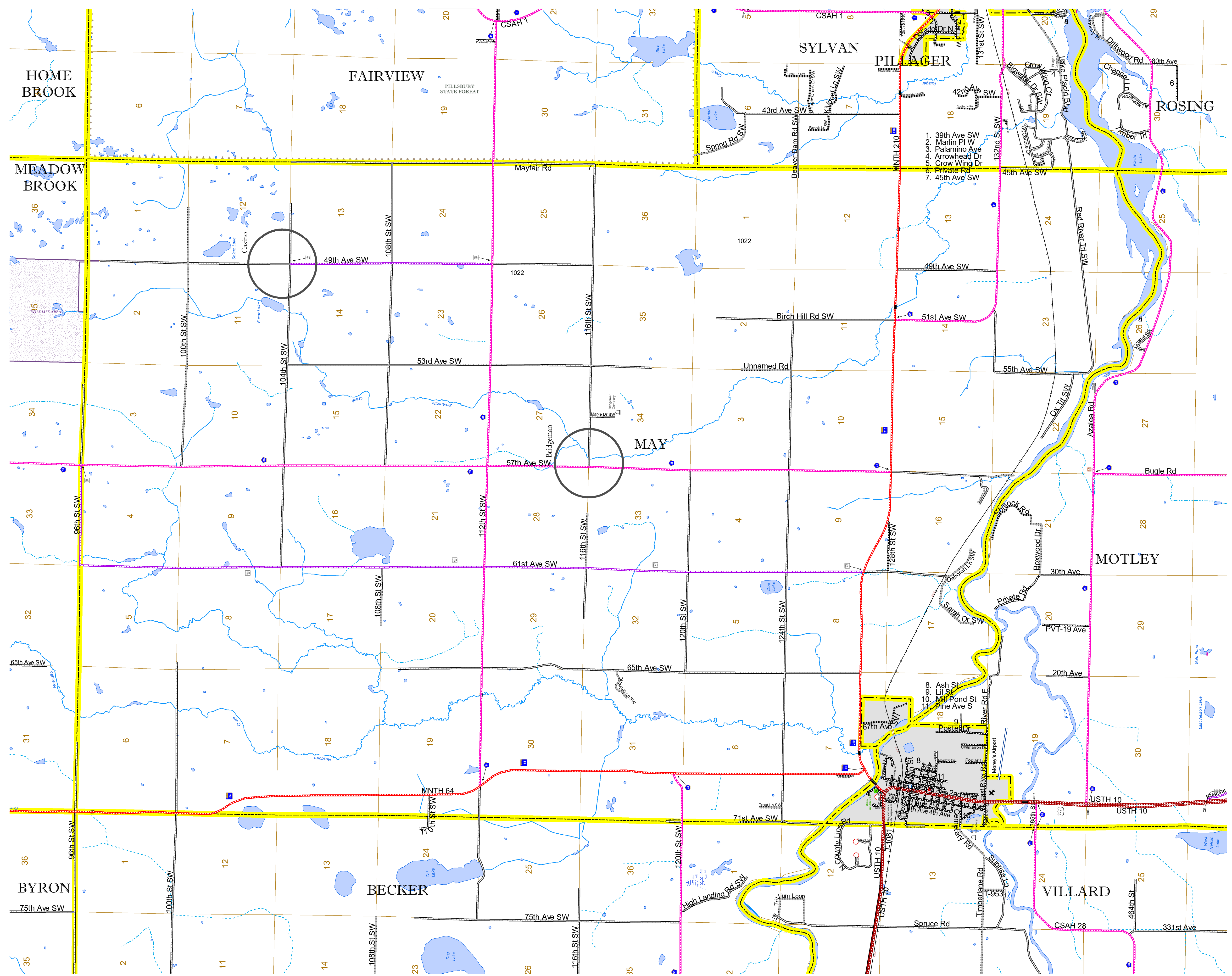

To request information from this document in an alternative format, call 651-366-4718 or 1-800-657-3774 (Greater Minnesota); 711 or 1-800-627-3529 (Minnesota Relay). You may also send an e-mail to ADARquest.dot@state.mn.us. (Please request at least one week in advance.)