

TOWNSHIP OF SELMA

PREPARED BY THE
MINNESOTA DEPARTMENT OF TRANSPORTATION
OFFICE OF TRANSPORTATION SYSTEM MANAGEMENT

IN COOPERATION WITH
U.S. DEPARTMENT OF TRANSPORTATION
FEDERAL HIGHWAY ADMINISTRATION

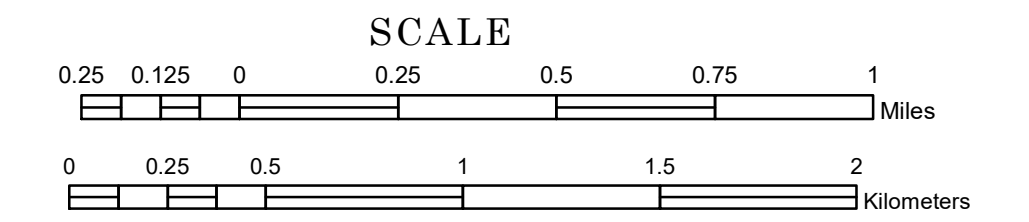

1 in = 1,600 ft

2024

Projection:
Transverse Mercator
NAD 1986
UTM Zone 15

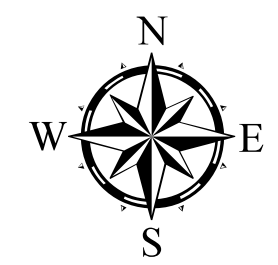

North American Datum
of 1986

ROAD AND ROADWAY FEATURES		
INTERSTATE	CONCRETE	
US HIGHWAY	BITUMINOUS	
MN HIGHWAY	GRAVEL	
COUNTY STATE AID HIGHWAY	DIRT/UNIMPROVED	
COUNTY ROAD	OTHER	
TOWNSHIP ROAD	UNKNOWN	
UNORGANIZED TERRITORY ROAD		
OTHER ROADS	RAMP OR CONNECTOR	
Municipal	National Monument	
Nature Service	National Park	
Museum	National Wildlife	
	State Game	
	National Forest	
	State Park	
	Preserve	
RAILROAD AND RAILWAY FEATURES		
EMPIRE BUILDER STATION (AMTRAK)	COMMERCIAL AIRPORT	
NORTHSTAR STATION (COMPUTER)	GENERAL AIRPORT	
LIGHT RAIL	AIRSTRIP	
BLUE LINE	SEAPLANE	
GREEN LINE	AIRPORT RUNWAY	
INFRASTRUCTURE FEATURES		
LONG BRIDGE (200' or Greater Span)	TRIAL LAND	
MAJOR BRIDGE (20' to 200' Span)	STATE OF MINNESOTA	
MINOR BRIDGE (5' to 20' Span)	COUNTY	
DAM	MUNICIPALITY	
LOCK AND DAM	UNORGANIZED TERRITORY	
	FEDERAL ADJUSTED URBAN AREA (2014)	
	CIVIL TOWNSHIP	
	CONGRESSIONAL TOWNSHIP	
CITY CENTERS		
STATE CAPITAL	CITY CENTER	
COUNTY SEAT	UNINCORPORATED COMMUNITY	
PUBLIC SERVICE FEATURES		
MNDOT OFFICE	MILITARY	
HIGHWAY PATROL STATION	VOYAGEURS NATIONAL PARK	
STATE TRAVEL INFORMATION CENTER	BOUNDARY WATERS CANOE AREA WILDERNESS	
REST AREA (Full Service)	STATE PARK	
REST AREA (Vault Toilet)	NATIONAL PARK	
WAYSIDE (Vault or Pit Toilet)	NATIONAL FOREST	
PARK AND RIDE LOT	NATIONAL AND STATE FOREST	
PORT OF ENTRY	STATE FOREST	
PUBLIC ACCESS POINT	NATIONAL TRAIL	
MN STATE COLLEGE AND UNIVERSITY SYSTEM (MNSCU)	WILDLIFE REFUGUE AREA	
UNIVERSITY OF MN SYSTEM	WILDLIFE MANAGEMENT AREA	
FARSGROUNDS	HYDROLOGIC FEATURES	
	HYDROLOGIC FEATURES	
	RIVER OR STREAM (Perennial)	
	LAKE, POND OR RESERVOIR	
	STREAM (Intermittent)	
CULTURAL FEATURES		
STATE HISTORICAL MARKER	DRAINAGE DITCH	
HISTORIC DISTRICT	WETLAND	
HISTORIC SITE	ISLAND OR LAND	
MONUMENT	REGIONAL WATERSHED	

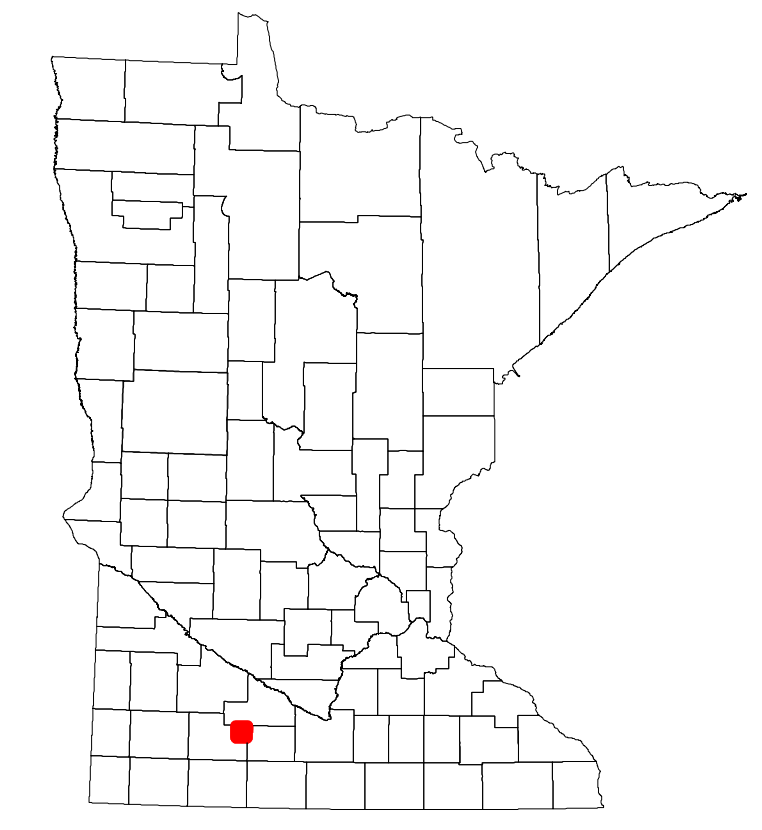

Population (U.S. Census 2010): 193

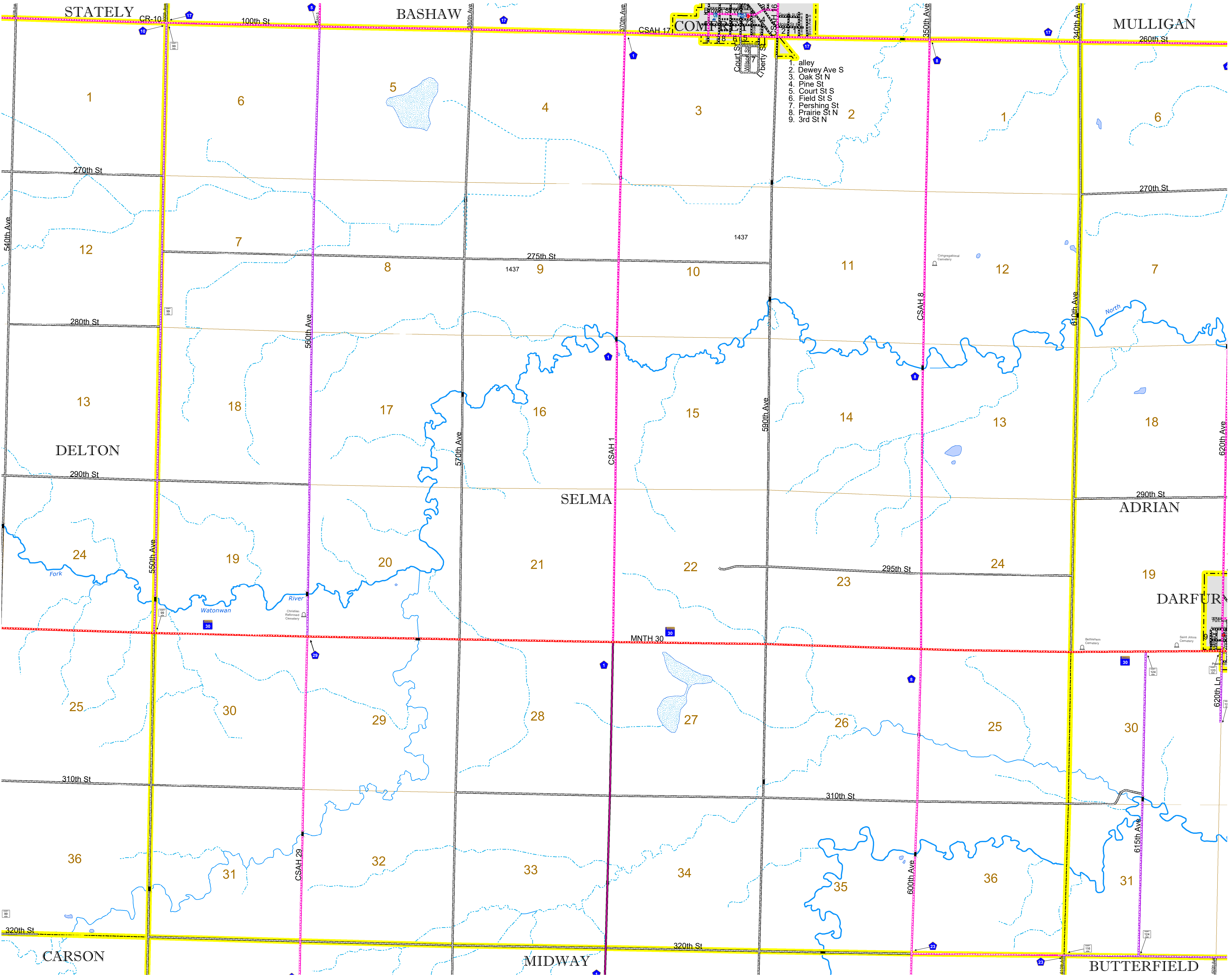

To request information from this document in an alternative format, call 651-366-4718 or 1-800-657-3774 (Greater Minnesota); 711 or 1-800-627-3529 (Minnesota Relay). You may also send an e-mail to ADArequest.dot@state.mn.us. (Please request at least one week in advance.)