

# TOWNSHIP OF CANISTEO

PREPARED BY THE  
MINNESOTA DEPARTMENT OF TRANSPORTATION  
OFFICE OF TRANSPORTATION SYSTEM MANAGEMENT

IN COOPERATION WITH  
U.S. DEPARTMENT OF TRANSPORTATION  
FEDERAL HIGHWAY ADMINISTRATION

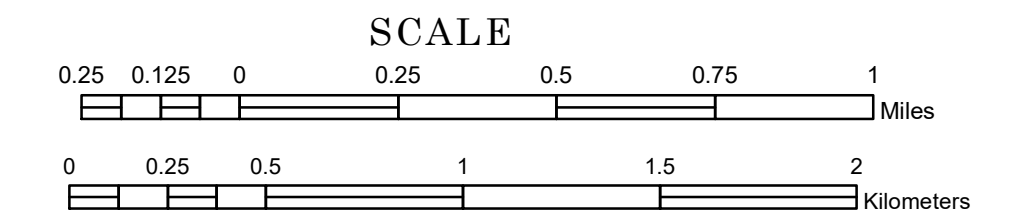

1 in = 1,600 ft

2024

Projection:  
Transverse Mercator  
NAD 1986  
UTM Zone 15

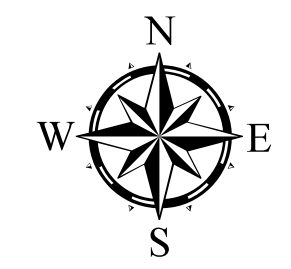

North American Datum  
of 1986

ROAD AND ROADWAY FEATURES		AVIATION FEATURES	
INTERSTATE	CONCRETE	COMMERCIAL AIRPORT	GENERAL AIRPORT
US HIGHWAY	BITUMINOUS	AIRSTRIP	SEAPLANE
MN HIGHWAY	GRAVEL	AIRPORT RUNWAY	
COUNTY STATE AID HIGHWAY	DIRT/UNIMPROVED		
COUNTY ROAD	OTHER		
TOWNSHIP ROAD	UNKNOWN		
UNORGANIZED TERRITORY ROAD			
OTHER ROADS			
Municipal	RAMP OR CONNECTOR		
Private	INTERSTATE EXIT		
National Monument	GREAT RIVER ROAD		
National Park			
National Wildlife Refuge			
State Park			
Preserve			
RAILROAD AND RAILWAY FEATURES		BOUNDARY FEATURES	
EMPIRE BUILDER STATION (AMTRAK)	TRIBAL LAND	STATE OF MINNESOTA	COUNTY
NORTHSTAR STATION (COMPUTER)	STATE OF MINNESOTA	MUNICIPALITY	UNORGANIZED TERRITORY
LIGHT RAIL	FEDERAL ADJUSTED URBAN AREA (2014)	CIVIL TOWNSHIP	CONGRESSIONAL TOWNSHIP
BLUE LINE			
GREEN LINE			
INFRASTRUCTURE FEATURES		CITY CENTERS	
LONG BRIDGE (200' or Greater Span)	STATE CAPITAL	COUNTY SEAT	CITY CENTER
MAJOR BRIDGE (20' to 200' Span)	UNINCORPORATED COMMUNITY		
MINOR BRIDGE (5' to 20' Span)			
DAM			
LOCK-AND-DAM			
PUBLIC SERVICE FEATURES		HYDROLOGIC FEATURES	
MNDOT OFFICE	WILDLIFE REFUGUE AREA	WILDLIFE REFUGUE AREA	WILDLIFE MANAGEMENT AREA
MNDOT TRUCK STATION	WILDLIFE MANAGEMENT AREA	RIVER OR STREAM (PERMANENT)	LAKE, POND OR RESERVOIR
HIGHWAY PATROL DISTRICT OFFICE	STATE FOREST	STREAM (INTERMITTENT)	DRAINAGE DITCH
STATE TRAVEL INFORMATION CENTER	NATIONAL FOREST	WETLAND	ISLAND OR LAND MONUMENT
REST AREA (Full Service)	NATIONAL AND STATE FOREST		
REST AREA (Vault Toilet)	STATE FOREST		
WAYSIDE (Vault or Pit Toilet)	WILDLIFE REFUGUE AREA		
PARK AND RIDE LOT	WILDLIFE MANAGEMENT AREA		
PORT OF ENTRY	UNIVERSITY OF MN SYSTEM		
PUBLIC ACCESS POINT	UNIVERSITY OF MN SYSTEM		
MN STATE COLLEGE AND UNIVERSITY SYSTEM (MNSCU)	FAIRGROUNDS		
CULTURAL FEATURES			
STATE HISTORICAL MARKER			
HISTORIC DISTRICT			
HISTORIC SITE			
MONUMENT			

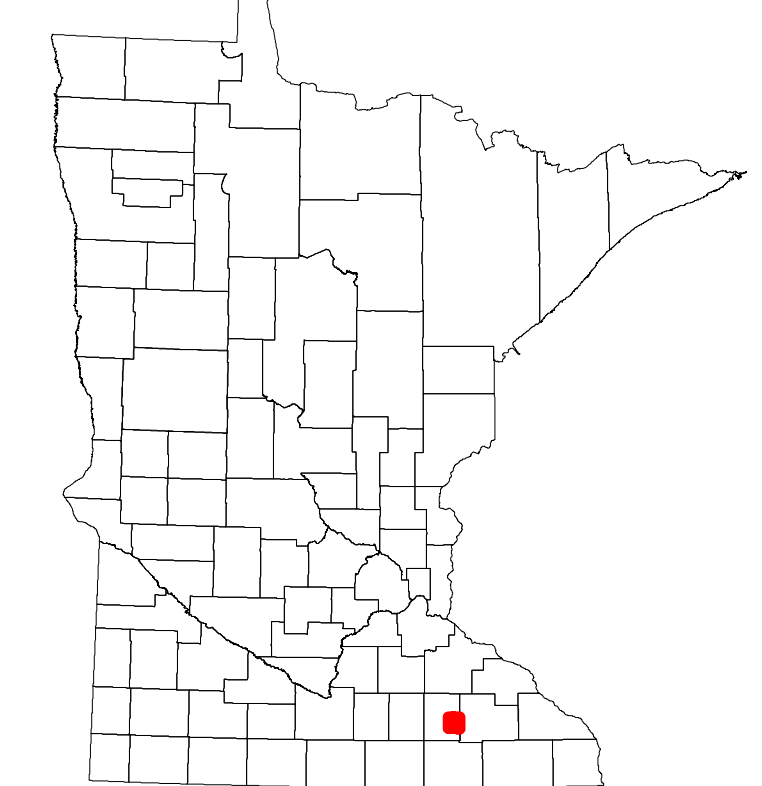

Population (U.S. Census 2010): 654

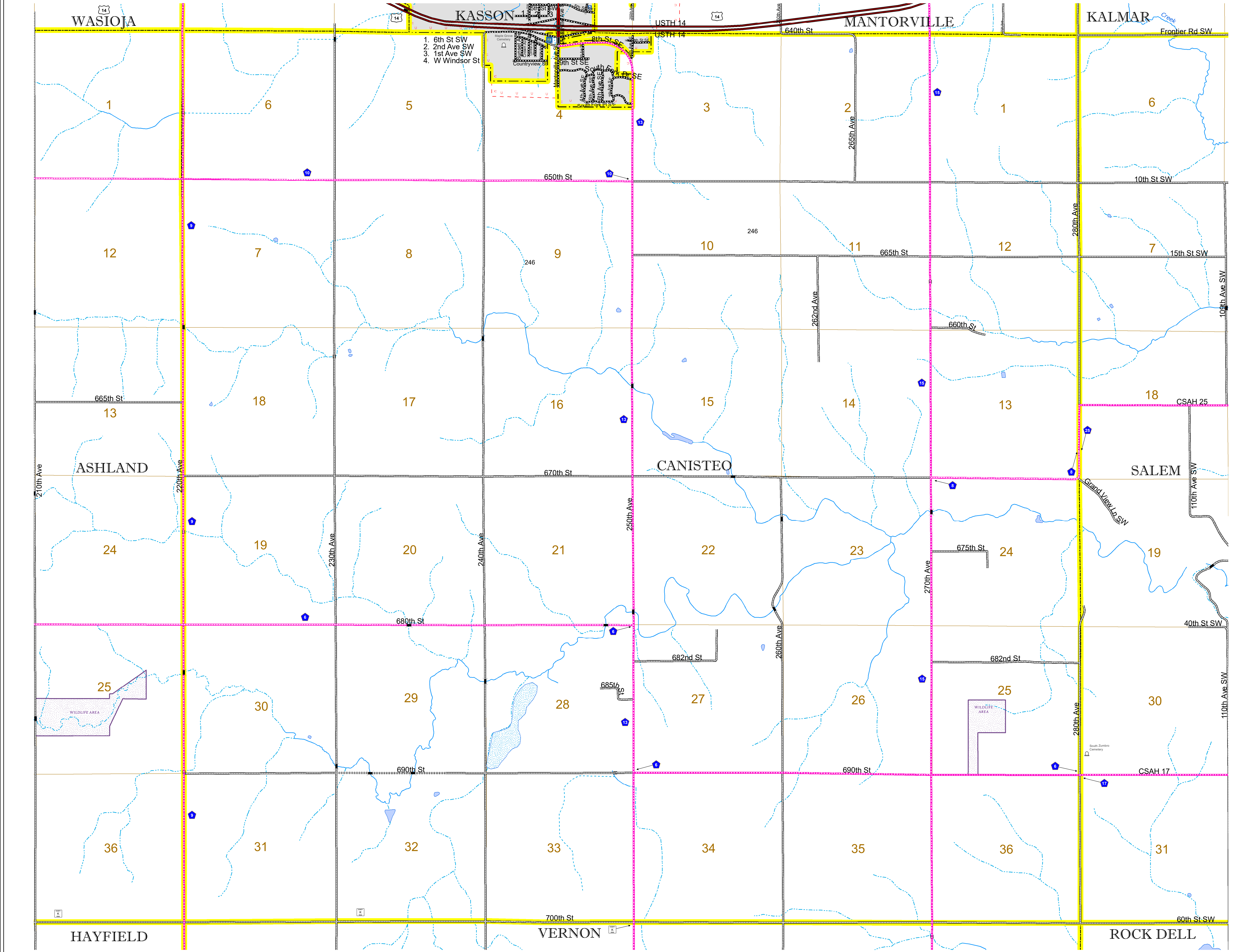

To request information from this document in an alternative format, call 651-366-4718 or 1-800-657-3774 (Greater Minnesota); 711 or 1-800-627-3529 (Minnesota Relay). You may also send an e-mail to ADARrequest.dot@state.mn.us. (Please request at least one week in advance.)