

# TOWNSHIP OF BELLE RIVER

PREPARED BY THE  
MINNESOTA DEPARTMENT OF TRANSPORTATION  
OFFICE OF TRANSPORTATION SYSTEM MANAGEMENT

IN COOPERATION WITH  
U.S. DEPARTMENT OF TRANSPORTATION  
FEDERAL HIGHWAY ADMINISTRATION

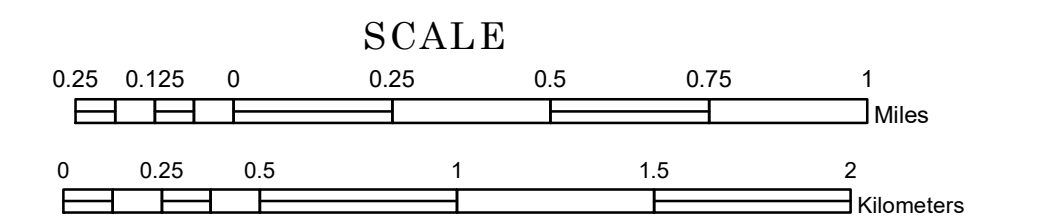

1 in = 1,600 ft  
**2023**

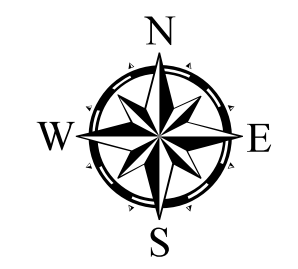

Projection:  
Transverse Mercator  
NAD 1986  
UTM Zone 15

ROAD AND ROADWAY FEATURES		RAILROAD AND RAILWAY FEATURES		BOUNDARY FEATURES	
INTERSTATE	[Symbol]	EMPIRE BUILDER STATION (AMTRAK)	[Symbol]	TRIBAL LAND	[Symbol]
US HIGHWAY	[Symbol]	NORTHSTAR STATION (COMMUTER)	[Symbol]	STATE OF MINNESOTA	[Symbol]
MN HIGHWAY	[Symbol]	LIGHT RAIL	[Symbol]	COUNTY	[Symbol]
COUNTY STATE AID HIGHWAY	[Symbol]	BLUE LINE	[Symbol]	MUNICIPALITY	[Symbol]
COUNTY ROAD	[Symbol]	GREEN LINE	[Symbol]	UNINCORPORATED TOWNSHIP	[Symbol]
TOWNSHIP ROAD	[Symbol]	LONG BRIDGE (200' OR GREATER SPAN)	[Symbol]	CIVIL TOWNSHIP	[Symbol]
UNORGANIZED TERRITORY ROAD	[Symbol]	MAJOR BRIDGE (20' TO 200' SPAN)	[Symbol]	CONGRESSIONAL TOWNSHIP	[Symbol]
OTHER ROADS	[Symbol]	MINOR BRIDGE (5' TO 20' SPAN)	[Symbol]	SECTION	[Symbol]
Municipal	[Symbol]	DAM	[Symbol]	MILITARY	[Symbol]
Private	[Symbol]	LOCK AND DAM	[Symbol]	VOYAGEURS NATIONAL PARK	[Symbol]
National Monument	[Symbol]			BOUNDARY WATERS CANOE AREA WILDERNESS	[Symbol]
State Forest	[Symbol]			STATE PARK	[Symbol]
National Wildlife Refuge	[Symbol]			REGIONAL PARK	[Symbol]
State Park	[Symbol]			NATIONAL FOREST	[Symbol]
Preserve	[Symbol]			NATIONAL AND STATE FOREST	[Symbol]
				STATE FOREST	[Symbol]
				WILDLIFE REFUGE AREA	[Symbol]
				WILDLIFE MANAGEMENT AREA	[Symbol]
				HYDROLOGIC FEATURES	[Symbol]
				RIVER OR STREAM (PERMANENT)	[Symbol]
				LAKE, POND OR RESERVOIR	[Symbol]
				STREAM (INTERMITTENT)	[Symbol]
				DRAINAGE DITCH	[Symbol]
				WETLAND	[Symbol]
				ISLAND OR LAND	[Symbol]
				REGIONAL WATERSHED	[Symbol]

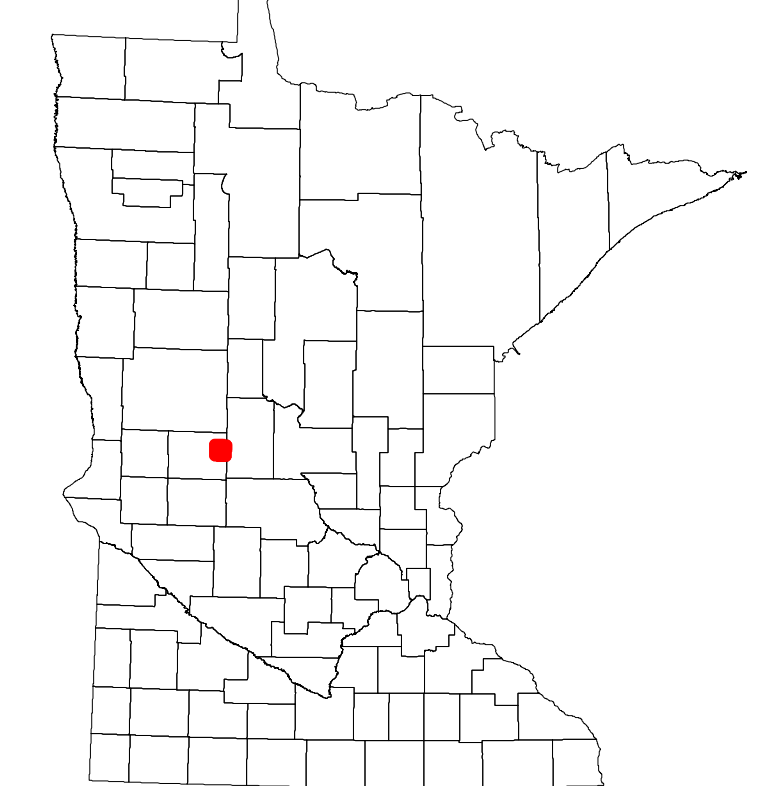

Population (U.S. Census 2010): 345

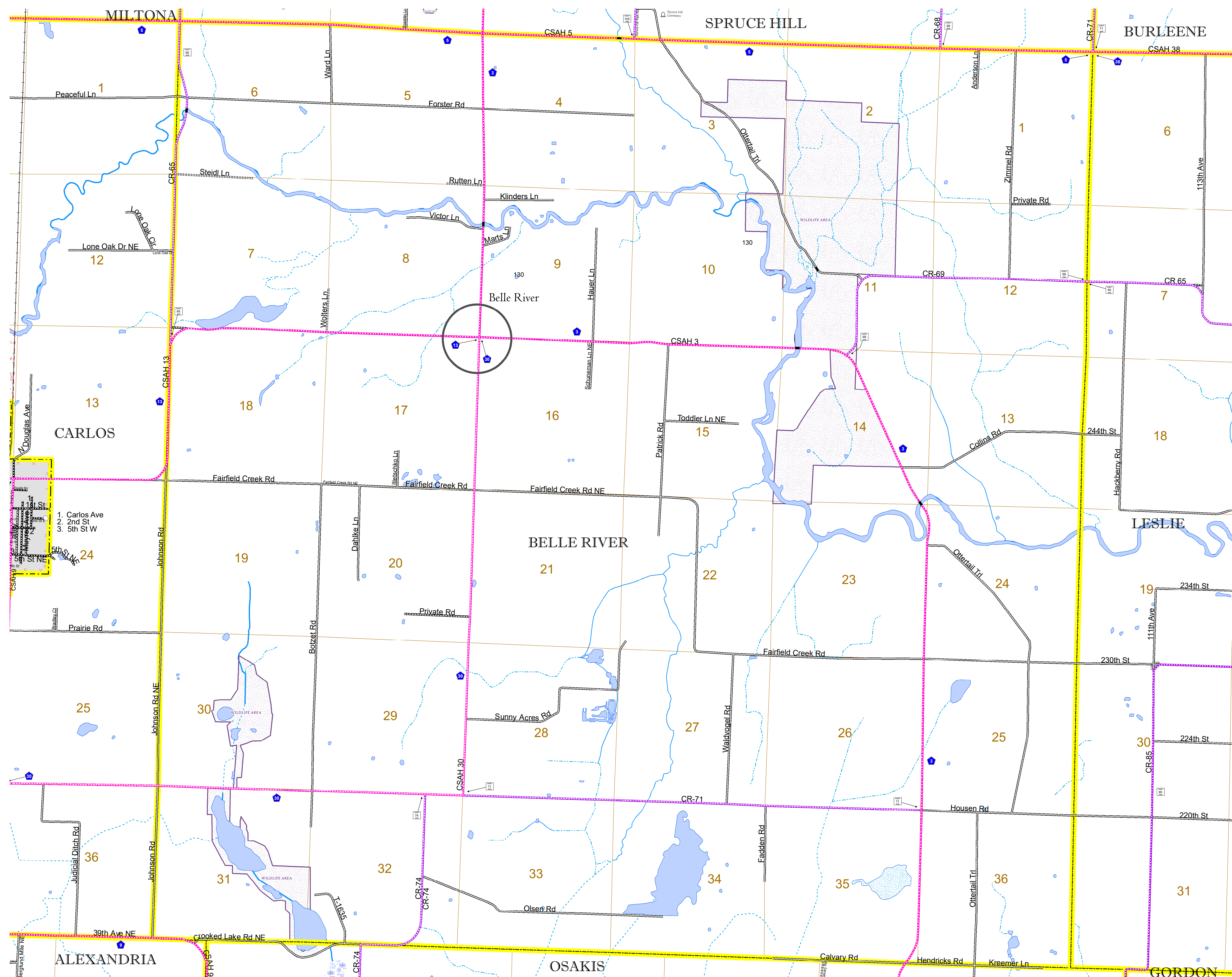

To request information from this document in an alternative format, call 651-366-4718 or 1-800-657-3774 (Greater Minnesota); 711 or 1-800-627-3529 (Minnesota Relay). You may also send an e-mail to ADarequest.dot@state.mn.us. (Please request at least one week in advance.)