

TOWNSHIP OF NEWBURG

PREPARED BY THE
MINNESOTA DEPARTMENT OF TRANSPORTATION
OFFICE OF TRANSPORTATION SYSTEM MANAGEMENT

IN COOPERATION WITH
U.S. DEPARTMENT OF TRANSPORTATION
FEDERAL HIGHWAY ADMINISTRATION

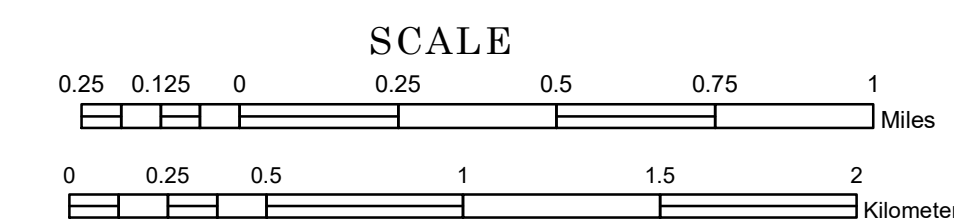

1 in = 1,600 ft
2024

Projection:
Transverse Mercator
NAD 1986
UTM Zone 15

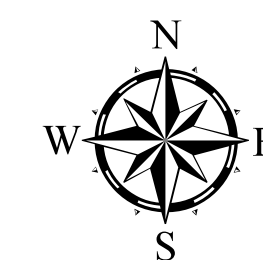

ROAD AND ROADWAY FEATURES		BOUNDARY FEATURES	
INTERSTATE		CONCRETE	
US HIGHWAY		BITUMINOUS	
MN HIGHWAY		GRAVEL	
COUNTY STATE AID HIGHWAY		DIRT/UNIMPROVED	
COUNTY ROAD		OTHER	
TOWNSHIP ROAD		UNKNOWN	
UNORGANIZED TERRITORY ROAD			
OTHER ROADS		RAMP OR CONNECTOR	
Municipal		INTERSTATE EXIT	
Private		AVIATION FEATURES	
National Monument		COMMERCIAL AIRPORT	
State Forest		GENERAL AIRPORT	
Nature Service		AIRSTRIP	
Military		SEAPLANE	
National Forest		AIRPORT RUNWAY	
State Park			
Preserve			
RAILROAD AND RAILWAY FEATURES		BOUNDARY FEATURES	
EMPIRE BUILDER STATION (AMTRAK)		TRIBAL LAND	
NORTHSTAR STATION (COMMUTER)		STATE OF MINNESOTA	
LIGHT RAIL		COUNTY	
BLUE LINE		MUNICIPALITY	
GREEN LINE		UNORGANIZED TERRITORY	
INFRASTRUCTURE FEATURES		FEDERAL ADJUSTED URBAN AREA (2014)	
LONG BRIDGE (200' OR GREATER SPAN)		CIVIL TOWNSHIP	
MAJOR BRIDGE (20' TO 200' SPAN)		CONGRESSIONAL TOWNSHIP	
MINOR BRIDGE (5' TO 20' SPAN)		SECTION	
DAM		MILITARY	
LOCK AND DAM		VOYAGEURS NATIONAL PARK	
CITY CENTERS		BOUNDARY WATERS CANOE AREA WILDERNESS	
STATE CAPITAL		STATE PARK	
COUNTY SEAT		REGIONAL PARK	
CITY CENTER		NATIONAL FOREST	
UNINCORPORATED COMMUNITY		NATIONAL AND STATE FOREST	
PUBLIC SERVICE FEATURES		STATE FOREST	
MN DOT OFFICE		NATIONAL TRAIL	
MN DOT TRUCK STATION		WILDLIFE REFUGE AREA	
HIGHWAY PATROL DISTRICT OFFICE		WILDLIFE MANAGEMENT AREA	
STATE TRAVEL INFORMATION CENTER		RIVER OR STREAM (PERMANENT)	
REST AREA (FULL SERVICE)		LAKE, POND OR RESERVOIR	
REST AREA (VAULT TOILET)		STREAM (INTERMITTENT)	
PARK AND RIDE LOT		DRAINAGE DITCH	
PORT OF ENTRY		WETLAND	
PUBLIC ACCESS POINT		ISLAND OR LAND	
MN STATE COLLEGE AND UNIVERSITY SYSTEM (MNSCU)		REGIONAL WATERSHED	
UNIVERSITY OF MN SYSTEM			
FAIRGROUNDS			
CULTURAL FEATURES			
STATE HISTORICAL MARKER			
HISTORIC DISTRICT			
HISTORIC SITE			
MONUMENT			

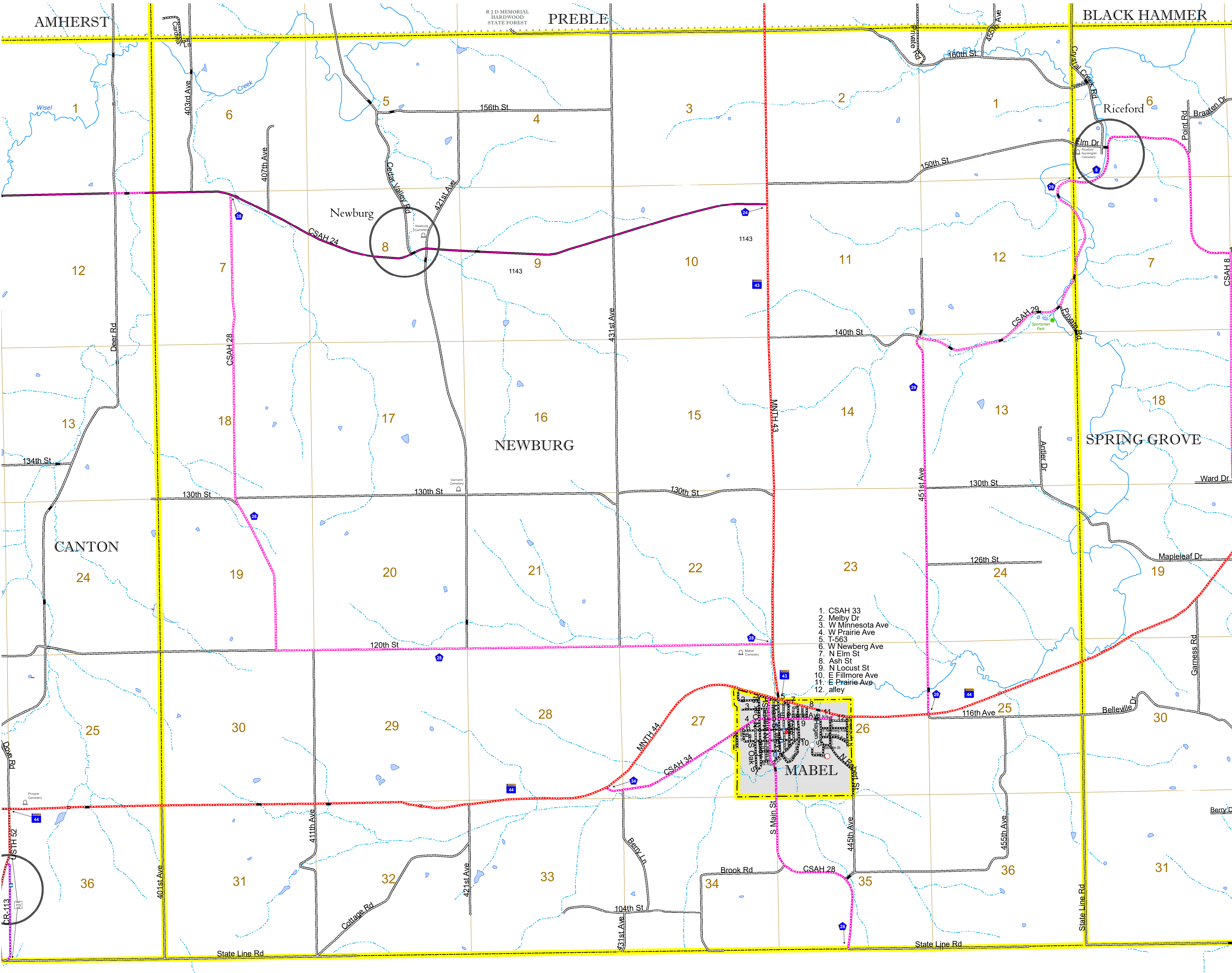

1. CSAH 33
2. Melby Dr
3. W Minnesota Ave
4. W Prairie Ave
5. T-563
6. W Newburg Ave
7. N Elm St
8. Ash St
9. N Locust St
10. E Fillmore Ave
11. E Prairie Ave
12. alley

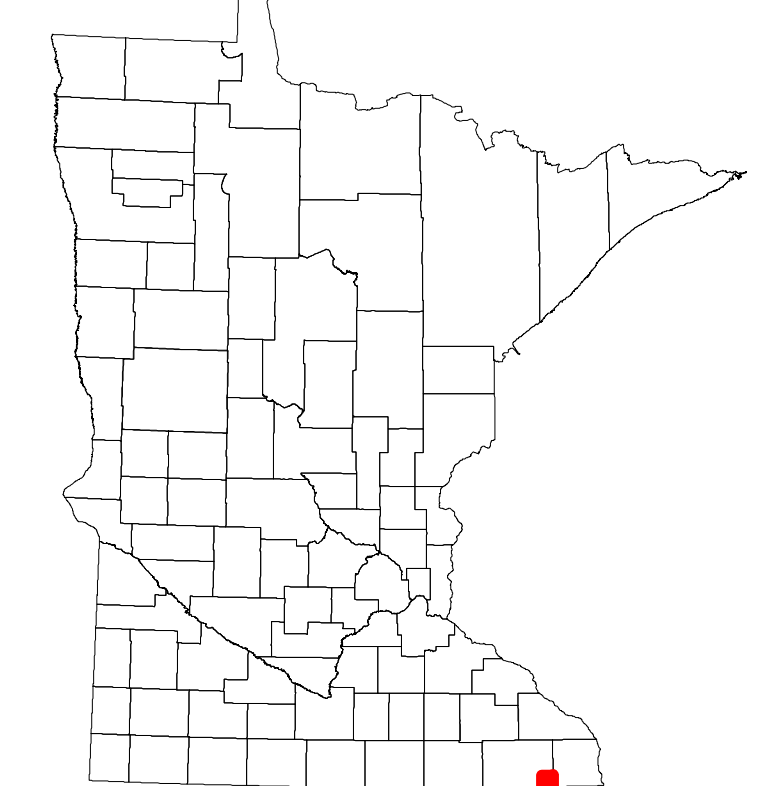

Population (U.S. Census 2010): 379

To request information from this document in an alternative format, call 651-366-4718 or 1-800-657-3774 (Greater Minnesota); 711 or 1-800-627-3529 (Minnesota Relay). You may also send an e-mail to ADRequest.dot@state.mn.us. (Please request at least one week in advance.)