

SPRINGVALE

FISH LAKE

TOWNSHIP OF ISANTI

PREPARED BY THE MINNESOTA DEPARTMENT OF TRANSPORTATION OFFICE OF TRANSPORTATION SYSTEM MANAGEMENT

IN COOPERATION WITH U.S. DEPARTMENT OF TRANSPORTATION FEDERAL HIGHWAY ADMINISTRATION

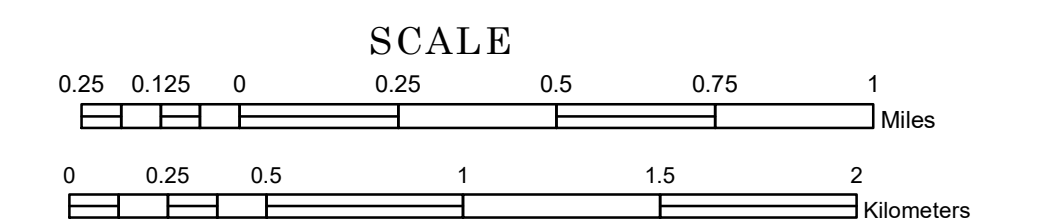

1 in = 1,600 ft

2024

Projection: Transverse Mercator NAD 1986 UTM Zone 15

North American Datum of 1986

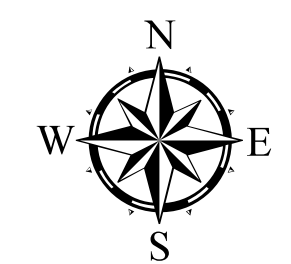

Legend table with categories: ROAD AND ROADWAY FEATURES, RAILROAD AND RAILWAY FEATURES, CITY CENTERS, PUBLIC SERVICE FEATURES, CULTURAL FEATURES, BOUNDARY FEATURES, HYDROLOGIC FEATURES.

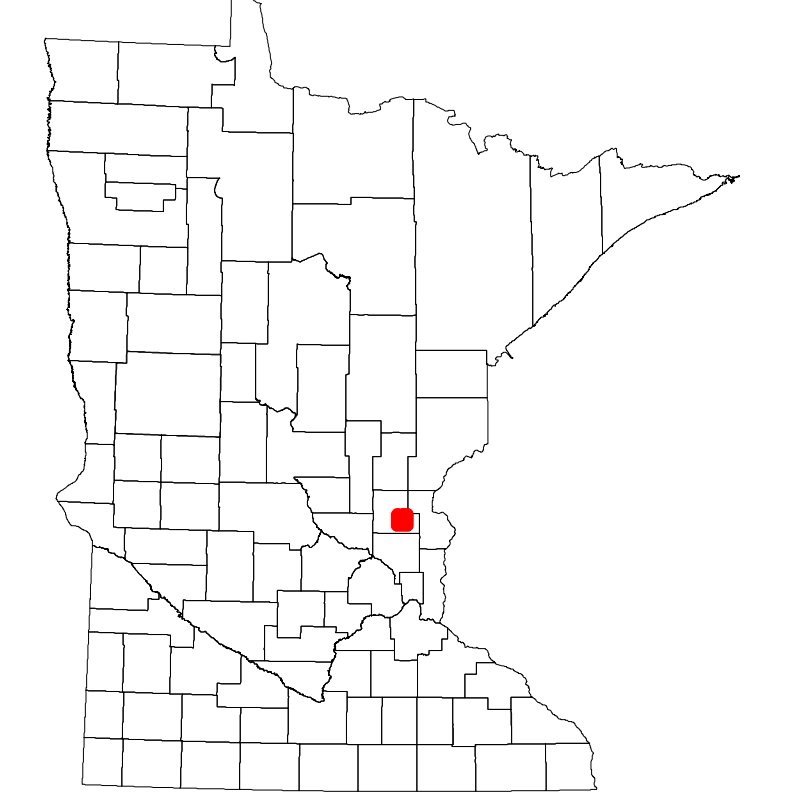

Population (U.S. Census 2010): 2313

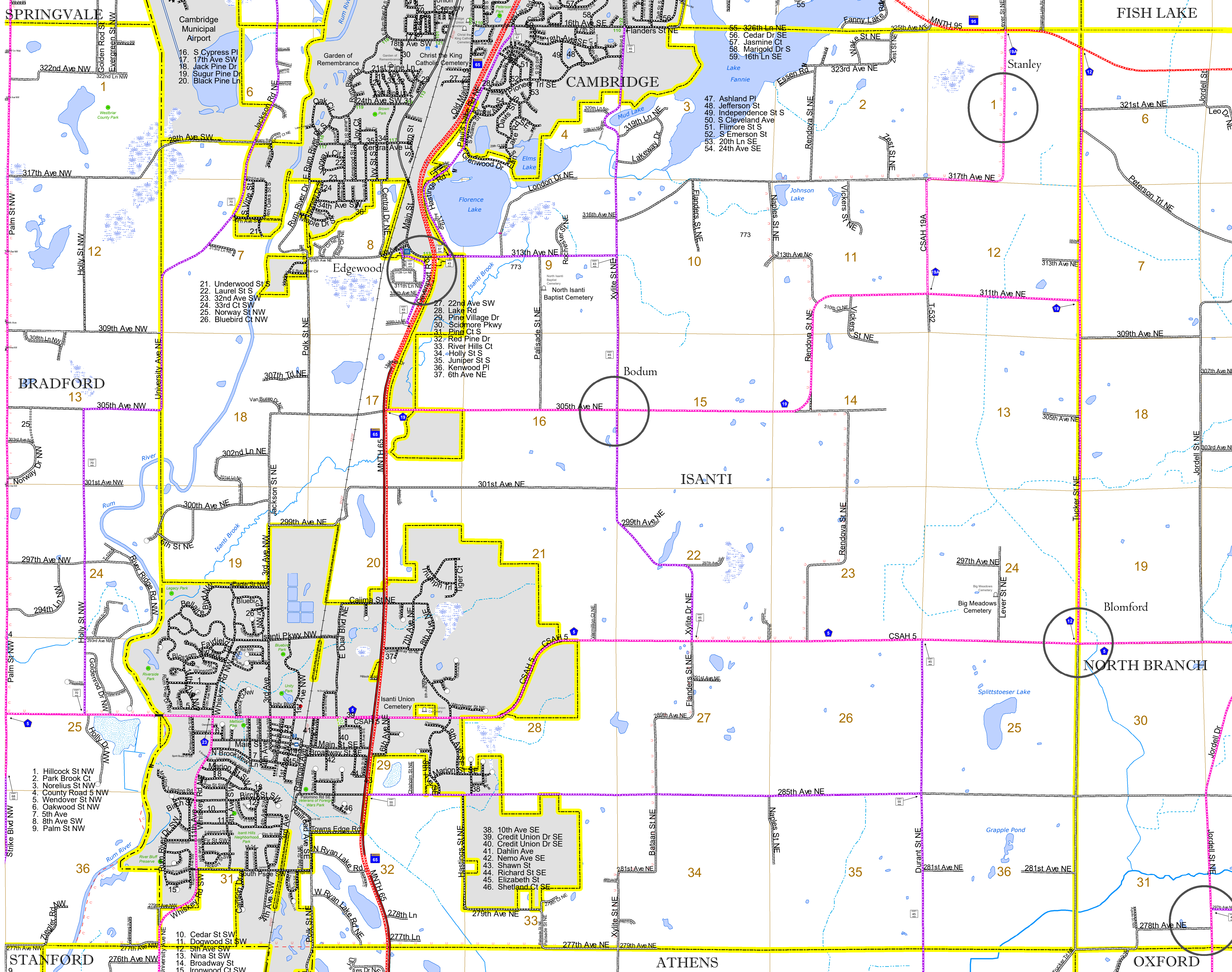

To request information from this document in an alternative format, call 651-366-4718 or 1-800-657-3774 (Greater Minnesota); 711 or 1-800-627-3529 (Minnesota Relay). You may also send an e-mail to ADarequest.dot@state.mn.us. (Please request at least one week in advance.)