

TOWNSHIP OF STANCHFIELD

PREPARED BY THE
MINNESOTA DEPARTMENT OF TRANSPORTATION
OFFICE OF TRANSPORTATION SYSTEM MANAGEMENT

IN COOPERATION WITH
U.S. DEPARTMENT OF TRANSPORTATION
FEDERAL HIGHWAY ADMINISTRATION



1 in = 1,600 ft

2024



Projection:
Transverse Mercator
NAD 1986
UTM Zone 15

North American Datum
of 1986

ROAD AND ROADWAY FEATURES		BOUNDARY FEATURES	
INTERSTATE		CONCRETE	
US HIGHWAY		BITUMINOUS	
MN HIGHWAY		GRAVEL	
COUNTY STATE AID HIGHWAY		DIRT/UNIMPROVED	
COUNTY ROAD		OTHER	
TOWNSHIP ROAD		UNKNOWN	
UNORGANIZED TERRITORY ROAD		RAMP OR CONNECTOR	
OTHER ROADS		INTERSTATE EXIT	
Municipal		GENERAL AIRPORT	
Private		AIRSTRIP	
National Monument		SEAPLANE	
National Park		AIRPORT RUNWAY	
National Wildlife		STATE OF MINNESOTA	
State Park		COUNTY	
Preserve		MUNICIPALITY	
RAILROAD AND RAILWAY FEATURES		AVIATION FEATURES	
EMPIRE BUILDER STATION (AMTRAK)		COMMERCIAL AIRPORT	
NORTHSTAR STATION (COMMUTER)		GENERAL AIRPORT	
LIGHT RAIL		AIRSTRIP	
BLUE LINE		SEAPLANE	
GREEN LINE		AIRPORT RUNWAY	
INFRASTRUCTURE FEATURES		BOUNDARY FEATURES	
LONG BRIDGE (200' OR GREATER SPAN)		TRIBAL LAND	
MAJOR BRIDGE (20' TO 200' SPAN)		STATE OF MINNESOTA	
MINOR BRIDGE (5' TO 20' SPAN)		COUNTY	
DAM		MUNICIPALITY	
LOCK-AND DAM		UNORGANIZED TERRITORY	
CITY CENTERS		FEDERAL ADJUSTED URBAN AREA (2014)	
STATE CAPITAL		CIVIL TOWNSHIP	
COUNTY SEAT		CONGRESSIONAL TOWNSHIP	
CITY CENTER		UNINCORPORATED COMMUNITY	
PUBLIC SERVICE FEATURES		MILITARY	
MNDOT OFFICE		VOYAGEURS NATIONAL PARK	
MNDOT TRUCK STATION		BOUNDARY WATERS CANOE AREA WILDERNESS	
HIGHWAY PATROL DISTRICT OFFICE		STATE PARK	
STATE TRAVEL INFORMATION CENTER		REGIONAL PARK	
REST AREA (FULL SERVICE)		NATIONAL FOREST	
REST AREA (VAULT TOILET)		NATIONAL AND STATE FOREST	
WAYSIDE (VAULT OR PVI TOILET)		STATE FOREST	
PARK AND RIDE LOT		NATIONAL TRAIL	
PORT OF ENTRY		WILDLIFE REFUGUE AREA	
PUBLIC ACCESS POINT		WILDLIFE MANAGEMENT AREA	
MN STATE COLLEGE AND UNIVERSITY SYSTEM (MNSCU)		HYDROLOGIC FEATURES	
UNIVERSITY OF MN SYSTEM		RIVER OR STREAM (PERMANENT)	
FARMGROUNDS		LAKE, POND OR RESERVOIR	
CULTURAL FEATURES		STREAM (INTERMITTENT)	
STATE HISTORICAL MARKER		DRAINAGE DITCH	
HISTORIC DISTRICT		WETLAND	
HISTORIC SITE		ISLAND OR LAND	
MONUMENT		REGIONAL WATERSHED	

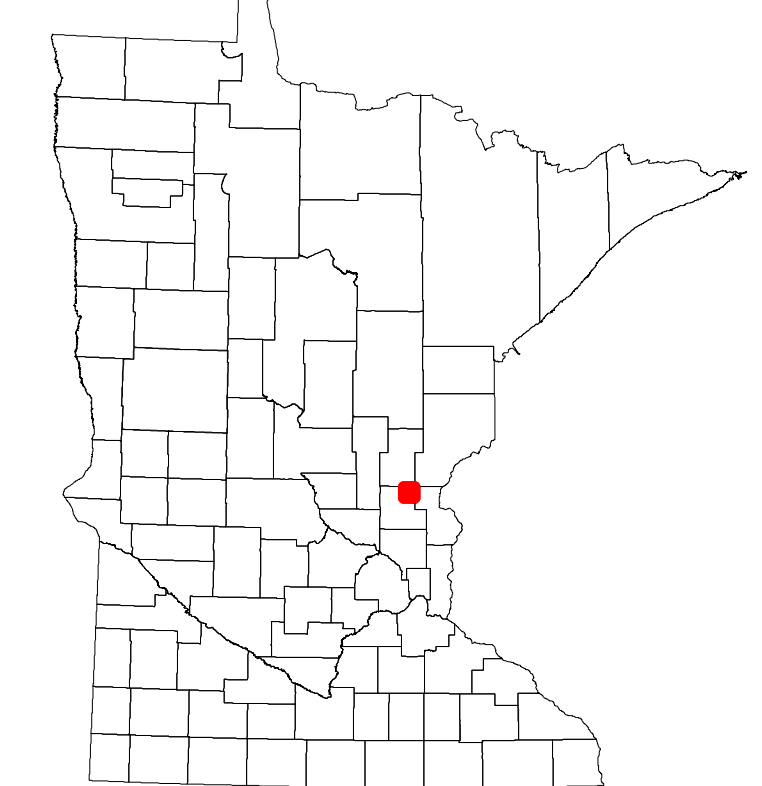

Population (U.S. Census 2010): 1209

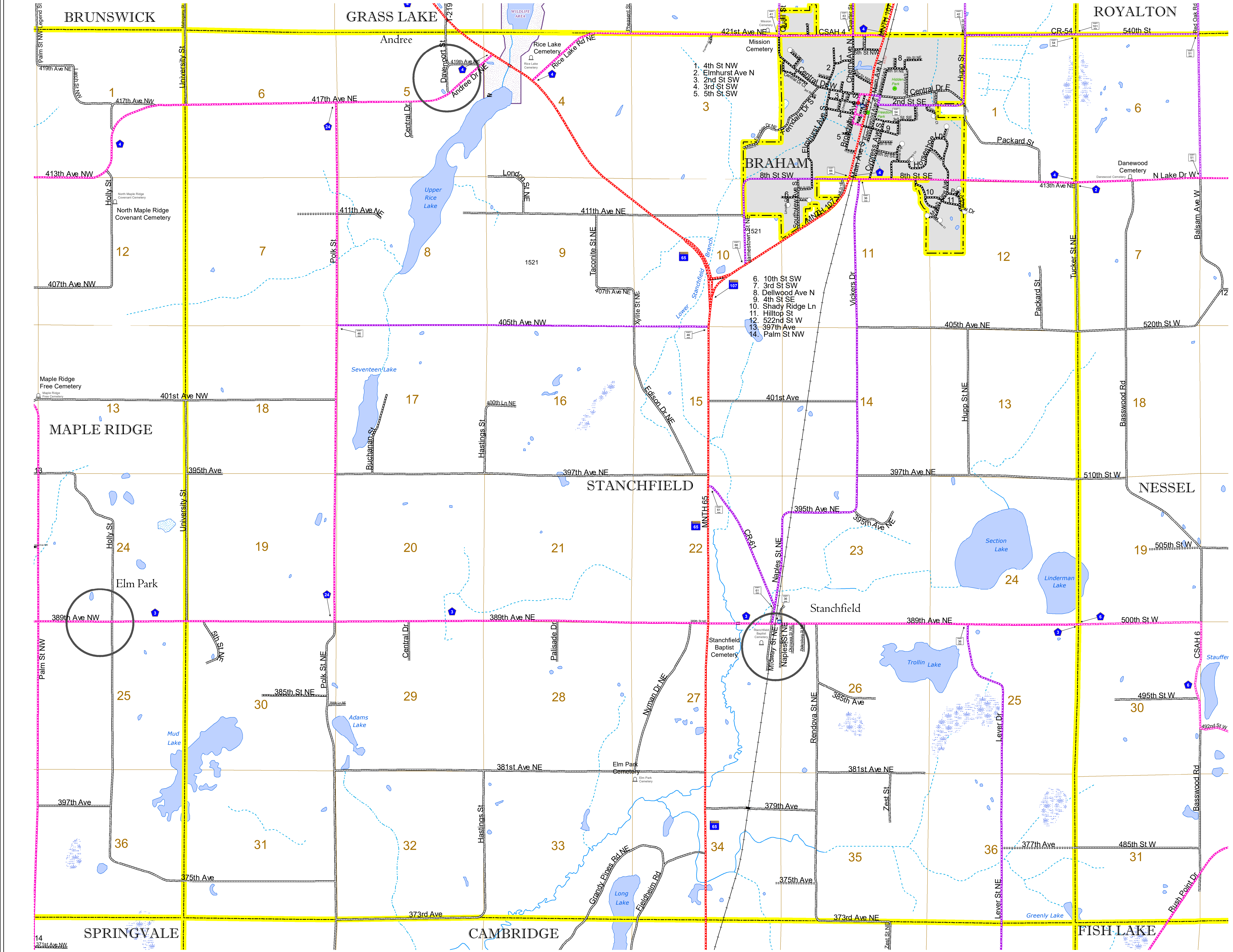

To request information from this document in an alternative format, call 651-366-4718 or 1-800-657-3774 (Greater Minnesota); 711 or 1-800-627-3529 (Minnesota Relay). You may also send an e-mail to ADRequest.dot@state.mn.us. (Please request at least one week in advance.)