

TOWNSHIP OF BOXVILLE

PREPARED BY THE
MINNESOTA DEPARTMENT OF TRANSPORTATION
OFFICE OF TRANSPORTATION SYSTEM MANAGEMENT

IN COOPERATION WITH
U.S. DEPARTMENT OF TRANSPORTATION
FEDERAL HIGHWAY ADMINISTRATION

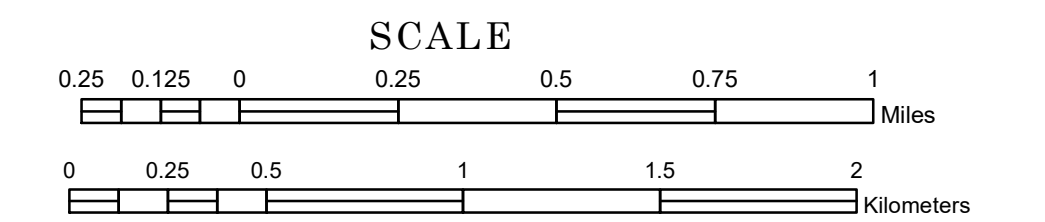

1 in = 1,600 ft

2023

Projection:
Transverse Mercator
NAD 1986
UTM Zone 15

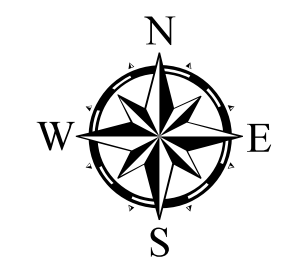

North American Datum
of 1986

ROAD AND ROADWAY FEATURES		RAILROAD AND RAILWAY FEATURES		AVIATION FEATURES		BOUNDARY FEATURES	
INTERSTATE	CONCRETE	EMPIRE BUILDER STATION (AMTRAK)	COMMERCIAL AIRPORT	TRIBAL LAND	STATE OF MINNESOTA	STATE CAPITAL	SECTION
US HIGHWAY	BITUMINOUS	NORTHSTAR STATION (COMMUTER)	GENERAL AIRPORT	STATE OF MINNESOTA	COUNTY	COUNTY SEAT	MILITARY
MN HIGHWAY	GRAVEL		AIRSTRIP	COUNTY	MUNICIPALITY	CITY CENTER	VOYAGEURS NATIONAL PARK
COUNTY STATE AID HIGHWAY	DIRT/UNIMPROVED		SEAPLANE	MUNICIPALITY	UNINCORPORATED TOWNSHIP	UNINCORPORATED COMMUNITY	BOUNDARY WATERS CANOE AREA WILDERNESS
COUNTY ROAD	OTHER		AIRPORT RUNWAY	UNINCORPORATED TOWNSHIP	CIVIL TOWNSHIP		STATE PARK
TOWNSHIP ROAD	UNKNOWN			CIVIL TOWNSHIP	CONGRESSIONAL TOWNSHIP		REGIONAL PARK
UNORGANIZED TERRITORY ROAD				CONGRESSIONAL TOWNSHIP			NATIONAL FOREST
OTHER ROADS							NATIONAL AND STATE FOREST
Municipal	RAMP OR CONNECTOR						STATE FOREST
Private	INTERSTATE EXIT						NATIONAL TRAIL
National Monument	GREAT RIVER ROAD						WILDLIFE REFUGUE AREA
State Game							WILDLIFE MANAGEMENT AREA
National Forest							HYDROLOGIC FEATURES
State Park							RIVER OR STREAM (PERMANENT)
Preserve							LAKE, POND OR RESERVOIR
							STREAM (INTERMITTENT)
							DRAINAGE DITCH
							WETLAND
							ISLAND OR LAND
							REGIONAL WATERSHED

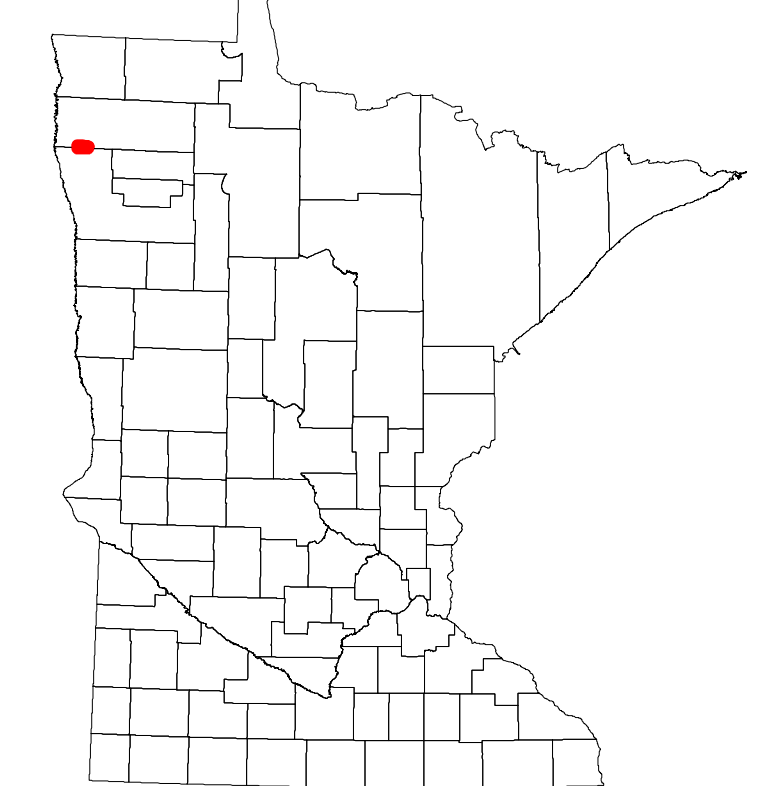

Population (U.S. Census 2010): 39

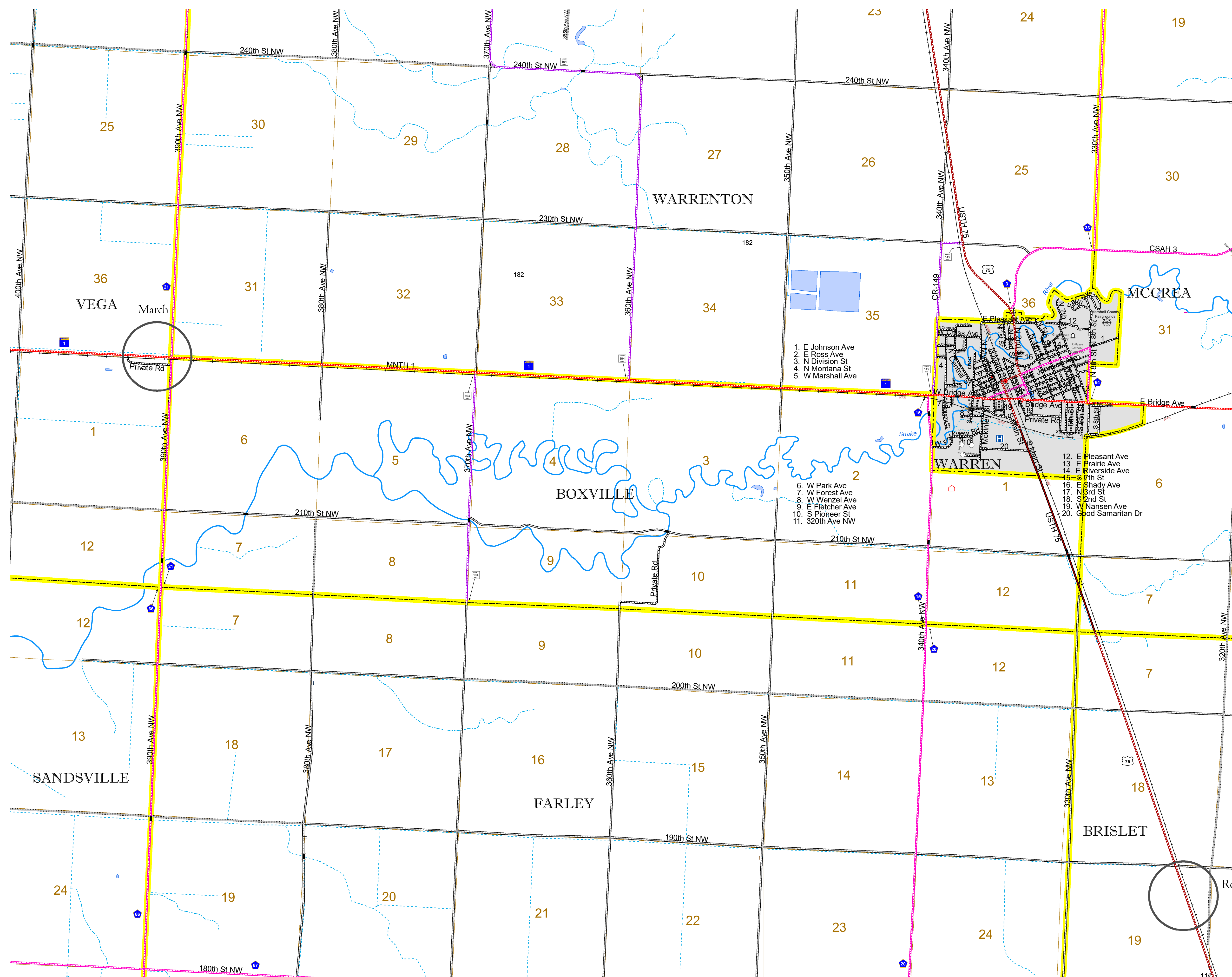

1. E Johnson Ave
2. E Ross Ave
3. N Division St
4. N Montana St
5. W Marshall Ave

6. W Park Ave
7. W Forest Ave
8. W Wenzel Ave
9. E Fletcher Ave
10. S Pioneer St
11. 320th Ave NW

12. E Pleasant Ave
13. E Prairie Ave
14. E Riverside Ave
15. S 7th St
16. E Shady Ave
17. N 3rd St
18. S 2nd St
19. W Nansen Ave
20. Good Samaritan Dr

To request information from this document in an alternative format, call 651-366-4718 or 1-800-657-3774 (Greater Minnesota); 711 or 1-800-627-3529 (Minnesota Relay). You may also send an e-mail to ADarequest.dot@state.mn.us. (Please request at least one week in advance.)