

# TOWNSHIP OF SEWARD

PREPARED BY THE  
MINNESOTA DEPARTMENT OF TRANSPORTATION  
OFFICE OF TRANSPORTATION SYSTEM MANAGEMENT

IN COOPERATION WITH  
U.S. DEPARTMENT OF TRANSPORTATION  
FEDERAL HIGHWAY ADMINISTRATION

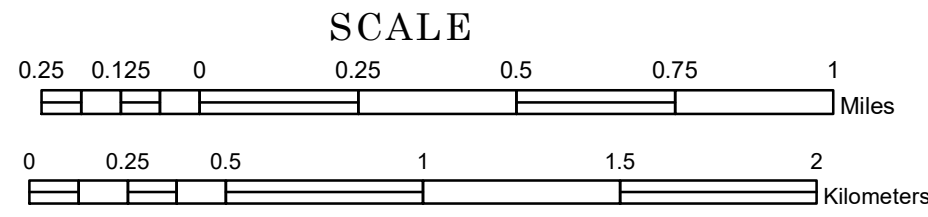

1 in = 1,600 ft  
**2023**

Projection:  
Transverse Mercator  
NAD 1986  
UTM Zone 15

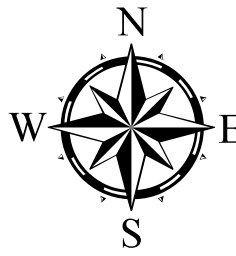

North American Datum  
of 1986

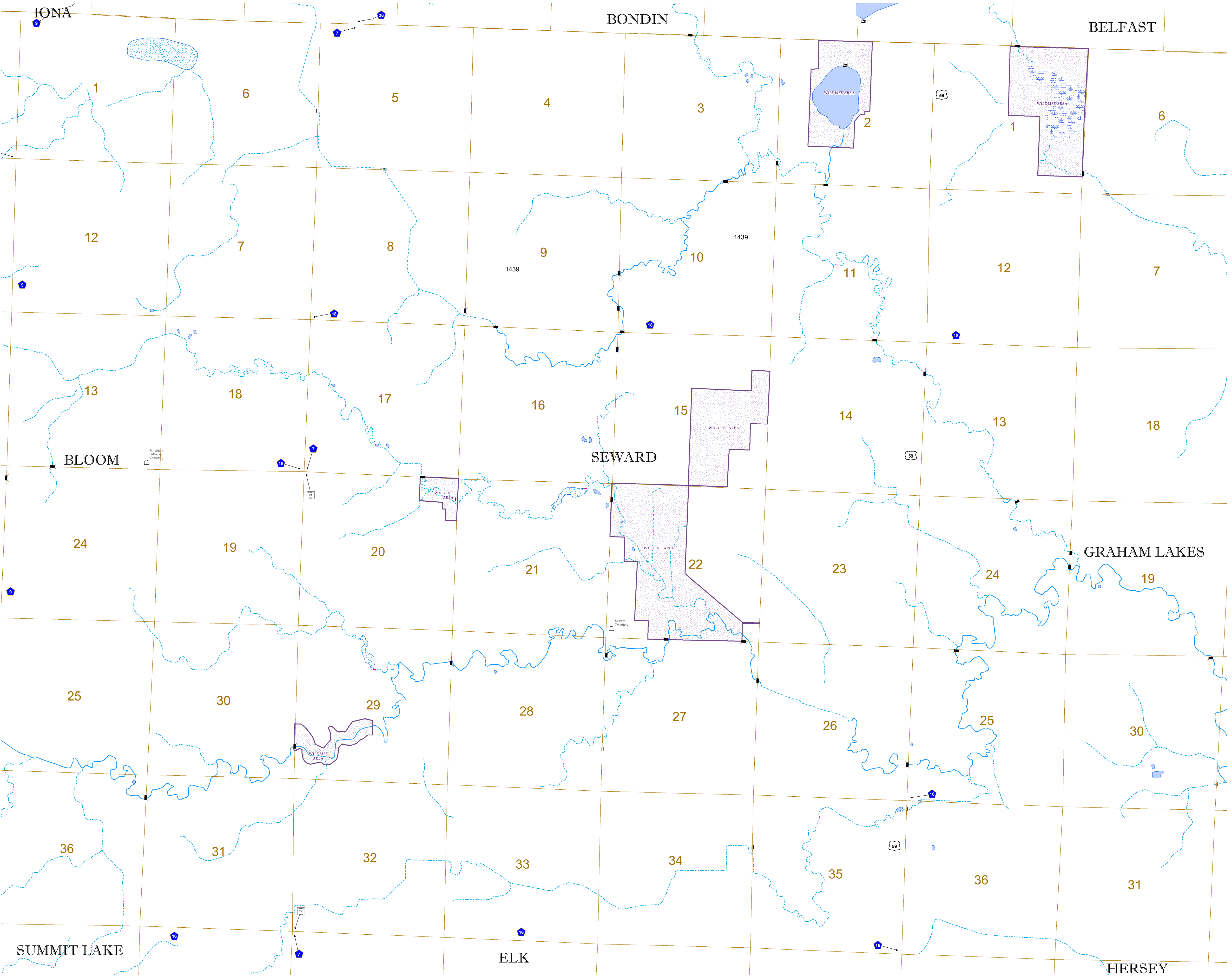

ROAD AND ROADWAY FEATURES		AVIATION FEATURES	
INTERSTATE	CONCRETE	COMMERCIAL AIRPORT	GENERAL AIRPORT
US HIGHWAY	BITUMINOUS	NORTHSTAR STATION (COMMUTER)	AIRSTRIP
MN HIGHWAY	GRAVEL	SEAPLANE	AIRPORT RUNWAY
COUNTY STATE AID HIGHWAY	DIRT/UNIMPROVED	RAILROAD AND RAILWAY FEATURES	BOUNDARY FEATURES
COUNTY ROAD	OTHER	EMPIRE BUILDER STATION (AMTRAK)	TRIBAL LAND
TOWNSHIP ROAD	UNKNOWN	LIGHT RAIL	STATE OF MINNESOTA
UNORGANIZED TERRITORY ROAD		BLUE LINE	COUNTY
OTHER ROADS		GREEN LINE	MUNICIPALITY
MUNICIPAL		INFRASTRUCTURE FEATURES	UNORGANIZED TERRITORY
PRIVATE		LONG BRIDGE (200' OR GREATER SPAN)	FEDERAL ADJUSTED URBAN AREA (2014)
NATIONAL MONUMENT		MAJOR BRIDGE (20' TO 300' SPAN)	CIVIL TOWNSHIP
NATIONAL WILDLIFE REFUGES		MINOR BRIDGE (5' TO 20' SPAN)	CONGRESSIONAL TOWNSHIP
STATE PARK		DAM	SECTION
PRESERVE		LOCK-AND-DAM	MILITARY
		CITY CENTERS	VOYAGEURS NATIONAL PARK
		STATE CAPITAL	BOUNDARY WATERS CANOE AREA WILDERNESS
		COUNTY SEAT	STATE PARK
		CITY CENTER	REGIONAL PARK
		UNINCORPORATED COMMUNITY	NATIONAL FOREST
			NATIONAL AND STATE FOREST
			STATE FOREST
			NATIONAL TRAIL
			WILDLIFE REFUGES AREA
			WILDLIFE MANAGEMENT AREA
			HYDROLOGIC FEATURES
			RIVER OR STREAM (PERENNIAL)
			LAKE, POND OR RESERVOIR
			CULTURAL FEATURES
			STREAM (INTERMITTENT)
			DRAINAGE DITCH
			WETLAND
			ISLAND OR LAND MONUMENT
			REGIONAL WATERSHED

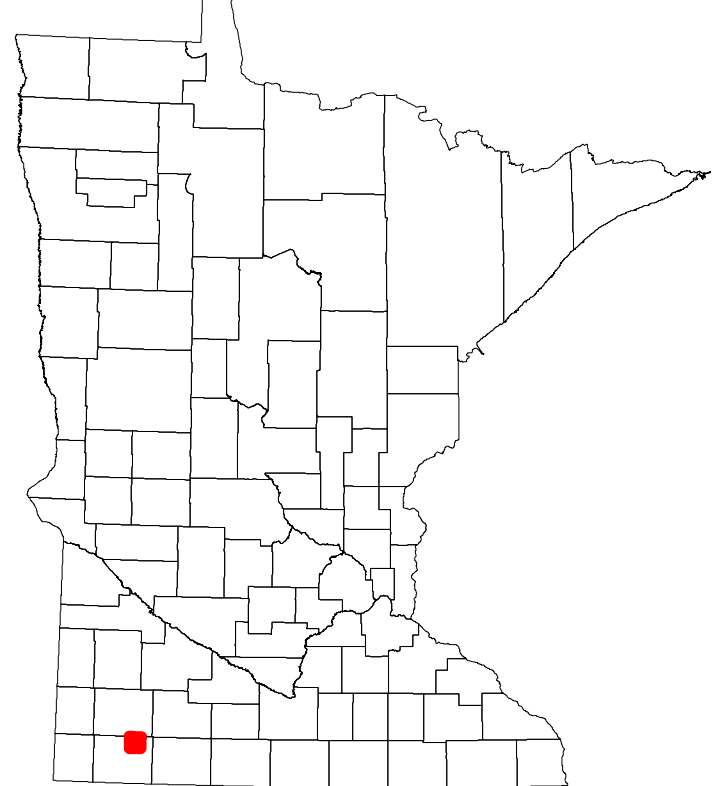

Population (U.S. Census 2010): 208

To request information from this document in an alternative format, call 651-366-4718 or 1-800-657-3774 (Greater Minnesota); 711 or 1-800-627-3529 (Minnesota Relay). You may also send an e-mail to ADAREquest.dot@state.mn.us. (Please request at least one week in advance.)