

TOWNSHIP OF WOODSIDE

PREPARED BY THE
MINNESOTA DEPARTMENT OF TRANSPORTATION
OFFICE OF TRANSPORTATION SYSTEM MANAGEMENT

IN COOPERATION WITH
U.S. DEPARTMENT OF TRANSPORTATION
FEDERAL HIGHWAY ADMINISTRATION

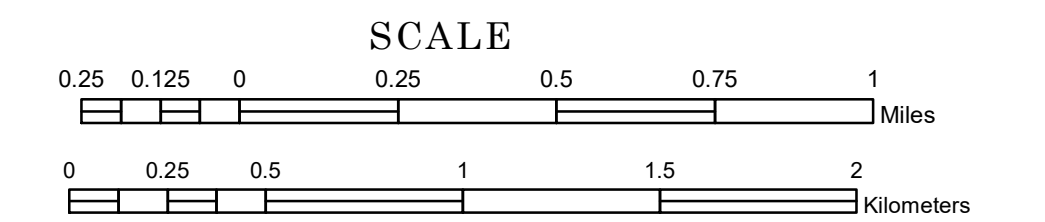

2024

Projection:
Transverse Mercator
NAD 1986
UTM Zone 15

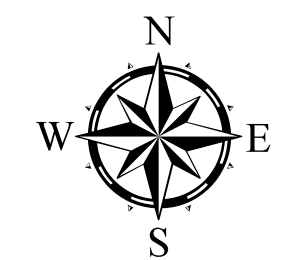

North American Datum
of 1986

| ROAD AND ROADWAY FEATURES | | AVIATION FEATURES | |
|---------------------------------|-------------------------------|------------------------------|---------------------------------------|
| INTERSTATE | CONCRETE | COMMERCIAL AIRPORT | GENERAL AIRPORT |
| US HIGHWAY | BITUMINOUS | NORTHSTAR STATION (COMMUTER) | AIRSTRIP |
| MN HIGHWAY | GRAVEL | SEAPLANE | SEAPLANE |
| COUNTY STATE AID HIGHWAY | DIRT/UNIMPROVED | AIRPORT RUNWAY | AIRPORT RUNWAY |
| COUNTY ROAD | OTHER | BOUNDARY FEATURES | BOUNDARY FEATURES |
| TOWNSHIP ROAD | UNKNOWN | TRIBAL LAND | STATE OF MINNESOTA |
| UNORGANIZED TERRITORY ROAD | UNKNOWN | COUNTY | MUNICIPALITY |
| OTHER ROADS | RAMP OR CONNECTOR | UNORGANIZED TERRITORY | FEDERAL ADJUSTED URBAN AREA (2014) |
| Municipal | INTERSTATE EXIT | CITY TOWNSHIP | CONGRESSIONAL TOWNSHIP |
| Private | INTERSTATE EXIT | SECTION | MILITARY |
| National Monument | INTERSTATE EXIT | VOYAGEURS NATIONAL PARK | BOUNDARY WATERS GANOE AREA WILDERNESS |
| National Wildlife | INTERSTATE EXIT | STATE PARK | STATE PARK |
| State Park | INTERSTATE EXIT | NATIONAL FOREST | NATIONAL FOREST |
| Present | INTERSTATE EXIT | NATIONAL AND STATE FOREST | NATIONAL AND STATE FOREST |
| RAILROAD AND RAILWAY FEATURES | RAILROAD AND RAILWAY FEATURES | STATE FOREST | NATIONAL TRAIL |
| EMPIRE BUILDER STATION (AMTRAK) | RAILROAD AND RAILWAY FEATURES | WILDLIFE REFUGUE AREA | WILDLIFE REFUGUE AREA |
| EMPIRE BUILDER STATION (AMTRAK) | RAILROAD AND RAILWAY FEATURES | WILDLIFE MANAGEMENT AREA | WILDLIFE MANAGEMENT AREA |
| EMPIRE BUILDER STATION (AMTRAK) | RAILROAD AND RAILWAY FEATURES | HYDROLOGIC FEATURES | HYDROLOGIC FEATURES |
| EMPIRE BUILDER STATION (AMTRAK) | RAILROAD AND RAILWAY FEATURES | RIVER OR STREAM (PERENNIAL) | RIVER OR STREAM (PERENNIAL) |
| EMPIRE BUILDER STATION (AMTRAK) | RAILROAD AND RAILWAY FEATURES | LAKE, POND OR RESERVOIR | LAKE, POND OR RESERVOIR |
| EMPIRE BUILDER STATION (AMTRAK) | RAILROAD AND RAILWAY FEATURES | STREAM (INTERMITTENT) | STREAM (INTERMITTENT) |
| EMPIRE BUILDER STATION (AMTRAK) | RAILROAD AND RAILWAY FEATURES | DRAINAGE DITCH | DRAINAGE DITCH |
| EMPIRE BUILDER STATION (AMTRAK) | RAILROAD AND RAILWAY FEATURES | WETLAND | WETLAND |
| EMPIRE BUILDER STATION (AMTRAK) | RAILROAD AND RAILWAY FEATURES | ISLAND OR LAND | ISLAND OR LAND |
| EMPIRE BUILDER STATION (AMTRAK) | RAILROAD AND RAILWAY FEATURES | REGIONAL WATERSHED | REGIONAL WATERSHED |
| EMPIRE BUILDER STATION (AMTRAK) | RAILROAD AND RAILWAY FEATURES | | |

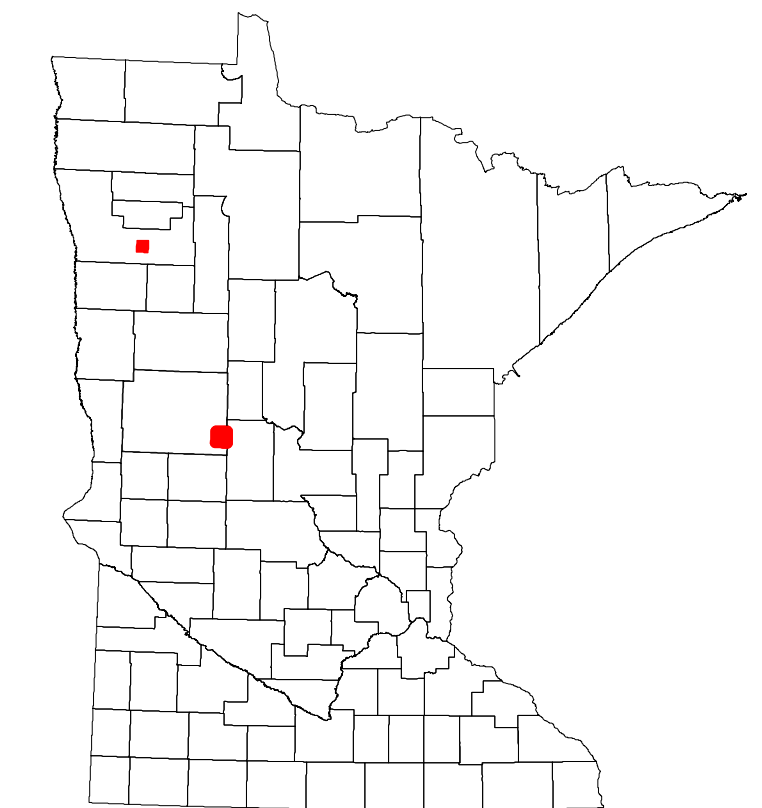

Population (U.S. Census 2010): 277

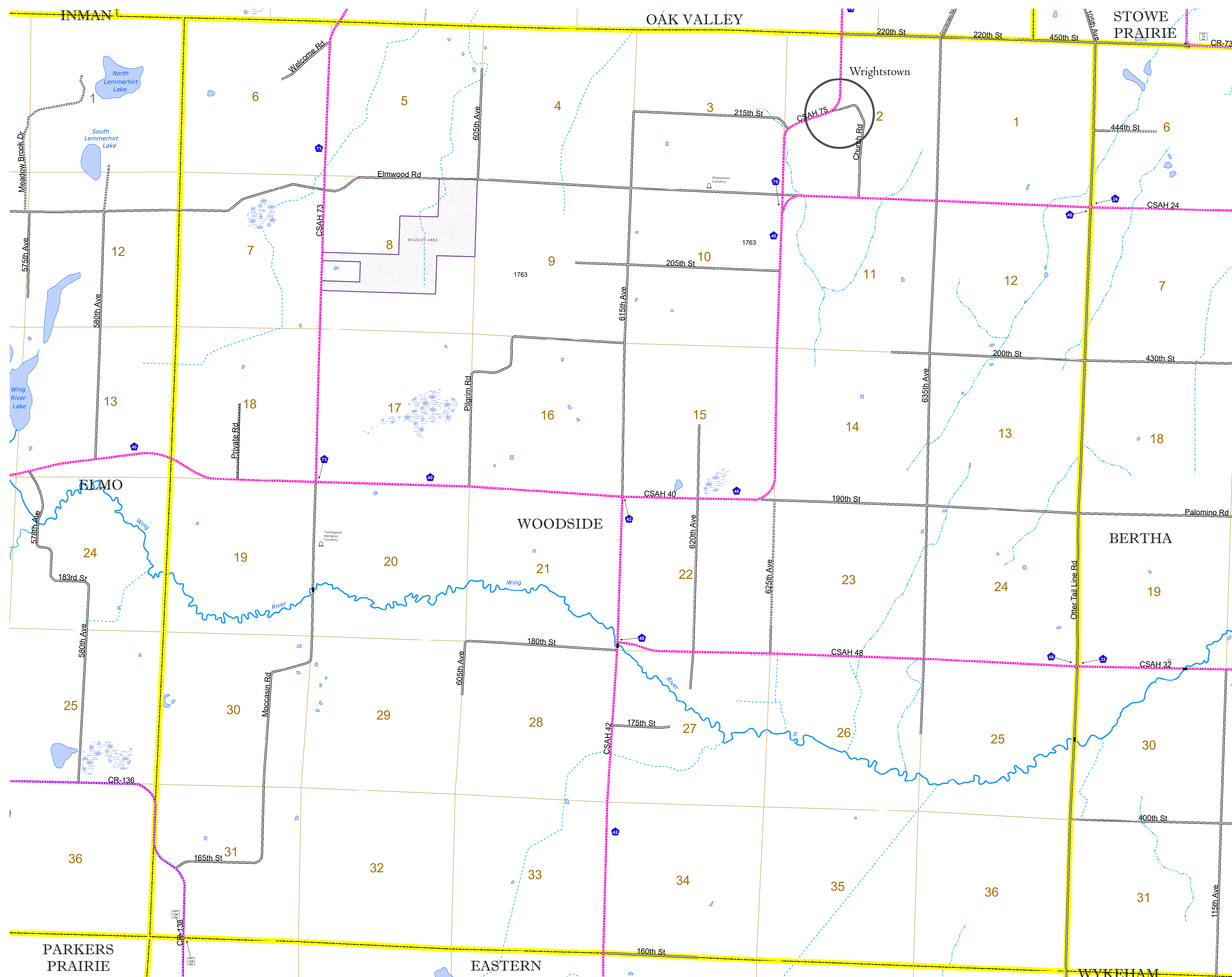

To request information from this document in an alternative format, call 651-366-4718 or 1-800-657-3774 (Greater Minnesota); 711 or 1-800-627-3529 (Minnesota Relay). You may also send an e-mail to ADArequest.dot@state.mn.us. (Please request at least one week in advance.)