

TOWNSHIP OF BREMEN

PREPARED BY THE
MINNESOTA DEPARTMENT OF TRANSPORTATION
OFFICE OF TRANSPORTATION SYSTEM MANAGEMENT

IN COOPERATION WITH
U.S. DEPARTMENT OF TRANSPORTATION
FEDERAL HIGHWAY ADMINISTRATION



2023

Projection:
Transverse Mercator
NAD 1986
UTM Zone 15



North American Datum
of 1986

ROAD AND ROADWAY FEATURES		BOUNDARY FEATURES	
INTERSTATE	CONCRETE	TRIBAL LAND	STATE OF MINNESOTA
US HIGHWAY	BITUMINOUS	COUNTY	MUNICIPALITY
MN HIGHWAY	GRAVEL	UNINCORPORATED TOWNSHIP	SECTION
COUNTY STATE AID HIGHWAY	DIRT/UNIMPROVED	MILITARY	VOYAGEURS NATIONAL PARK
COUNTY ROAD	OTHER	BOUNDRY WATERS CANOE AREA WILDERNESS	REGIONAL PARK
TOWNSHIP ROAD	UNKNOWN	NATIONAL FOREST	STATE PARK
UNORGANIZED TERRITORY ROAD		NATIONAL AND STATE FOREST	NATIONAL FOREST
OTHER ROADS		STATE FOREST	NATIONAL TRAIL
Municipal Private National Monument State Forest		WILDLIFE REFUGUE AREA	WILDLIFE MANAGEMENT AREA
Nature Service National Park National Wildlife State Game		WILDLIFE REFUGUE AREA	WILDLIFE MANAGEMENT AREA
Museum National Forest State Park Preserve		HYDROLOGIC FEATURES	
RAILROAD AND RAILWAY FEATURES		HYDROLOGIC FEATURES	
EMPIRE BUILDER STATION (AMTRAK)	COMMERCIAL AIRPORT	LAKE, POND OR RESERVOIR	STREAM (INTERMITTENT)
NORTHSTAR STATION (COMMUTER)	GENERAL AIRPORT	DRAINAGE DITCH	WETLAND
LIGHT RAIL	AIRSTRIP	HISTORIC DISTRICT	HISTORIC SITE
BLUE LINE	SEAPLANE	HISTORIC SITE	MONUMENT
GREEN LINE	AIRPORT RUNWAY		
INFRASTRUCTURE FEATURES		CITY CENTERS	
LONG BRIDGE (200' OR GREATER SPAN)	TRIAL LAND	STATE CAPITAL	COUNTY SEAT
MAJOR BRIDGE (20' TO 200' SPAN)	STATE OF MINNESOTA	CITY CENTER	UNINCORPORATED COMMUNITY
MINOR BRIDGE (5' TO 20' SPAN)	COUNTY		
DAM	MUNICIPALITY		
LOCK AND DAM	UNINCORPORATED TOWNSHIP		
	CIVIL TOWNSHIP		
	CONGRESSIONAL TOWNSHIP		
	SECTION		
	MILITARY		
	VOYAGEURS NATIONAL PARK		
	BOUNDRY WATERS CANOE AREA WILDERNESS		
	REGIONAL PARK		
	STATE PARK		
	NATIONAL FOREST		
	NATIONAL AND STATE FOREST		
	STATE FOREST		
	NATIONAL TRAIL		
	WILDLIFE REFUGUE AREA		
	WILDLIFE MANAGEMENT AREA		
	HYDROLOGIC FEATURES		
	LAKE, POND OR RESERVOIR		
	STREAM (INTERMITTENT)		
	DRAINAGE DITCH		
	WETLAND		
	HISTORIC DISTRICT		
	HISTORIC SITE		
	MONUMENT		
	ISLAND OR LAND		
	REGIONAL WATERSHED		

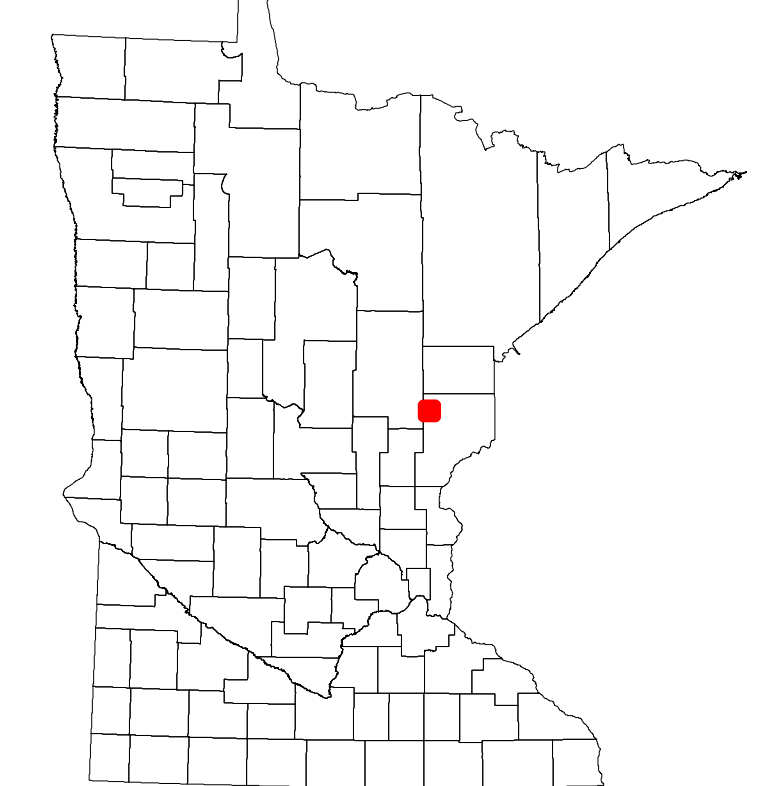

Population (U.S. Census 2010): 240

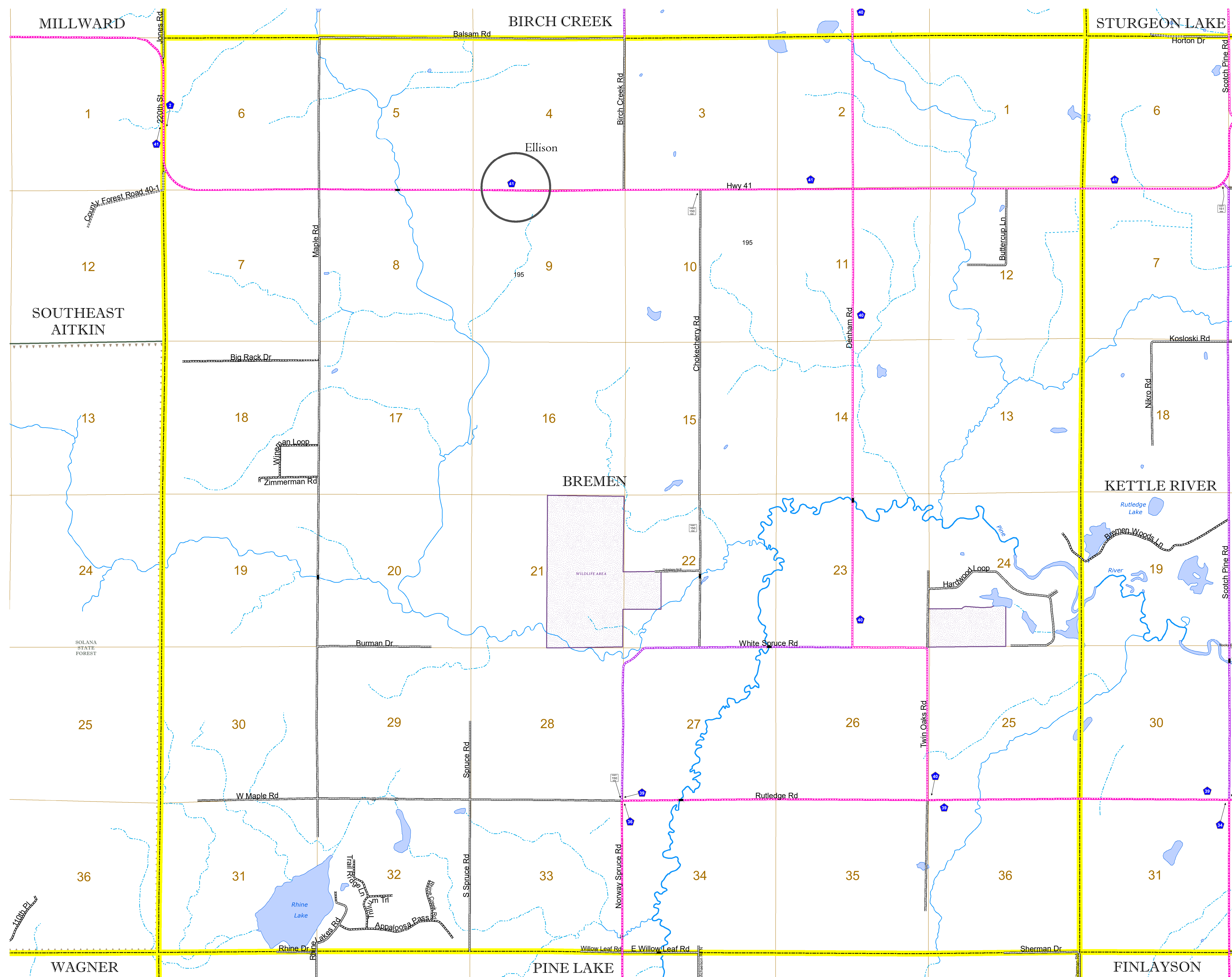

To request information from this document in an alternative format, call 651-366-4718 or 1-800-657-3774 (Greater Minnesota); 711 or 1-800-627-3529 (Minnesota Relay). You may also send an e-mail to ADArequest.dot@state.mn.us. (Please request at least one week in advance.)