

TOWNSHIP OF MISSION CREEK

PREPARED BY THE
MINNESOTA DEPARTMENT OF TRANSPORTATION
OFFICE OF TRANSPORTATION SYSTEM MANAGEMENT

IN COOPERATION WITH
U.S. DEPARTMENT OF TRANSPORTATION
FEDERAL HIGHWAY ADMINISTRATION

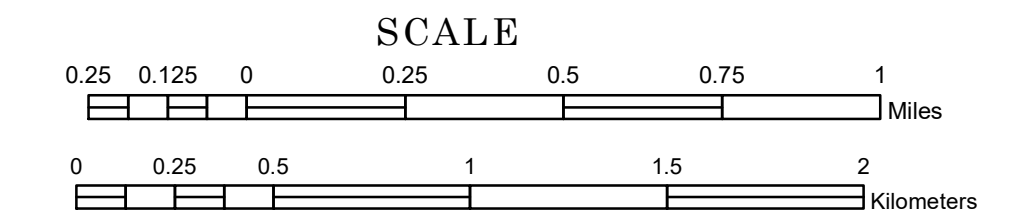

1 in = 1,600 ft

2023

Projection:
Transverse Mercator
NAD 1986
UTM Zone 15

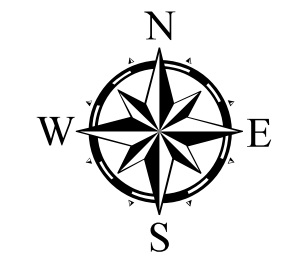

ROAD AND ROADWAY FEATURES		AVIATION FEATURES	
INTERSTATE	CONCRETE	COMMERCIAL AIRPORT	GENERAL AIRPORT
US HIGHWAY	BITUMINOUS	AIRSTRIP	
MN HIGHWAY	GRAVEL	SEAPLANE	AIRPORT RUNWAY
COUNTY STATE AID HIGHWAY	DIRT/UNIMPROVED	BOUNDARY FEATURES	
COUNTY ROAD	OTHER	TRIBAL LAND	STATE OF MINNESOTA
TOWNSHIP ROAD	UNKNOWN	COUNTY	MUNICIPALITY
UNORGANIZED TERRITORY ROAD		UNORGANIZED TERRITORY	FEDERAL ADJUSTED URBAN AREA (2014)
OTHER ROADS		CITY CENTER	CIVIL TOWNSHIP
Municipal	Private	UNINCORPORATED COMMUNITY	CONGRESSIONAL TOWNSHIP
National Monument	State Forest	SECTION	
National Park	State Game Preserve	MILITARY	VOYAGEURS NATIONAL PARK
Military	Preserve	BOUNDARY WATERS WILDERNESS	
RAILROAD AND RAILWAY FEATURES		STATE PARK	
EMPIRE BUILDER STATION (AMTRAK)	COMMERCIAL AVIATION	NATIONAL FOREST	NATIONAL AND STATE FOREST
NORTHSTAR STATION (COMMUTER)	GENERAL AIRPORT	STATE FOREST	WILDLIFE REFUGUE AREA
LIGHT RAIL	AIRSTRIP	REGIONAL PARK	WILDLIFE MANAGEMENT AREA
BLUE LINE	SEAPLANE	NATIONAL FOREST	HYDROLOGIC FEATURES
GREEN LINE	AIRPORT RUNWAY	NATIONAL AND STATE FOREST	RIVER OR STREAM (PERENNIAL)
INFRASTRUCTURE FEATURES		STATE FOREST	LAKE, POND OR RESERVOIR
LONG BRIDGE (200' or Greater Span)	TRIBAL LAND	WILDLIFE REFUGUE AREA	STREAM (INTERMITTENT)
MAJOR BRIDGE (20' to 200' Span)	STATE OF MINNESOTA	WILDLIFE MANAGEMENT AREA	DRAINAGE DITCH
MINOR BRIDGE (5' to 20' Span)	COUNTY	WILDLIFE MANAGEMENT AREA	WETLAND
DAM	MUNICIPALITY	WILDLIFE MANAGEMENT AREA	ISLAND OR LAND MONUMENT
LOCK AND DAM	UNORGANIZED TERRITORY	HYDROLOGIC FEATURES	REGIONAL WATERSHED
CITY CENTERS		UNINCORPORATED COMMUNITY	
STATE CAPITAL	CITY CENTER		
COUNTY SEAT	CITY CENTER		
PUBLIC SERVICE FEATURES			
MNDOT OFFICE			
MNDOT TRUCK STATION			
HIGHWAY PATROL DISTRICT OFFICE			
STATE TRAVEL INFORMATION CENTER			
REST AREA (Full Service)			
REST AREA (Vault Toilet)			
WAYSIDE (Vault or Pit Toilet)			
PARK AND RIDE LOT			
PORT OF ENTRY			
PUBLIC ACCESS POINT			
MN STATE COLLEGE AND UNIVERSITY SYSTEM (MNSCU)			
UNIVERSITY OF MN SYSTEM			
FAIRGROUNDS			
CULTURAL FEATURES			
STATE HISTORICAL MARKER			
HISTORIC DISTRICT			
HISTORIC SITE			
MONUMENT			



Population (U.S. Census 2010): 635

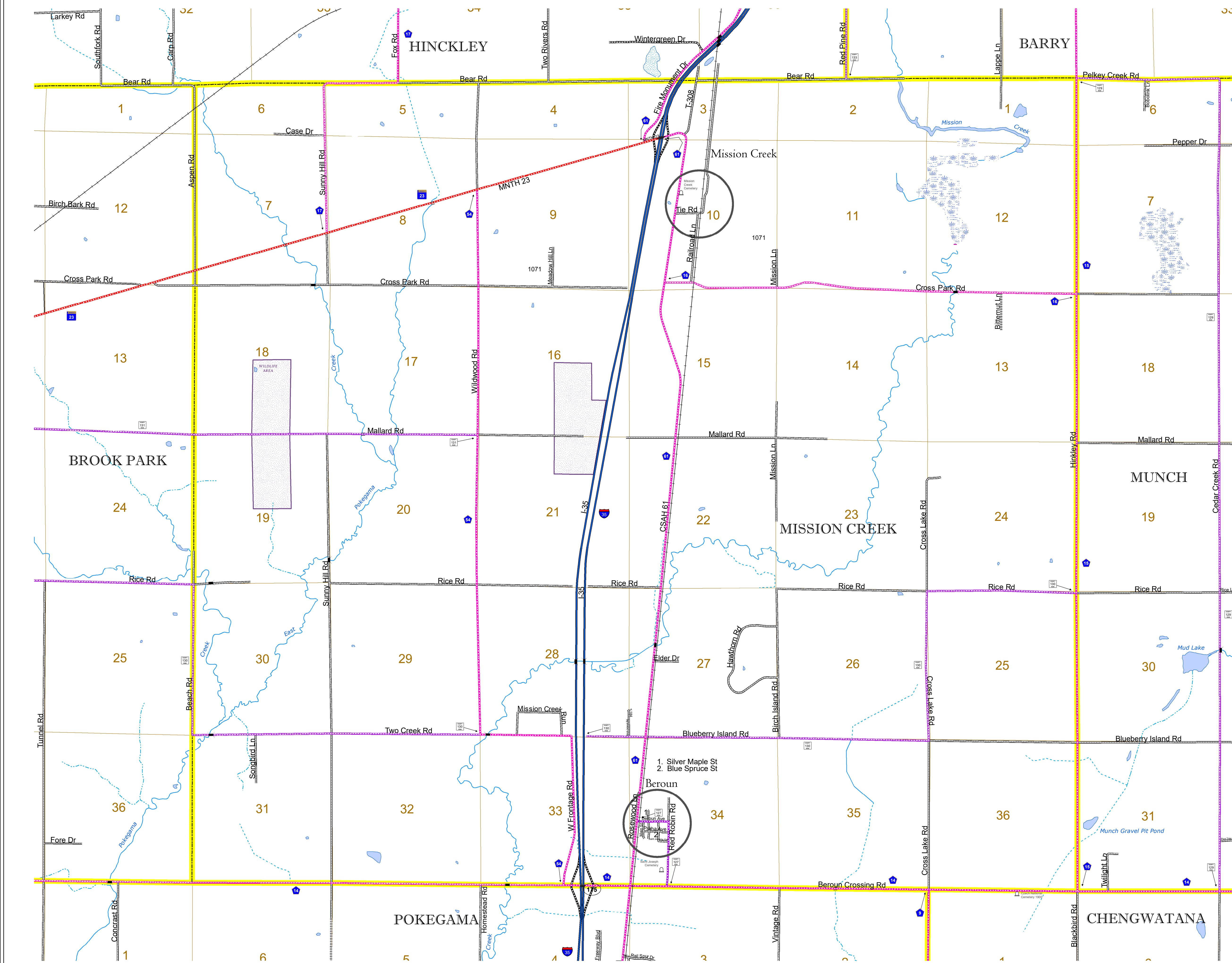

To request information from this document in an alternative format, call 651-366-4718 or 1-800-657-3774 (Greater Minnesota); 711 or 1-800-627-3529 (Minnesota Relay). You may also send an e-mail to ADARquest.dot@state.mn.us. (Please request at least one week in advance.)