

# TOWNSHIP OF HELGELAND

PREPARED BY THE  
MINNESOTA DEPARTMENT OF TRANSPORTATION  
OFFICE OF TRANSPORTATION SYSTEM MANAGEMENT

IN COOPERATION WITH  
U.S. DEPARTMENT OF TRANSPORTATION  
FEDERAL HIGHWAY ADMINISTRATION

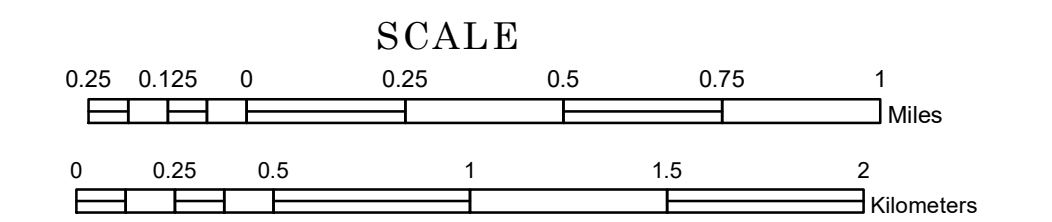

1 in = 1,600 ft

2024

Projection:  
Transverse Mercator  
NAD 1986  
UTM Zone 15



North American Datum  
of 1986

ROAD AND ROADWAY FEATURES		AVIATION FEATURES	
INTERSTATE		CONCRETE	
US HIGHWAY		BITUMINOUS	
MN HIGHWAY		GRAVEL	
COUNTY STATE AID HIGHWAY		DIRT/UNIMPROVED	
COUNTY ROAD		OTHER	
TOWNSHIP ROAD		UNKNOWN	
UNORGANIZED TERRITORY ROAD		RAMP OR CONNECTOR	
OTHER ROADS		INTERSTATE EXIT	
Municipal		GREAT RIVER ROAD	
National Park		COMMERCIAL AIRPORT	
National Monument		GENERAL AIRPORT	
State Forest		AIRSTRIP	
State Game		SEAPLANE	
State Park		AIRPORT RUNWAY	
Preserve		TRIAL LAND	
RAILROAD AND RAILWAY FEATURES		BOUNDARY FEATURES	
EMPIRE BUILDER STATION (AMTRAK)		STATE OF MINNESOTA	
NORTHSTAR STATION (COMPUTER)		COUNTY	
LIGHT RAIL		MUNICIPALITY	
BLUE LINE		UNORGANIZED TERRITORY	
GREEN LINE		FEDERAL ADJUSTED URBAN AREA (2014)	
INFRASTRUCTURE FEATURES		CIVIL TOWNSHIP	
LONG BRIDGE (200' or Greater Span)		CONGRESSIONAL TOWNSHIP	
MAJOR BRIDGE (20' to 200' Span)		SECTION	
MINOR BRIDGE (5' to 20' Span)		MILITARY	
DAM		VOYAGEURS NATIONAL PARK	
LOCK AND DAM		BOUNDARY WATERS CANOE AREA WILDERNESS	
CITY CENTERS		STATE PARK	
STATE CAPITAL		REGIONAL PARK	
COUNTY SEAT		NATIONAL FOREST	
CITY CENTER		NATIONAL AND STATE FOREST	
COMMUNITY		STATE FOREST	
PUBLIC SERVICE FEATURES		WILDLIFE REFUGUE AREA	
MNDOT OFFICE		WILDLIFE MANAGEMENT AREA	
MNDOT TRUCK STATION		HYDROLOGIC FEATURES	
HIGHWAY PATROL DISTRICT OFFICE		RIVER OR STREAM (PERMANENT)	
STATE TRAVEL INFORMATION CENTER		LAKE, POND OR RESERVOIR	
REST AREA (Full Service)		STREAM (INTERMITTENT)	
REST AREA (Vault Toilet)		DRAINAGE DITCH	
WAYSIDE (Vault or Pit Toilet)		WETLAND	
PARK AND RIDE LOT		ISLAND OR LAND	
PORT OF ENTRY		REGIONAL WATERSHED	
PUBLIC ACCESS POINT			
MN STATE COLLEGE AND UNIVERSITY SYSTEM (MNSCU)			
UNIVERSITY OF MN SYSTEM			
FAIRGROUNDS			
CULTURAL FEATURES			
STATE HISTORICAL MARKER			
HISTORIC DISTRICT			
HISTORIC SITE			
MONUMENT			

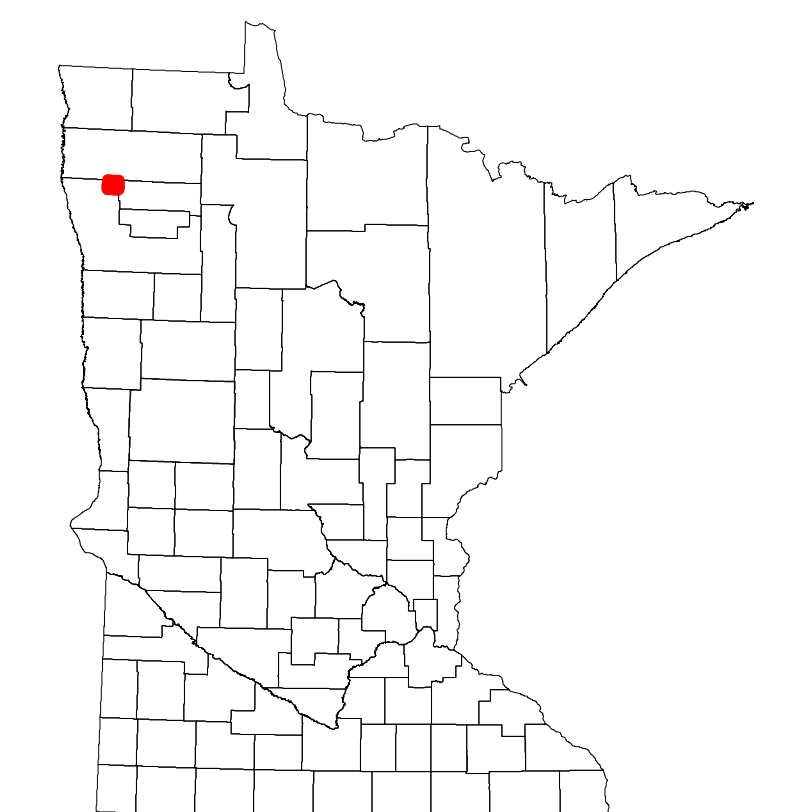

Population (U.S. Census 2010): 54

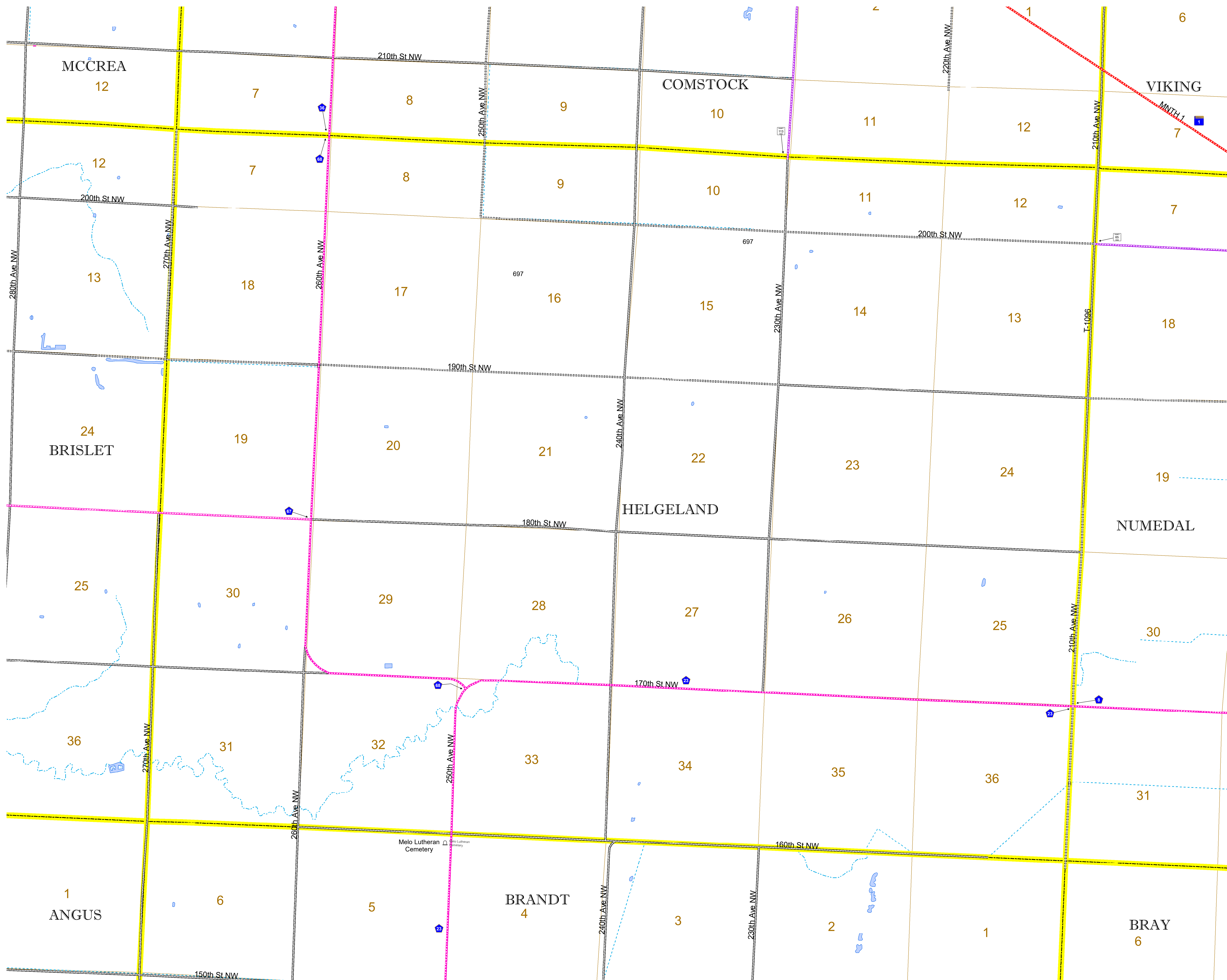

To request information from this document in an alternative format, call 651-366-4718 or 1-800-657-3774 (Greater Minnesota); 711 or 1-800-627-3529 (Minnesota Relay). You may also send an e-mail to ADRequest.dot@state.mn.us. (Please request at least one week in advance.)