

TOWNSHIP OF REDWOOD FALLS

PREPARED BY THE
MINNESOTA DEPARTMENT OF TRANSPORTATION
OFFICE OF TRANSPORTATION SYSTEM MANAGEMENT

IN COOPERATION WITH
U.S. DEPARTMENT OF TRANSPORTATION
FEDERAL HIGHWAY ADMINISTRATION

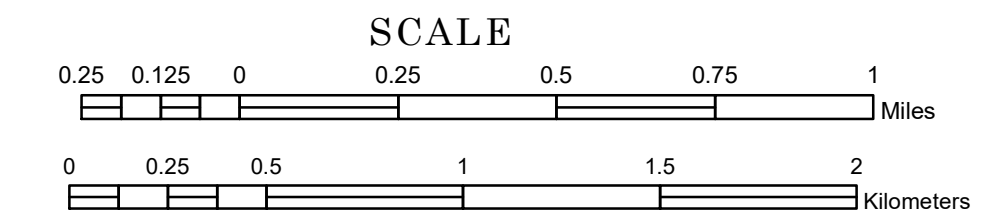

1 in = 1,600 ft

2023

Projection:
Transverse Mercator
NAD 1986
UTM Zone 15

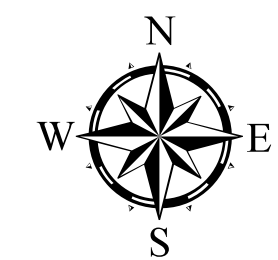

North American Datum
of 1986

ROAD AND ROADWAY FEATURES		AVIATION FEATURES	
INTERSTATE	CONCRETE	COMMERCIAL AIRPORT	GENERAL AIRPORT
US HIGHWAY	BITUMINOUS	AIRSTRIP	SEAPLANE
MN HIGHWAY	GRAVEL	AIRPORT RUNWAY	AIRPORT RUNWAY
COUNTY STATE AID HIGHWAY	DIRT/UNIMPROVED		
COUNTY ROAD	OTHER		
TOWNSHIP ROAD	UNKNOWN		
UNORGANIZED TERRITORY ROAD			
OTHER ROADS			
Municipal Private National Monument State Forest			
Nature Service National Park National Wildlife State Game			
Mulden National Forest State Park Preserve			
RAILROAD AND RAILWAY FEATURES		BOUNDARY FEATURES	
EMPIRE BUILDER STATION (AMTRAK)	TRIBAL LAND	STATE OF MINNESOTA	COUNTY
NORTHSTAR STATION (COMMUTER)	STATE OF MINNESOTA	MUNICIPALITY	MUNICIPALITY
LIGHT RAIL	UNORGANIZED TERRITORY	UNORGANIZED TERRITORY	FEDERAL ADJUSTED URBAN AREA (2014)
BLUE LINE	FEDERAL ADJUSTED URBAN AREA (2014)	CIVIL TOWNSHIP	CIVIL TOWNSHIP
GREEN LINE	CIVIL TOWNSHIP	CONGRESSIONAL TOWNSHIP	SECTION
INFRASTRUCTURE FEATURES			MILITARY
LONG BRIDGE (200' or Greater Span)	STATE OF MINNESOTA	VOYAGEURS NATIONAL PARK	BOUNDARY WATERS CANOE AREA WILDERNESS
MAJOR BRIDGE (20' to 200' Span)	COUNTY	REGIONAL PARK	NATIONAL FOREST
MINOR BRIDGE (5' to 20' Span)	MUNICIPALITY	NATIONAL AND STATE FOREST	STATE FOREST
DAM	UNORGANIZED TERRITORY	NATIONAL TRAIL	WILDLIFE REFUGE AREA
LOCK AND DAM	FEDERAL ADJUSTED URBAN AREA (2014)	WILDLIFE MANAGEMENT AREA	HYDROLOGIC FEATURES
	CIVIL TOWNSHIP	RIVER OR STREAM (PERENNIAL)	LAKE, POND OR RESERVOIR
	CONGRESSIONAL TOWNSHIP	STREAM (INTERMITTENT)	DRAINAGE DITCH
	SECTION	WETLAND	ISLAND OR LAND
	MILITARY	REGIONAL WATERSHED	
	VOYAGEURS NATIONAL PARK		
	BOUNDARY WATERS CANOE AREA WILDERNESS		
	REGIONAL PARK		
	NATIONAL FOREST		
	NATIONAL AND STATE FOREST		
	STATE FOREST		
	WILDLIFE REFUGE AREA		
	WILDLIFE MANAGEMENT AREA		
	RIVER OR STREAM (PERENNIAL)		
	LAKE, POND OR RESERVOIR		
	STREAM (INTERMITTENT)		
	DRAINAGE DITCH		
	WETLAND		
	ISLAND OR LAND		
	REGIONAL WATERSHED		

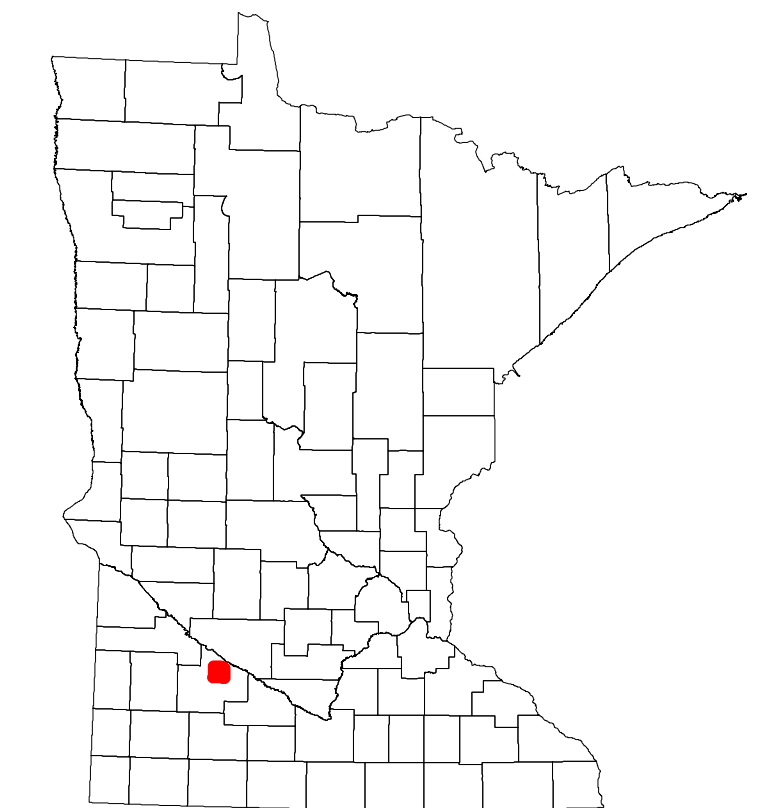

Population (U.S. Census 2010): 181

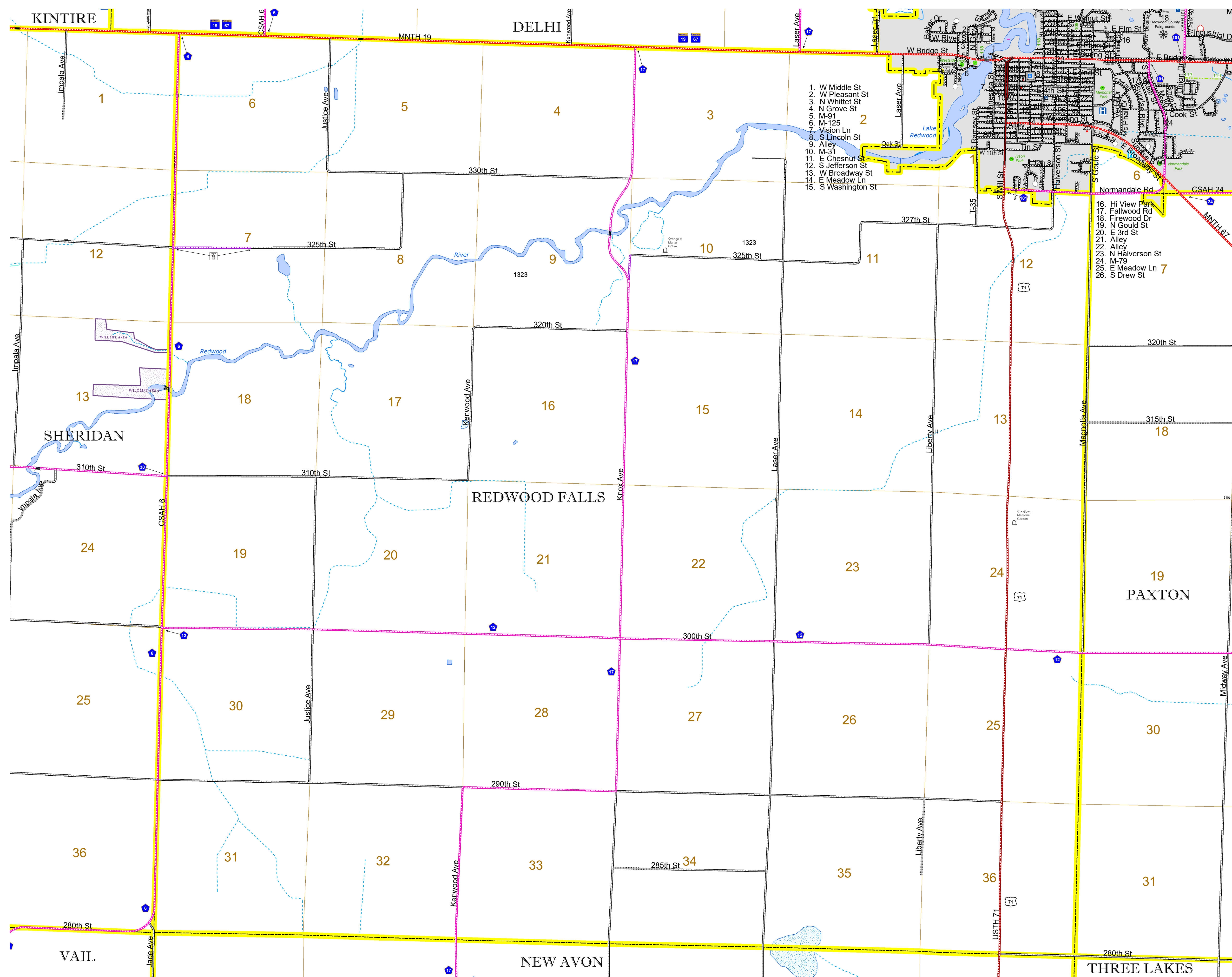

1. W Middle St
2. W Pleasant St
3. N Whittet St
4. N Grove St
5. M-91
6. M-125
7. Vision Ln
8. S Lincoln St
9. Alley
10. M-31
11. F Chesnut St
12. S Jefferson St
13. W Broadway St
14. E Meadow Ln
15. S Washington St

16. Hi View Park
17. Fallwood Rd
18. Firewood Dr
19. N Gould St
20. E 3rd St
21. Alley
22. N Halverson St
23. M-79
24. E Meadow Ln
25. E Meadow Ln
26. S Drew St

To request information from this document in an alternative format, call 651-366-4718 or 1-800-657-3774 (Greater Minnesota); 711 or 1-800-627-3529 (Minnesota Relay). You may also send an e-mail to ADArequest.dot@state.mn.us. (Please request at least one week in advance.)