

TOWNSHIP OF OSCEOLA

PREPARED BY THE
MINNESOTA DEPARTMENT OF TRANSPORTATION
OFFICE OF TRANSPORTATION SYSTEM MANAGEMENT

IN COOPERATION WITH
U.S. DEPARTMENT OF TRANSPORTATION
FEDERAL HIGHWAY ADMINISTRATION

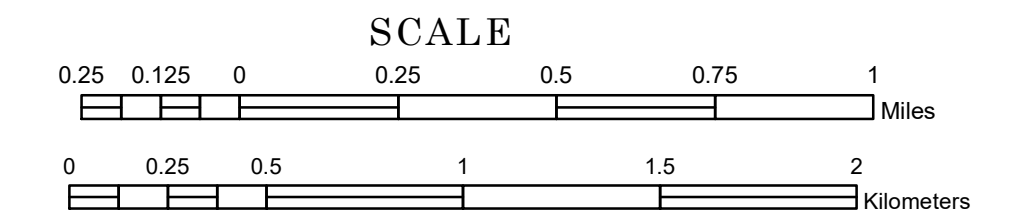

1 in = 1,600 ft
2023

Projection:
Transverse Mercator
NAD 1986
UTM Zone 15



North American Datum
of 1986

ROAD AND ROADWAY FEATURES		AVIATION FEATURES	
INTERSTATE	CONCRETE	COMMERCIAL AIRPORT	GENERAL AIRPORT
US HIGHWAY	BITUMINOUS	AIRSTRIP	SEAPLANE
MN HIGHWAY	GRAVEL	AIRPORT RUNWAY	BOUNDARY FEATURES
COUNTY STATE AID HIGHWAY	DIRT/UNIMPROVED	TRIBAL LAND	STATE OF MINNESOTA
COUNTY ROAD	OTHER	COUNTY	MUNICIPALITY
TOWNSHIP ROAD	UNKNOWN	UNINCORPORATED	CIVIL TOWNSHIP
UNORGANIZED TERRITORY ROAD		CONGRESSIONAL TOWNSHIP	SECTION
OTHER ROADS		MILITARY	VOYAGEURS NATIONAL PARK
Municipal	RAMP OR CONNECTOR		BOUNDARY WATERS CANOE AREA WILDERNESS
National	INTERSTATE EXIT		STATE PARK
Private	GREAT RIVER ROAD		REGIONAL PARK
National Monument			NATIONAL FOREST
National Wildlife Refuge			NATIONAL AND STATE FOREST
State Game			STATE FOREST
National Forest			NATIONAL TRAIL
State Park			WILDLIFE REFUGUE AREA
Preserve			WILDLIFE MANAGEMENT AREA
			HYDROLOGIC FEATURES
			RIVER OR STREAM (PERMANENT)
			LAKE, POND OR RESERVOIR
			STREAM (INTERMITTENT)
			DRAINAGE DITCH
			WETLAND
			ISLAND OR LAND
			REGIONAL WATERSHED

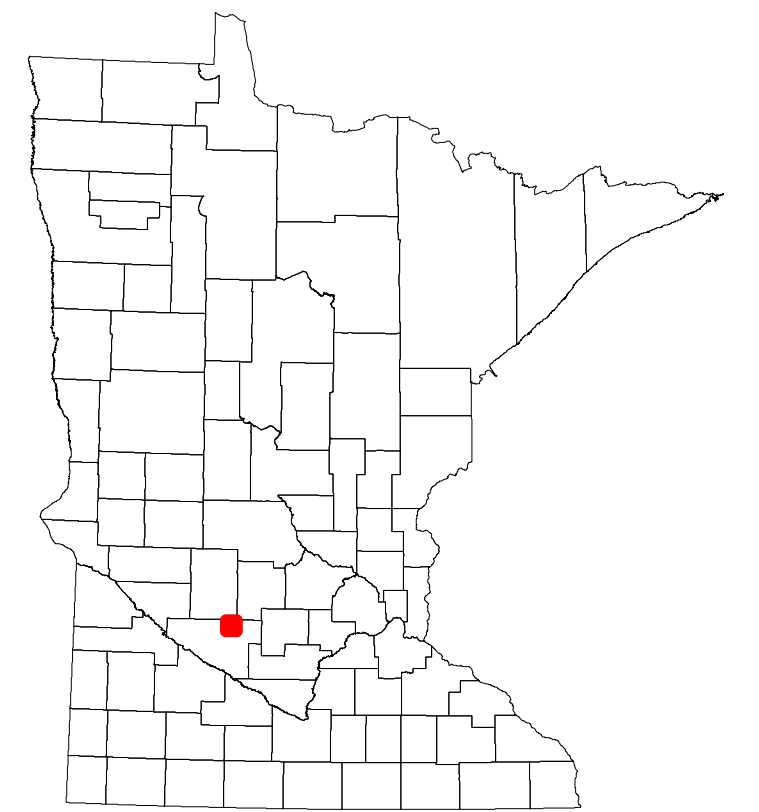

Population (U.S. Census 2010): 158

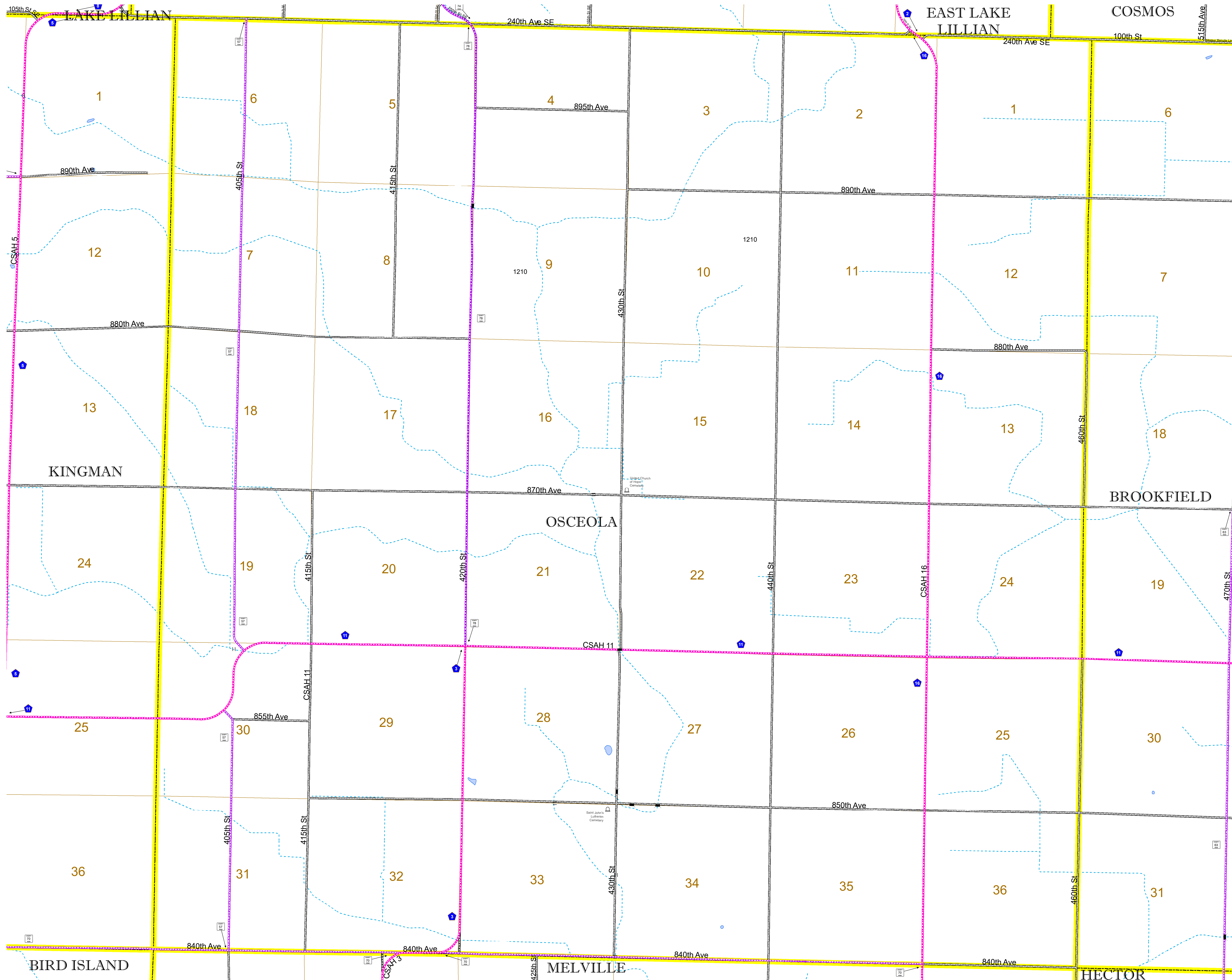

To request information from this document in an alternative format, call 651-366-4718 or 1-800-657-3774 (Greater Minnesota); 711 or 1-800-627-3529 (Minnesota Relay). You may also send an e-mail to ADARquest.dot@state.mn.us. (Please request at least one week in advance.)