

TOWNSHIP OF RICHLAND

PREPARED BY THE
MINNESOTA DEPARTMENT OF TRANSPORTATION
OFFICE OF TRANSPORTATION SYSTEM MANAGEMENT

IN COOPERATION WITH
U.S. DEPARTMENT OF TRANSPORTATION
FEDERAL HIGHWAY ADMINISTRATION

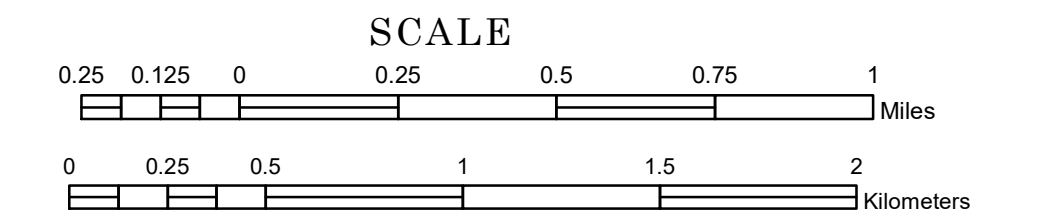

Projection:
Transverse Mercator
NAD 1986
UTM Zone 15

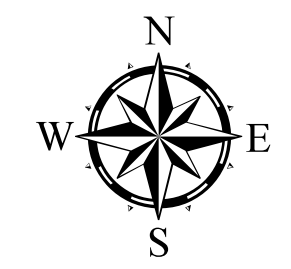

North American Datum
of 1986

| ROAD AND ROADWAY FEATURES | |
|--|---------------------------------------|
| INTERSTATE | CONCRETE |
| US HIGHWAY | BITUMINOUS |
| MN HIGHWAY | GRAVEL |
| COUNTY STATE AID HIGHWAY | DIRT/UNIMPROVED |
| COUNTY ROAD | OTHER |
| TOWNSHIP ROAD | UNKNOWN |
| UNORGANIZED TERRITORY ROAD | |
| OTHER ROADS | RAMP OR CONNECTOR |
| Municipal | INTERSTATE EXIT |
| Nature Service | GREAT RIVER ROAD |
| Museum | |
| RAILROAD AND RAILWAY FEATURES | |
| EMPIRE BUILDER STATION (AMTRAK) | COMMERCIAL AIRPORT |
| NORTHSTAR STATION (COMMUTER) | GENERAL AIRPORT |
| LIGHT RAIL | AIRSTRIP |
| BLUE LINE | SEAPLANE |
| GREEN LINE | AIRPORT RUNWAY |
| INFRASTRUCTURE FEATURES | |
| LONG BRIDGE (200' or Greater Span) | TRIAL LAND |
| MAJOR BRIDGE (20' to 200' Span) | STATE OF MINNESOTA |
| MINOR BRIDGE (5' to 20' Span) | COUNTY |
| LOCK AND DAM | MUNICIPALITY |
| CITY CENTERS | |
| STATE CAPITAL | UNINCORPORATED COMMUNITY |
| COUNTY SEAT | |
| CITY CENTER | |
| PUBLIC SERVICE FEATURES | |
| MNDOT OFFICE | VOYAGEURS NATIONAL PARK |
| MNDOT TRUCK STATION | BOUNDARY WATERS CANOE AREA WILDERNESS |
| HIGHWAY PATROL DISTRICT OFFICE | STATE PARK |
| STATE TRAVEL INFORMATION CENTER | REGIONAL PARK |
| REST AREA (Full Service) | NATIONAL FOREST |
| REST AREA (Vault Toilet) | NATIONAL AND STATE FOREST |
| WAYSIDE (Vault or Pit Toilet) | STATE FOREST |
| PARK AND RIDE LOT | NATIONAL TRAIL |
| PORT OF ENTRY | WILDLIFE REFUGUE AREA |
| PUBLIC ACCESS POINT | WILDLIFE MANAGEMENT AREA |
| MN STATE COLLEGE AND UNIVERSITY SYSTEM (MNSCU) | HYDROLOGIC FEATURES |
| UNIVERSITY OF MN SYSTEM | RIVER OR STREAM (Perennial) |
| FARMSHOULDS | LAKE, POND OR RESERVOIR |
| CULTURAL FEATURES | |
| STATE HISTORICAL MARKER | STREAM (Intermittent) |
| HISTORIC DISTRICT | DRAINAGE DITCH |
| HISTORIC SITE | WETLAND |
| MONUMENT | ISLAND OR LAND |
| | REGIONAL WATERSHED |

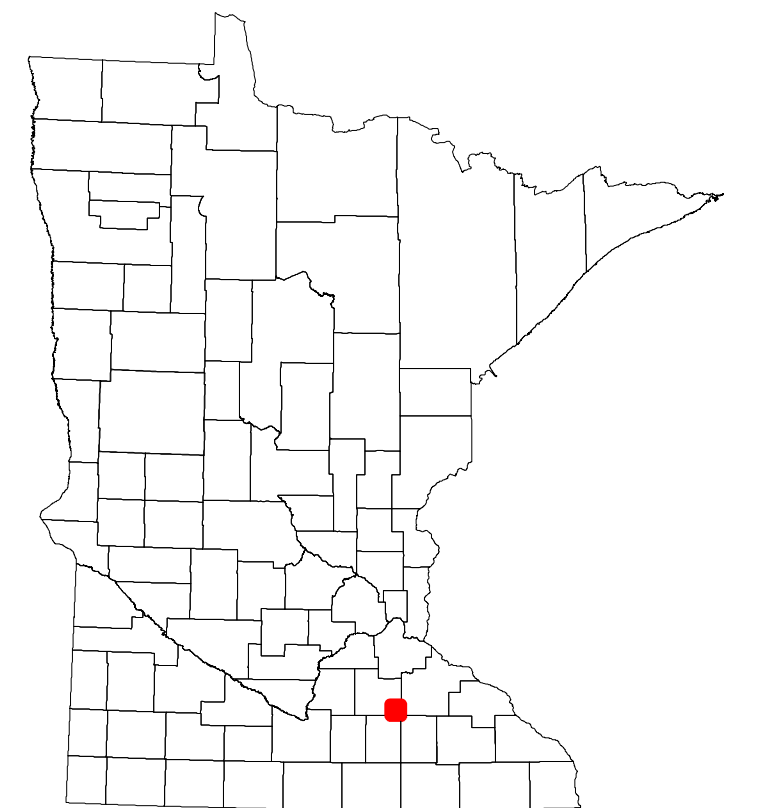

Population (U.S. Census 2010): 416

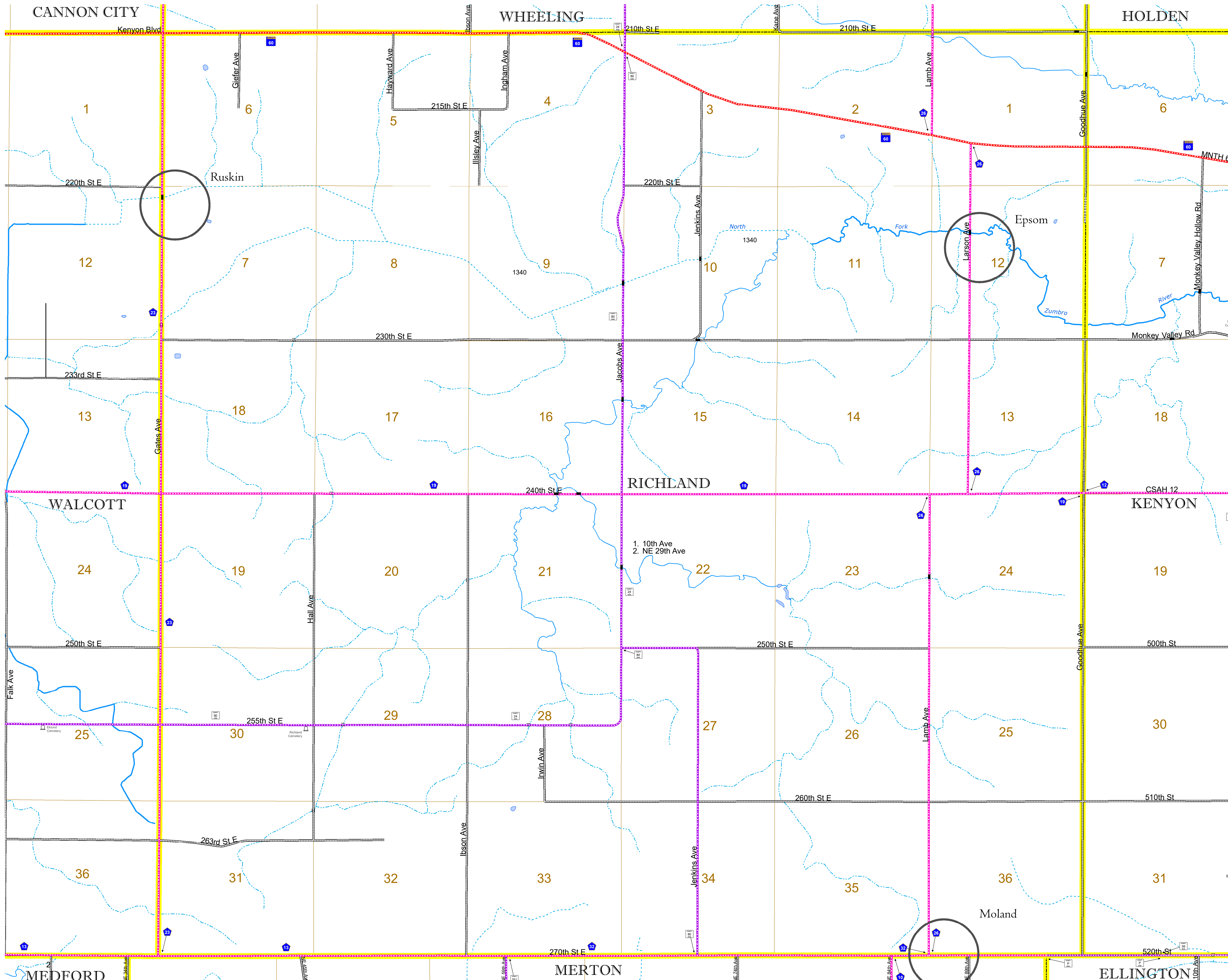

To request information from this document in an alternative format, call 651-366-4718 or 1-800-657-3774 (Greater Minnesota); 711 or 1-800-627-3529 (Minnesota Relay). You may also send an e-mail to ADArequest.dot@state.mn.us. (Please request at least one week in advance.)