

TOWNSHIP OF BARNETT

PREPARED BY THE
MINNESOTA DEPARTMENT OF TRANSPORTATION
OFFICE OF TRANSPORTATION SYSTEM MANAGEMENT

IN COOPERATION WITH
U.S. DEPARTMENT OF TRANSPORTATION
FEDERAL HIGHWAY ADMINISTRATION



2023

Projection:
Transverse Mercator
NAD 1986
UTM Zone 15



North American Datum
of 1986

| ROAD AND ROADWAY FEATURES | | RAILROAD AND RAILWAY FEATURES | | AVIATION FEATURES | | BOUNDARY FEATURES | |
|----------------------------|--|-------------------------------|--|--------------------|--|---------------------------------------|--|
| INTERSTATE | | CONCRETE | | COMMERCIAL AIRPORT | | TRIBAL LAND | |
| US HIGHWAY | | BITUMINOUS | | GENERAL AIRPORT | | STATE OF MINNESOTA | |
| MN HIGHWAY | | GRAVEL | | AIRSTRIP | | COUNTY | |
| COUNTY STATE AID HIGHWAY | | DIRT/UNIMPROVED | | SEAPLANE | | MUNICIPALITY | |
| COUNTY ROAD | | OTHER | | AIRPORT RUNWAY | | UNINCORPORATED | |
| TOWNSHIP ROAD | | UNKNOWN | | | | CIVIL TOWNSHIP | |
| UNORGANIZED TERRITORY ROAD | | | | | | FEDERAL ADJUSTED URBAN AREA (2014) | |
| OTHER ROADS | | | | | | CIVIL TOWNSHIP | |
| Municipal | | RAMP OR CONNECTOR | | COMMERCIAL AIRPORT | | CONGRESSIONAL TOWNSHIP | |
| Private | | INTERSTATE EXIT | | GENERAL AIRPORT | | SECTION | |
| Nature Service | | GREAT RIVER ROAD | | AIRSTRIP | | MILITARY | |
| National Park | | | | SEAPLANE | | VOYAGEURS NATIONAL PARK | |
| National Forest | | | | AIRPORT RUNWAY | | BOUNDARY WATERS CANOE AREA WILDERNESS | |
| State Park | | | | | | STATE PARK | |
| Preserve | | | | | | REGIONAL PARK | |
| | | | | | | NATIONAL FOREST | |
| | | | | | | NATIONAL AND STATE FOREST | |
| | | | | | | STATE FOREST | |
| | | | | | | WILDLIFE REFUGUE AREA | |
| | | | | | | WILDLIFE MANAGEMENT AREA | |
| | | | | | | HYDROLOGIC FEATURES | |
| | | | | | | RIVER OR STREAM (PERENNIAL) | |
| | | | | | | LAKE, POND OR RESERVOIR | |
| | | | | | | STREAM (INTERMITTENT) | |
| | | | | | | DRAINAGE DITCH | |
| | | | | | | WETLAND | |
| | | | | | | ISLAND OR LAND | |
| | | | | | | REGIONAL WATERSHED | |

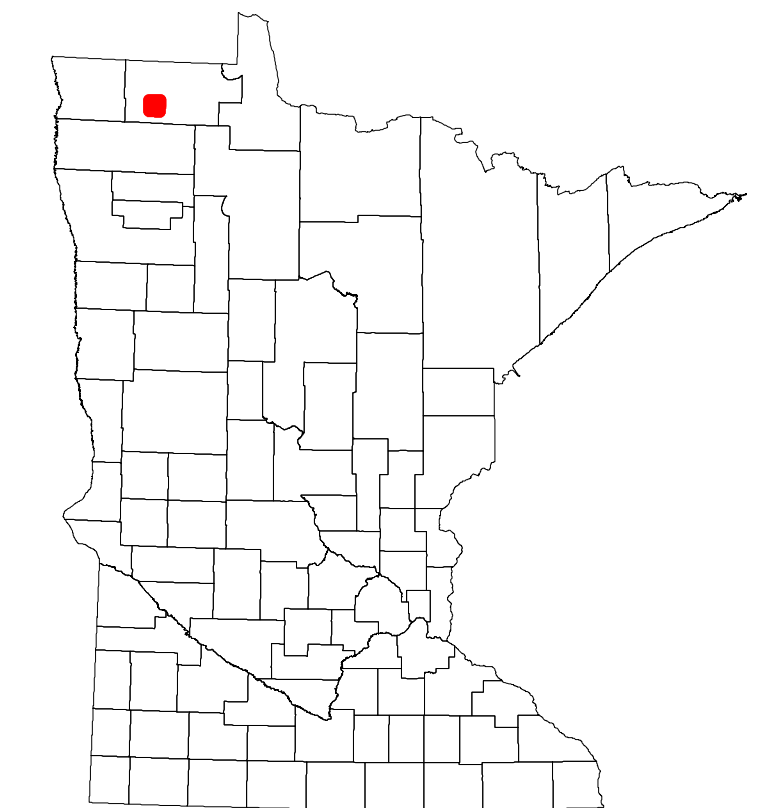

Population (U.S. Census 2010): 139

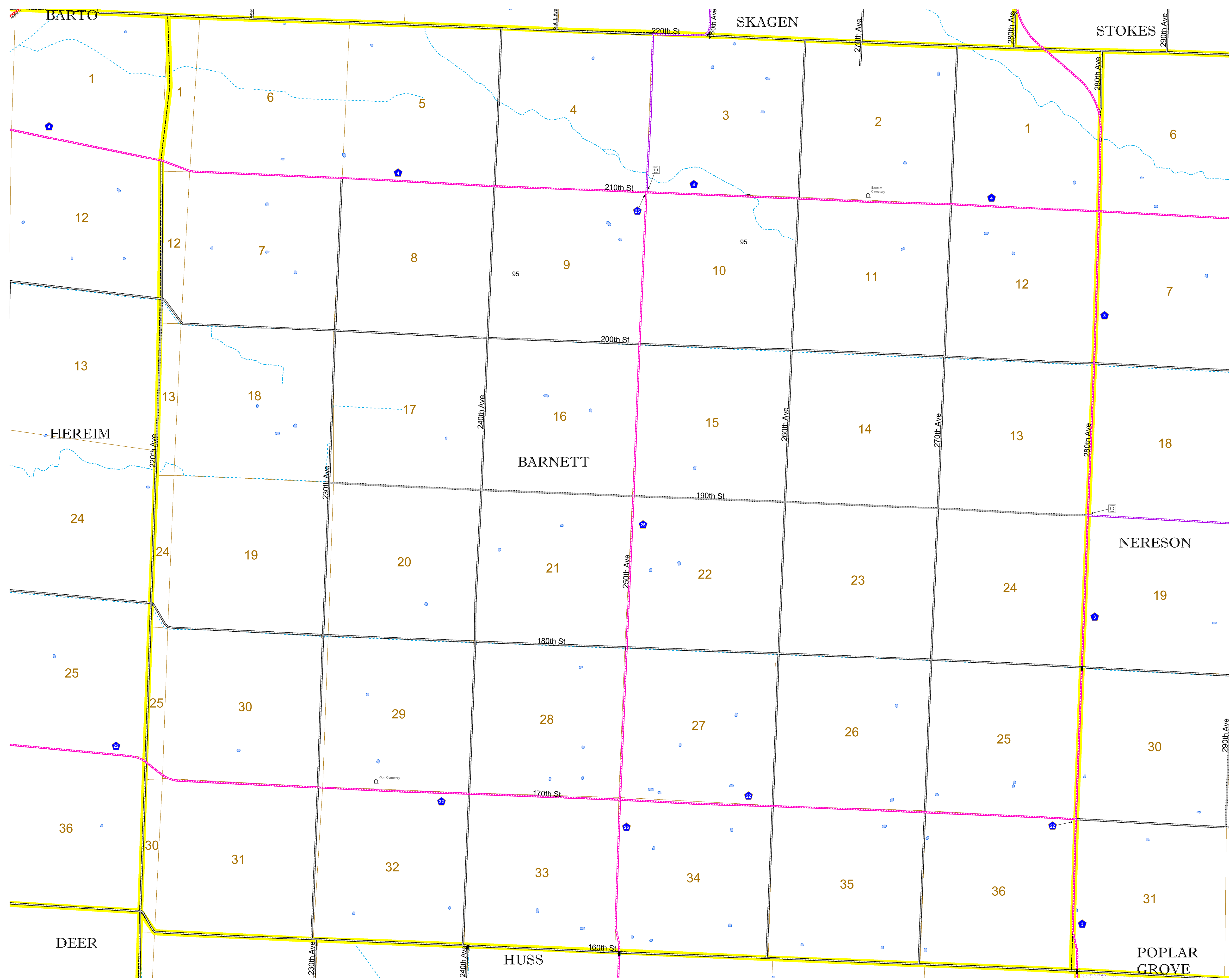

To request information from this document in an alternative format, call 651-366-4718 or 1-800-657-3774 (Greater Minnesota); 711 or 1-800-627-3529 (Minnesota Relay). You may also send an e-mail to ADAREquest.dot@state.mn.us. (Please request at least one week in advance.)