

TOWNSHIP OF FALUN

PREPARED BY THE
MINNESOTA DEPARTMENT OF TRANSPORTATION
OFFICE OF TRANSPORTATION SYSTEM MANAGEMENT

IN COOPERATION WITH
U.S. DEPARTMENT OF TRANSPORTATION
FEDERAL HIGHWAY ADMINISTRATION



1 in = 1,600 ft
2023

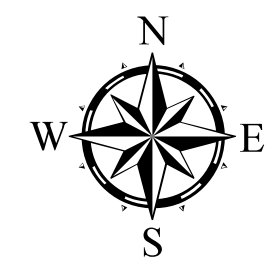

Projection:
Transverse Mercator
NAD 1986
UTM Zone 15

North American Datum
of 1986

<p>INTERSTATE</p> <p>US HIGHWAY</p> <p>MN HIGHWAY</p> <p>COUNTY STATE AID HIGHWAY</p> <p>COUNTY ROAD</p> <p>TOWNSHIP ROAD</p> <p>UNORGANIZED TERRITORY ROAD</p> <p>OTHER ROADS</p> <p>Municipal</p> <p>Private</p> <p>National Monument</p> <p>National Wildlife Refuge</p> <p>State Forest</p> <p>State Game</p> <p>State Park</p> <p>Preserve</p> <p>RAILROAD AND RAILWAY FEATURES</p> <p>EMPIRE BUILDER STATION (AMTRAK)</p> <p>NORTHSTAR STATION (COMMUTER)</p> <p>LIGHT RAIL</p> <p>BLUE LINE</p> <p>GREEN LINE</p> <p>INFRASTRUCTURE FEATURES</p> <p>LONG BRIDGE (200' or Greater Span)</p> <p>MAJOR BRIDGE (20' to 200' Span)</p> <p>MINOR BRIDGE (5' to 20' Span)</p> <p>DAM</p> <p>LOCK AND DAM</p> <p>CITY CENTERS</p> <p>STATE CAPITAL</p> <p>COUNTY SEAT</p> <p>CITY CENTER</p> <p>UNINCORPORATED COMMUNITY</p> <p>PUBLIC SERVICE FEATURES</p> <p>MNDOT OFFICE</p> <p>MNDOT TRUCK STATION</p> <p>HIGHWAY PATROL DISTRICT OFFICE</p> <p>STATE TRAVEL INFORMATION CENTER</p> <p>REST AREA (Full Service)</p> <p>REST AREA (Vault Toilet)</p> <p>WAYSIDE (Vault or Pit Toilet)</p> <p>PARK AND RIDE LOT</p> <p>PORT OF ENTRY</p> <p>PUBLIC ACCESS POINT</p> <p>MN STATE COLLEGE AND UNIVERSITY SYSTEM (MNSCU)</p> <p>UNIVERSITY OF MN SYSTEM</p> <p>FAIRGROUNDS</p> <p>CULTURAL FEATURES</p> <p>STATE HISTORICAL MARKER</p> <p>HISTORIC DISTRICT</p> <p>HISTORIC SITE</p> <p>MONUMENT</p>	<p>ROAD AND ROADWAY FEATURES</p> <p>CONCRETE</p> <p>BITUMINOUS</p> <p>GRAVEL</p> <p>DIRT/UNIMPROVED</p> <p>OTHER</p> <p>UNKNOWN</p> <p>RAMP OR CONNECTOR</p> <p>INTERSTATE EXIT</p> <p>GREAT RIVER ROAD</p> <p>AVIATION FEATURES</p> <p>COMMERCIAL AIRPORT</p> <p>GENERAL AIRPORT</p> <p>AIRSTRIP</p> <p>SEAPLANE</p> <p>AIRPORT RUNWAY</p> <p>BOUNDARY FEATURES</p> <p>TRIBAL LAND</p> <p>STATE OF MINNESOTA</p> <p>COUNTY</p> <p>MUNICIPALITY</p> <p>UNORGANIZED TERRITORY</p> <p>FEDERAL ADJUSTED URBAN AREA (2014)</p> <p>CIVIL TOWNSHIP</p> <p>CONGRESSIONAL TOWNSHIP</p> <p>SECTION</p> <p>MILITARY</p> <p>VOYAGEURS NATIONAL PARK</p> <p>BOUNDARY WATERS CANOE AREA WILDERNESS</p> <p>STATE PARK</p> <p>REGIONAL PARK</p> <p>NATIONAL FOREST</p> <p>NATIONAL AND STATE FOREST</p> <p>STATE FOREST</p> <p>NATIONAL TRAIL</p> <p>WILDLIFE REFUGE AREA</p> <p>WILDLIFE MANAGEMENT AREA</p> <p>HYDROLOGIC FEATURES</p> <p>RIVER OR STREAM (PERENNIAL)</p> <p>LAKE, POND OR RESERVOIR</p> <p>STREAM (INTERMITTENT)</p> <p>DRAINAGE DITCH</p> <p>WETLAND</p> <p>ISLAND OR LAND</p> <p>REGIONAL WATERSHED</p>
--	---

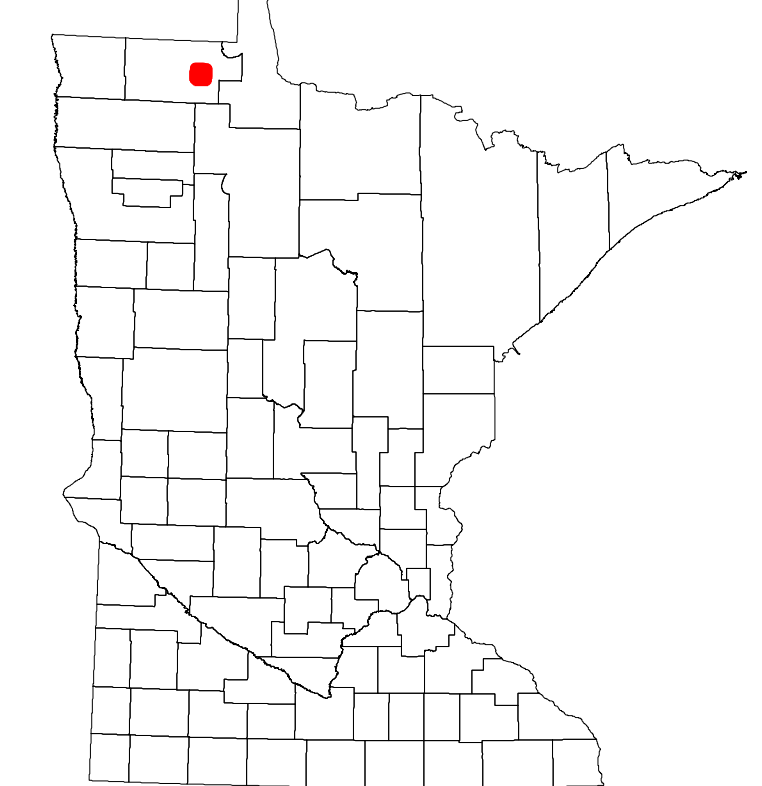

Population (U.S. Census 2010): 251

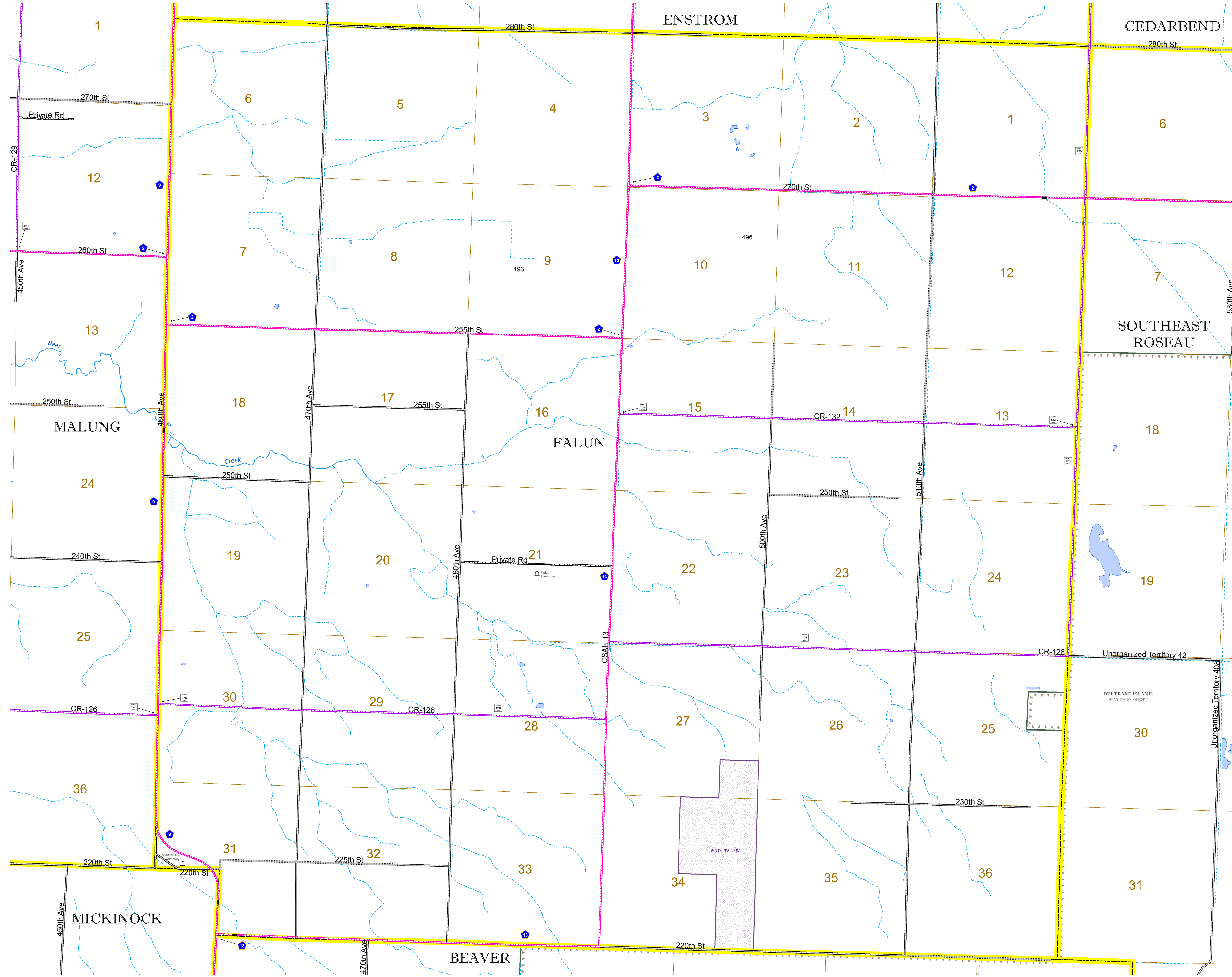

To request information from this document in an alternative format, call 651-366-4718 or 1-800-657-3774 (Greater Minnesota); 711 or 1-800-627-3529 (Minnesota Relay). You may also send an e-mail to ADRequest.dot@state.mn.us. (Please request at least one week in advance.)