

CARPENTER

NORTHWEST SAINT LOUIS

LINDEN GROVE

TOWNSHIP OF MORCOM

PREPARED BY THE
MINNESOTA DEPARTMENT OF TRANSPORTATION
OFFICE OF TRANSPORTATION SYSTEM MANAGEMENT

IN COOPERATION WITH
U.S. DEPARTMENT OF TRANSPORTATION
FEDERAL HIGHWAY ADMINISTRATION

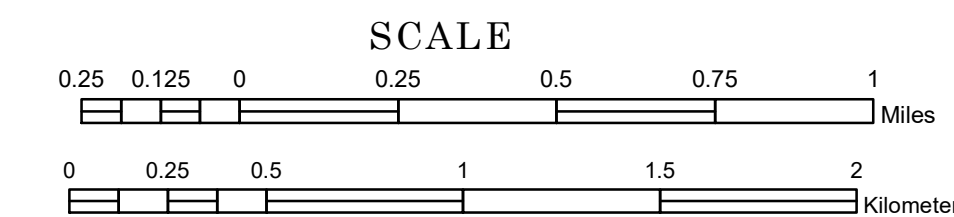

1 in = 1,600 ft

2023

Projection:
Transverse Mercator
NAD 1986
UTM Zone 15

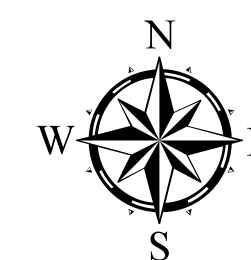

North American Datum
of 1986

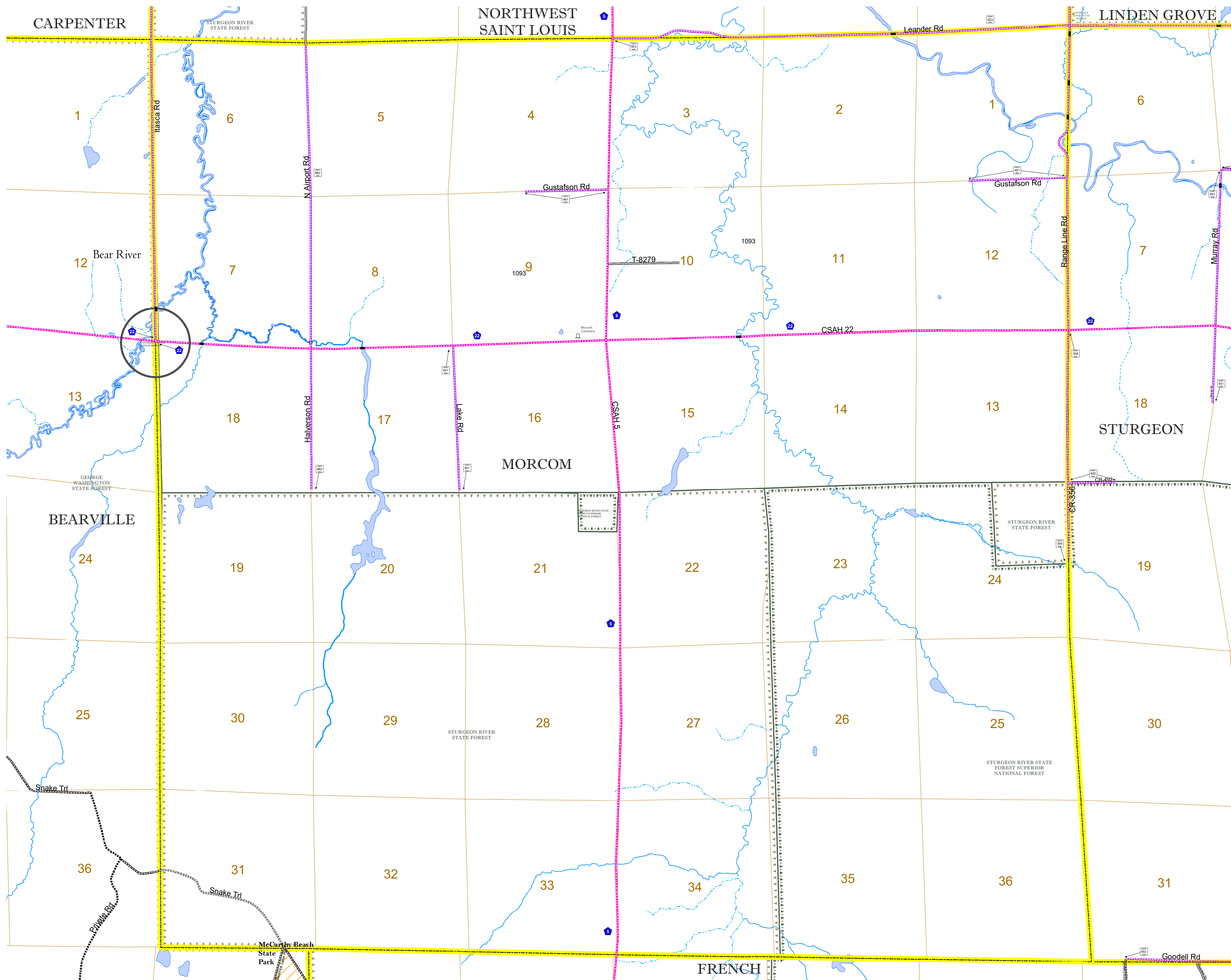

ROAD AND ROADWAY FEATURES		AVIATION FEATURES	
INTERSTATE	CONCRETE	COMMERCIAL AIRPORT	GENERAL AIRPORT
US HIGHWAY	BITUMINOUS	AIRSTRIP	SEAPLANE
MN HIGHWAY	GRAVEL	AIRPORT RUNWAY	TRIAL LAND
COUNTY STATE AID HIGHWAY	DIRT/UNIMPROVED	INTERSTATE EXIT	STATE OF MINNESOTA
COUNTY ROAD	OTHER	GREAT RIVER ROAD	COUNTY
TOWNSHIP ROAD	UNKNOWN	RAILROAD AND RAILWAY FEATURES	MUNICIPALITY
UNORGANIZED TERRITORY ROAD		EMPIRE BUILDER STATION (AMTRAK)	UNORGANIZED TERRITORY
OTHER ROADS		NORTHSTAR STATION (COMMUTER)	FEDERAL ADJUSTED URBAN AREA (2014)
Municipal		LIGHT RAIL	CIVIL TOWNSHIP
Private		BLUE LINE	CONGRESSIONAL TOWNSHIP
National Monument		GREEN LINE	UNINCORPORATED COMMUNITY
National Park		INFRASTRUCTURE FEATURES	PUBLIC SERVICE FEATURES
National Wildlife Refuge		LONG BRIDGE (200' or Greater Span)	MNDOT OFFICE
State Park		MAJOR BRIDGE (20' to 200' Span)	MNDOT TRUCK STATION
Preserve		MINOR BRIDGE (5' to 20' Span)	HIGHWAY PATROL DISTRICT OFFICE
		DAM	STATE TRAVEL INFORMATION CENTER
		LOCK AND DAM	REST AREA (Full Service)
			REST AREA (Vault Toilets)
			WAYSIDE (Vault or Pit Toilets)
			PARK AND RIDE LOT
			PORT OF ENTRY
			PUBLIC ACCESS POINT
			MN STATE COLLEGE AND UNIVERSITY SYSTEM (MNSCU)
			UNIVERSITY OF MN SYSTEM
			FAIRGROUNDS
			CULTURAL FEATURES
			STATE HISTORICAL MARKER
			HISTORIC DISTRICT
			HISTORIC SITE
			MONUMENT
			HYDROLOGIC FEATURES
			RIVER OR STREAM (Perennial)
			LAKE, POND OR RESERVOIR
			STREAM (Intermittent)
			DRAINAGE DITCH
			WETLAND
			ISLAND OR LAND
			REGIONAL WATERSHED

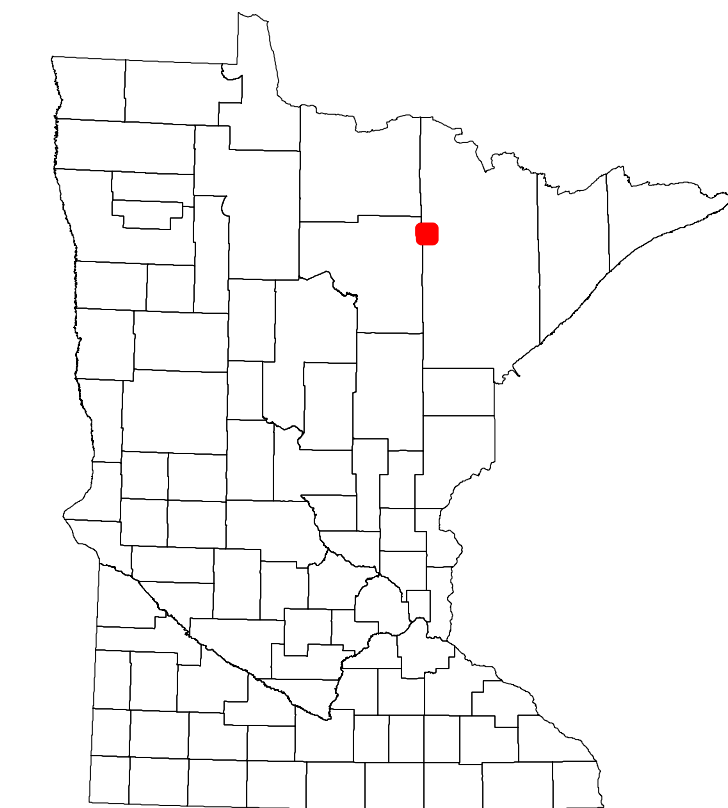

Population (U.S. Census 2010): 94

To request information from this document in an alternative format, call 651-366-4718 or 1-800-657-3774 (Greater Minnesota); 711 or 1-800-627-3529 (Minnesota Relay). You may also send an e-mail to ADRequest.dot@state.mn.us. (Please request at least one week in advance.)