

TOWNSHIP OF SPRING LAKE

PREPARED BY THE
MINNESOTA DEPARTMENT OF TRANSPORTATION
OFFICE OF TRANSPORTATION SYSTEM MANAGEMENT

IN COOPERATION WITH
U.S. DEPARTMENT OF TRANSPORTATION
FEDERAL HIGHWAY ADMINISTRATION

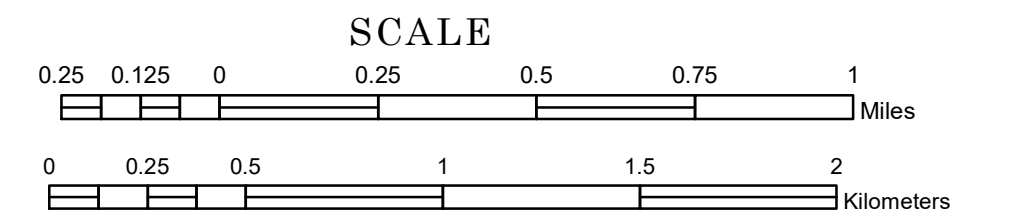

1 in = 1,600 ft
2024

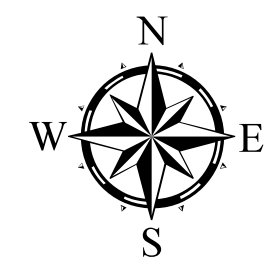

Projection:
Transverse Mercator
NAD 1986
UTM Zone 15

North American Datum
of 1986

ROAD AND ROADWAY FEATURES										
INTERSTATE	CONCRETE									
US HIGHWAY	BITUMINOUS									
MN HIGHWAY	GRAVEL									
COUNTY STATE AID HIGHWAY	DIRT/UNIMPROVED									
COUNTY ROAD	OTHER									
TOWNSHIP ROAD	UNKNOWN									
UNORGANIZED TERRITORY ROAD										
OTHER ROADS	RAMP OR CONNECTOR									
Municipal	Private	National Monument	State Forest	State Game	National Wildlife	State Game	National Forest	State Park	Present	AVIATION FEATURES
										COMMERCIAL AIRPORT
										GENERAL AIRPORT
										AIRSTRIP
										SEAPLANE
										AIRPORT RUNWAY
										BOUNDARY FEATURES
										TRIBAL LAND
										STATE OF MINNESOTA
										COUNTY
										MUNICIPALITY
										UNORGANIZED TERRITORY
										FEDERAL ADJUSTED URBAN AREA (2014)
										CIVIL TOWNSHIP
										CONGRESSIONAL TOWNSHIP
										SECTION
										MILITARY
										VOYAGEURS NATIONAL PARK
										BOUNDARY WATERS CANOE AREA WILDERNESS
										STATE PARK
										REGIONAL PARK
										NATIONAL FOREST
										NATIONAL AND STATE FOREST
										STATE FOREST
										NATIONAL TRAIL
										WILDLIFE REFUGUE AREA
										WILDLIFE MANAGEMENT AREA
										HYDROLOGIC FEATURES
										RIVER OR STREAM (PERENNIAL)
										LAKE, POND OR RESERVOIR
										STREAM (INTERMITTENT)
										DRAINAGE DITCH
										WETLAND
										ISLAND OR LAND
										REGIONAL WATERSHED

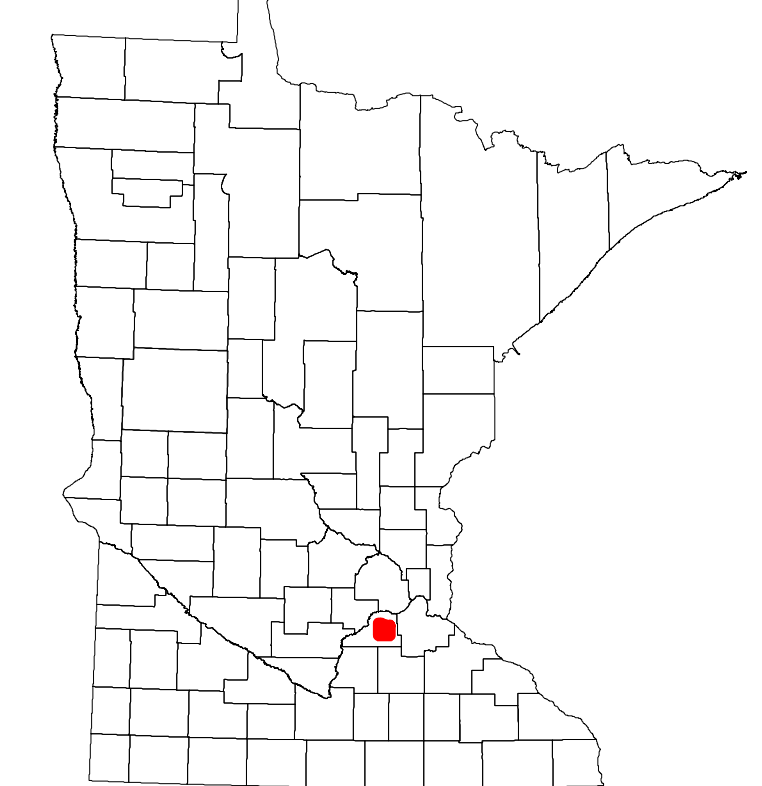

Population (U.S. Census 2010): 3631

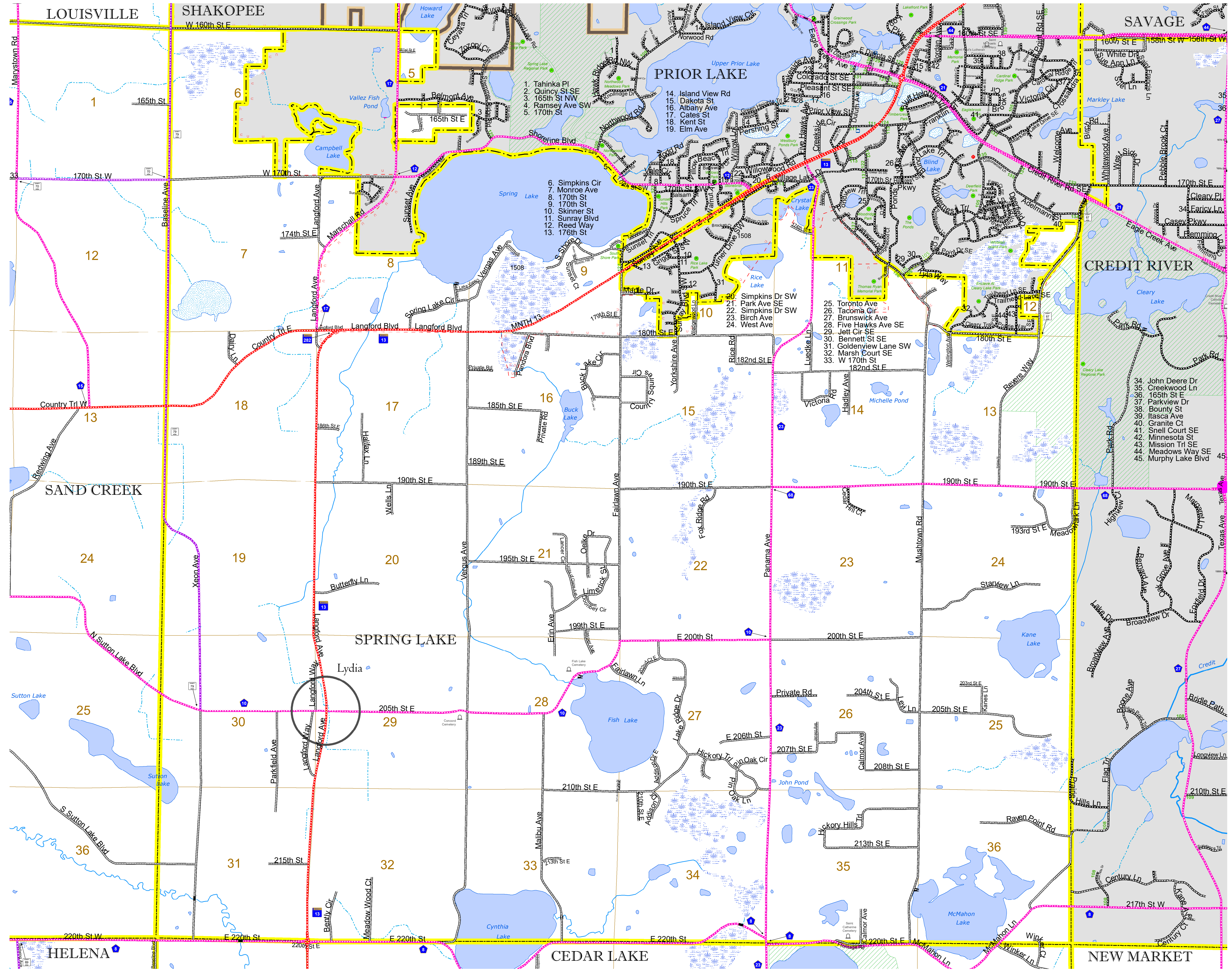

To request information from this document in an alternative format, call 651-366-4718 or 1-800-657-3774 (Greater Minnesota); 711 or 1-800-627-3529 (Minnesota Relay). You may also send an e-mail to ADArequest.dot@state.mn.us. (Please request at least one week in advance.)