

# TOWNSHIP OF OAK

PREPARED BY THE  
MINNESOTA DEPARTMENT OF TRANSPORTATION  
OFFICE OF TRANSPORTATION SYSTEM MANAGEMENT

IN COOPERATION WITH  
U.S. DEPARTMENT OF TRANSPORTATION  
FEDERAL HIGHWAY ADMINISTRATION

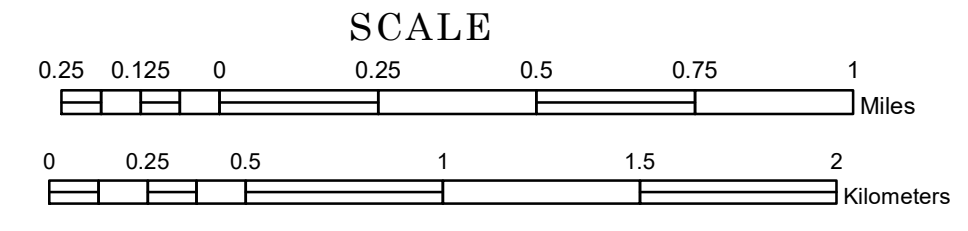

1 in = 1,600 ft  
**2024**

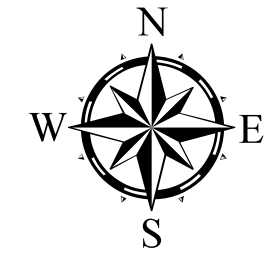

North American Datum  
of 1986

Projection:  
Transverse Mercator  
NAD 1986  
UTM Zone 15

ROAD AND ROADWAY FEATURES		BOUNDARY FEATURES	
INTERSTATE	CONCRETE	TRIAL LAND	TRIBAL LAND
US HIGHWAY	BITUMINOUS	STATE OF MINNESOTA	COUNTY
MN HIGHWAY	GRAVEL	MUNICIPALITY	UNINCORPORATED COMMUNITY
COUNTY STATE AID HIGHWAY	DIRT/UNIMPROVED	UNINCORPORATED TERRITORY	FEDERAL ADJUSTED URBAN AREA (2014)
COUNTY ROAD	OTHER	CIVIL TOWNSHIP	CONGRESSIONAL TOWNSHIP
TOWNSHIP ROAD	UNKNOWN	SECTION	MILITARY
UNORGANIZED TERRITORY ROAD		VOYAGEURS NATIONAL PARK	BOUNDARY WATERS CANOE AREA WILDERNESS
OTHER ROADS		STATE PARK	NATIONAL FOREST
Municipal	RAMP OR CONNECTOR	NATIONAL AND STATE FOREST	STATE FOREST
Private	INTERSTATE EXIT	WILDLIFE REFUGUE AREA	WILDLIFE MANAGEMENT AREA
National Monument	GREAT RIVER ROAD	HYDROLOGICAL FEATURES	RIVER OR STREAM (PERMANENT)
National Park	RAILROAD AND RAILWAY FEATURES	LAKE, POND OR RESERVOIR	STREAM (INTERMITTENT)
National Wildlife Refuge	EMPIRE BUILDER STATION (AMTRAK)	DRAINAGE DITCH	WETLAND
State Park	NORTHSTAR STATION (COMMUTER)	ISLAND OR LAND	REGIONAL WATERSHED
Present	LIGHT RAIL		
	BLUE LINE		
	GREEN LINE		
	INFRASTRUCTURE FEATURES		
	LONG BRIDGE (200' OR GREATER SPAN)		
	MAJOR BRIDGE (20' TO 200' SPAN)		
	MINOR BRIDGE (5' TO 20' SPAN)		
	DAM		
	LOCK AND DAM		
	CITY CENTERS		
	STATE CAPITAL		
	COUNTY SEAT		
	CITY CENTER		
	UNINCORPORATED COMMUNITY		
	PUBLIC SERVICE FEATURES		
	MNDOT OFFICE		
	MNDOT TRUCK STATION		
	HIGHWAY PATROL DISTRICT OFFICE		
	STATE TRAVEL INFORMATION CENTER		
	REST AREA (FULL SERVICE)		
	REST AREA (VAULT TOILET)		
	WAYSIDE (VAULT OR PIT TOILET)		
	PARK AND RIDE LOT		
	PORT OF ENTRY		
	PUBLIC ACCESS POINT		
	MN STATE COLLEGE AND UNIVERSITY SYSTEM (MNSCU)		
	UNIVERSITY OF MN SYSTEM		
	FARMS		
	CULTURAL FEATURES		
	STATE HISTORICAL MARKER		
	HISTORIC DISTRICT		
	HISTORIC SITE		
	MONUMENT		

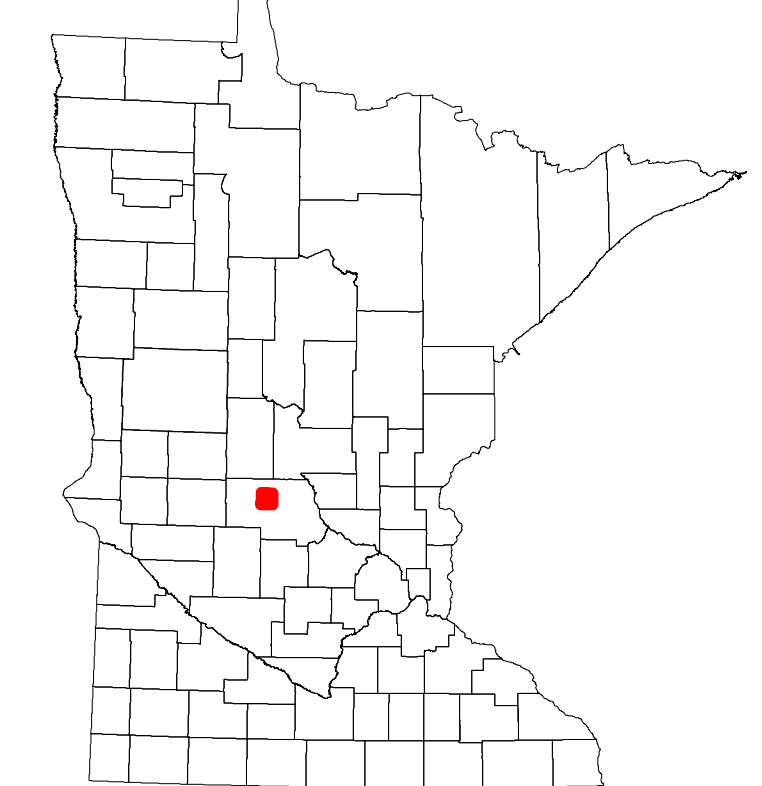

Population (U.S. Census 2010): 595

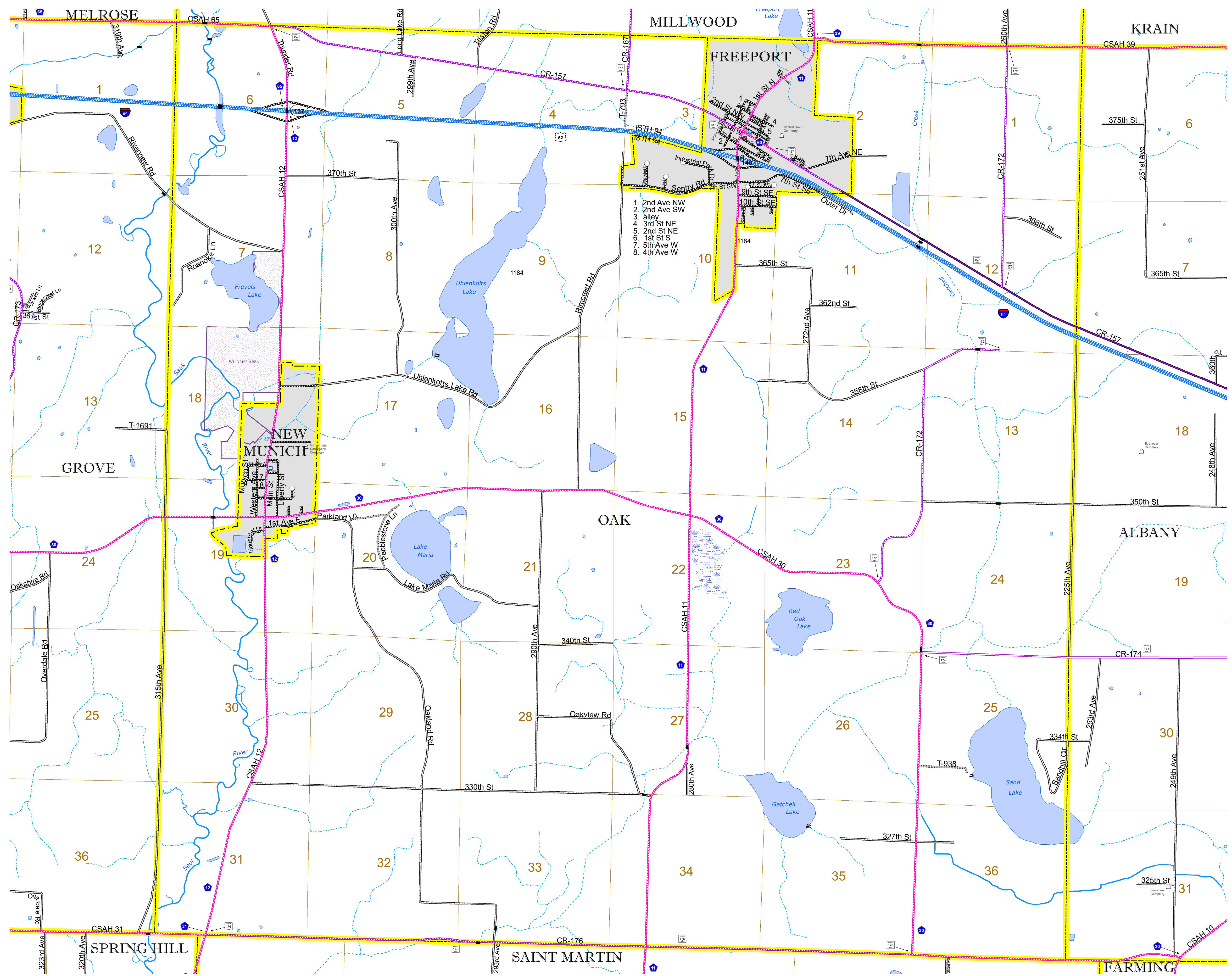

To request information from this document in an alternative format, call 651-366-4718 or 1-800-657-3774 (Greater Minnesota); 711 or 1-800-627-3529 (Minnesota Relay). You may also send an e-mail to ADARquest.dot@state.mn.us. (Please request at least one week in advance.)