

TOWNSHIP OF HAVANA

PREPARED BY THE
MINNESOTA DEPARTMENT OF TRANSPORTATION
OFFICE OF TRANSPORTATION SYSTEM MANAGEMENT

IN COOPERATION WITH
U.S. DEPARTMENT OF TRANSPORTATION
FEDERAL HIGHWAY ADMINISTRATION

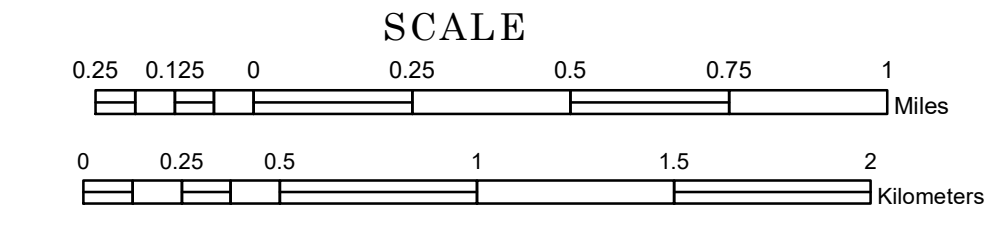

2023

Projection:
Transverse Mercator
NAD 1986
UTM Zone 15

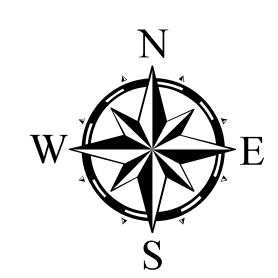

North American Datum
of 1986

ROAD AND ROADWAY FEATURES	
INTERSTATE	CONCRETE
US HIGHWAY	BITUMINOUS
MN HIGHWAY	GRAVEL
COUNTY STATE AID HIGHWAY	DIRT/UNIMPROVED
COUNTY ROAD	OTHER
TOWNSHIP ROAD	UNKNOWN
UNORGANIZED TERRITORY ROAD	
OTHER ROADS	
MUNICIPAL	RAMP OR CONNECTOR
PRIVATE	INTERSTATE EXIT
NATIONAL MONUMENT	AVIATION FEATURES
STATE FOREST	COMMERCIAL AIRPORT
NATIONAL PARK	GENERAL AIRPORT
NATIONAL WILDLIFE REFUGUE	AIRSTRIP
STATE PARK	SEAPLANE
PRESERVE	AIRPORT RUNWAY
RAILROAD AND RAILWAY FEATURES	
EMPIRE BUILDER STATION (AMTRAK)	TRIBAL LAND
NORTHSTAR STATION (COMPUTER)	STATE OF MINNESOTA
LIGHT RAIL	COUNTY
BLUE LINE	MUNICIPALITY
GREEN LINE	UNORGANIZED TERRITORY
	FEDERAL ADJUSTED URBAN AREA (2014)
INFRASTRUCTURE FEATURES	
LONG BRIDGE (200' OR GREATER SPAN)	CIVIL TOWNSHIP
MAJOR BRIDGE (20' TO 200' SPAN)	CONGRESSIONAL TOWNSHIP
MINOR BRIDGE (5' TO 20' SPAN)	SECTION
DAM	MILITARY
LOCK AND DAM	VOYAGEUR'S NATIONAL PARK
	BOUNDARY WATERS CANOE AREA WILDERNESS
CITY CENTERS	
STATE CAPITAL	STATE PARK
COUNTY SEAT	REGIONAL PARK
CITY CENTER	NATIONAL FOREST
COMMUNITY	NATIONAL AND STATE FOREST
	STATE FOREST
	NATIONAL TRAIL
	WILDLIFE REFUGUE AREA
	WILDLIFE MANAGEMENT AREA
PUBLIC SERVICE FEATURES	
MNDOT OFFICE	HYDROLOGIC FEATURES
MNDOT TRUCK STATION	RIVER OR STREAM (PERMANENT)
HIGHWAY PATROL DISTRICT OFFICE	LAKE, POND OR RESERVOIR
STATE TRAVEL INFORMATION CENTER	STREAM (INTERMITTENT)
REST AREA (FULL SERVICE)	DRAINAGE DITCH
REST AREA (VAULT TOILET)	WETLAND
WAYSIDE (VAULT OR PITY TOILET)	ISLAND OR LAND
PARK AND RIDE LOT	REGIONAL WATERSHED
PORT OF ENTRY	
PUBLIC ACCESS POINT	
MN STATE COLLEGE AND UNIVERSITY SYSTEM (MNSCU)	
UNIVERSITY OF MN SYSTEM	
FAIRGROUNDS	
CULTURAL FEATURES	
STATE HISTORICAL MARKER	
HISTORIC DISTRICT	
HISTORIC SITE	
MONUMENT	

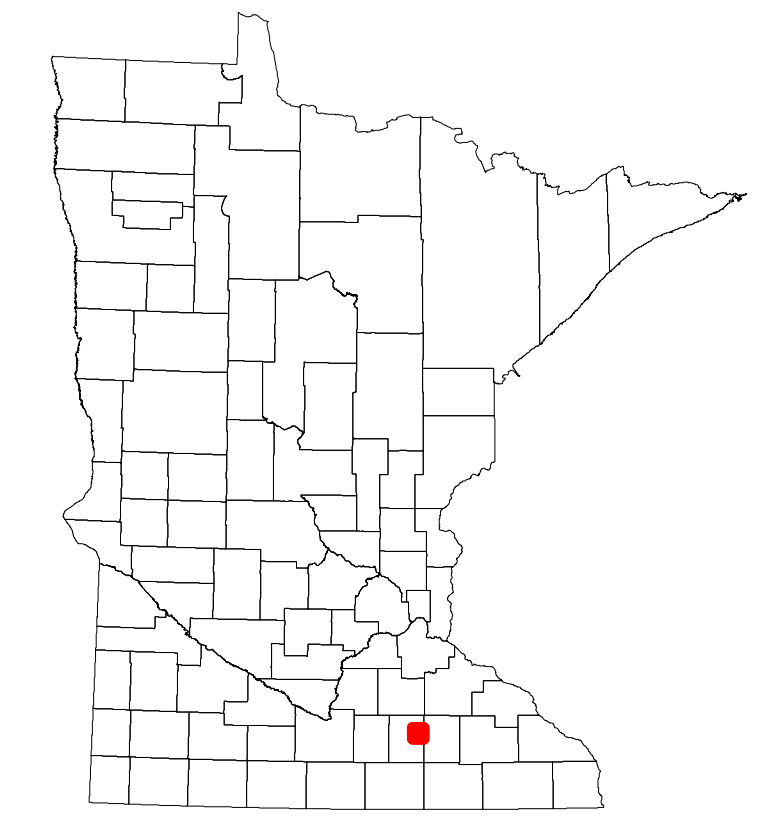

Population (U.S. Census 2010): 570

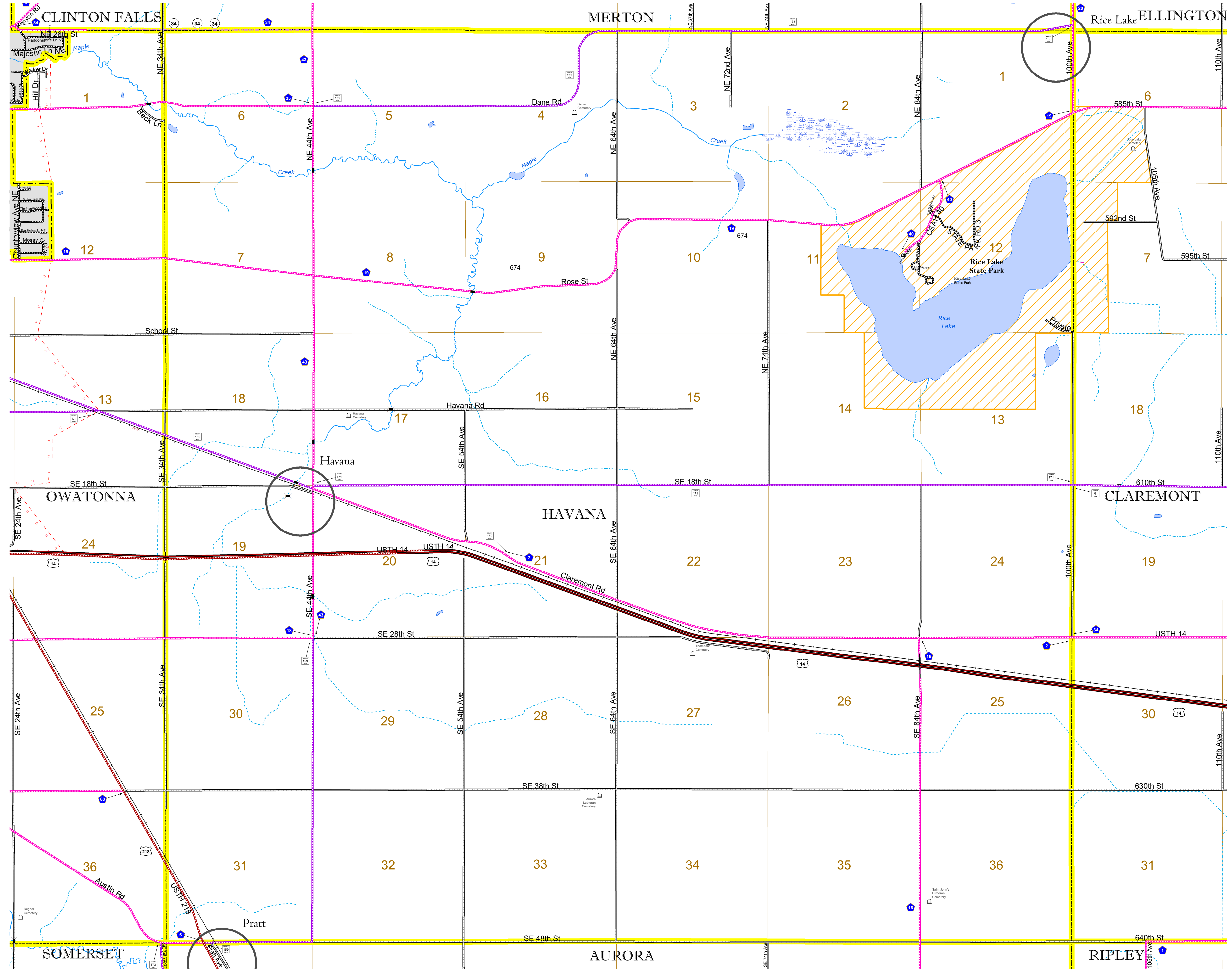

To request information from this document in an alternative format, call 651-366-4718 or 1-800-657-3774 (Greater Minnesota); 711 or 1-800-627-3529 (Minnesota Relay). You may also send an e-mail to ADAREquest.dot@state.mn.us. (Please request at least one week in advance.)