

TOWNSHIP OF STOWE PRAIRIE

PREPARED BY THE
MINNESOTA DEPARTMENT OF TRANSPORTATION
OFFICE OF TRANSPORTATION SYSTEM MANAGEMENT

IN COOPERATION WITH
U.S. DEPARTMENT OF TRANSPORTATION
FEDERAL HIGHWAY ADMINISTRATION

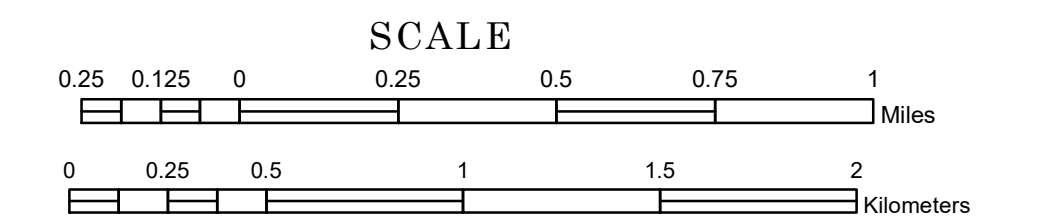

1 in = 1,600 ft
2023

Projection:
Transverse Mercator
NAD 1986
UTM Zone 15

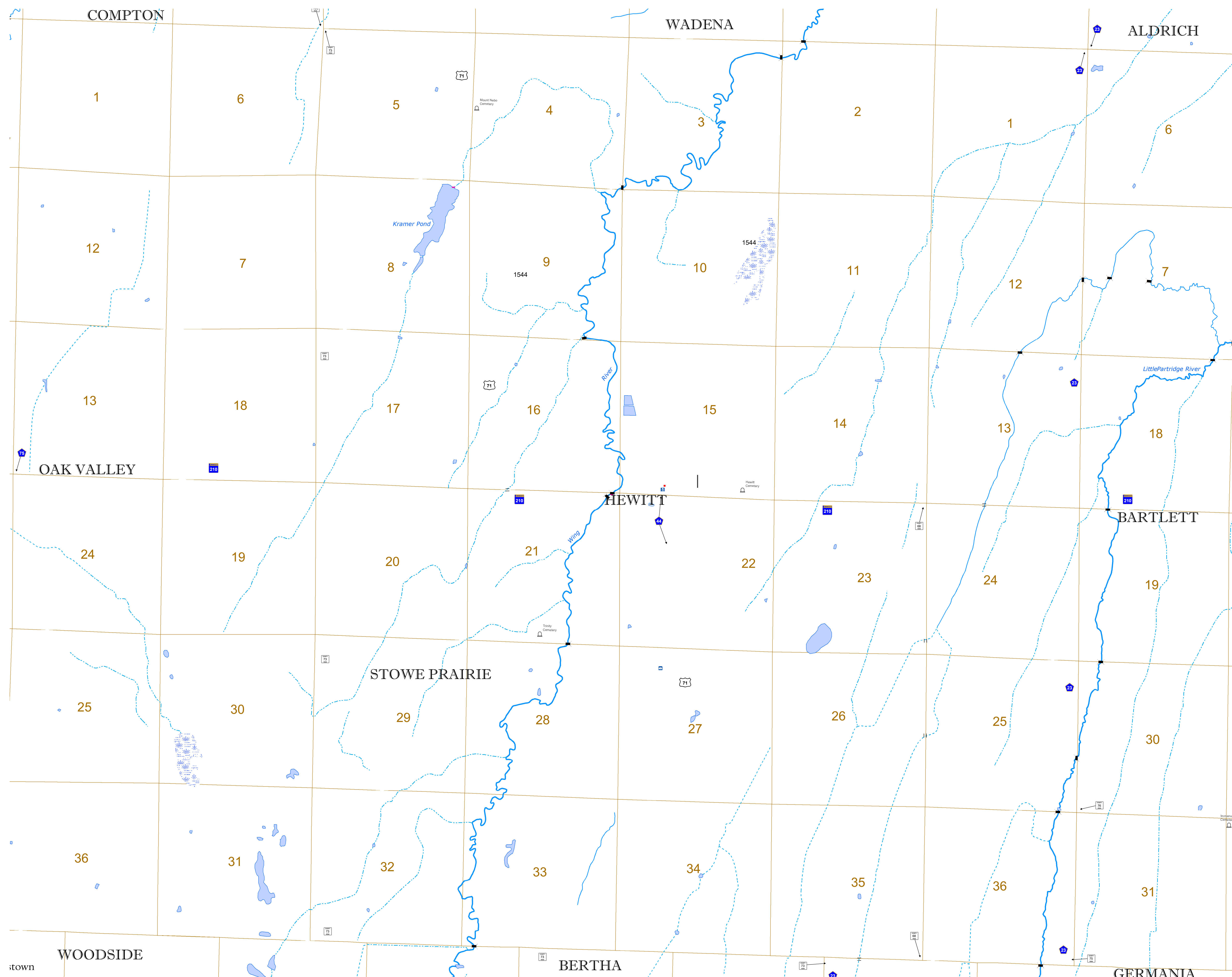
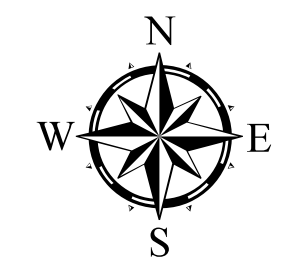

ROAD AND ROADWAY FEATURES		AVIATION FEATURES	
INTERSTATE	CONCRETE	COMMERCIAL AIRPORT	GENERAL AIRPORT
US HIGHWAY	BITUMINOUS	AIRSTRIP	AIRSTRIP
MN HIGHWAY	GRAVEL	SEAPLANE	AIRPORT RUNWAY
COUNTY STATE AID HIGHWAY	DIRT/UNIMPROVED	OTHER	UNKNOWN
COUNTY ROAD	OTHER	UNKNOWN	UNKNOWN
TOWNSHIP ROAD	UNKNOWN	UNKNOWN	UNKNOWN
UNORGANIZED TERRITORY ROAD	UNKNOWN	UNKNOWN	UNKNOWN
OTHER ROADS	RAMP OR CONNECTOR	INTERSTATE EXIT	GREAT RIVER ROAD
Municipal	National Monument	State Forest	State Game
Nature Service	National Park	National Wildlife	State Park
Military	Preserve		
RAILROAD AND RAILWAY FEATURES		BOUNDARY FEATURES	
EMPIRE BUILDER STATION (AMTRAK)	TRIBAL LAND	STATE OF MINNESOTA	COUNTY
NORTHSTAR STATION (COMMUTER)	STATE OF MINNESOTA	MUNICIPALITY	UNORGANIZED TERRITORY
LIGHT RAIL	STATE OF MINNESOTA	FEDERAL ADJUSTED URBAN AREA (2014)	CIVIL TOWNSHIP
BLUE LINE	STATE OF MINNESOTA	CONGRESSIONAL TOWNSHIP	SECTION
GREEN LINE	STATE OF MINNESOTA	MILITARY	VOYAGEURS NATIONAL PARK
LONG BRIDGE (200' OR GREATER SPAN)	STATE OF MINNESOTA	BOUNDARY WATERS CANOE AREA WILDERNESS	STATE PARK
MAJOR BRIDGE (20' TO 200' SPAN)	STATE OF MINNESOTA	REGIONAL PARK	NATIONAL FOREST
MINOR BRIDGE (5' TO 20' SPAN)	STATE OF MINNESOTA	NATIONAL AND STATE FOREST	STATE FOREST
DAM	STATE OF MINNESOTA	NATIONAL TRAIL	WILDLIFE REFUGUE AREA
LOCK AND DAM	STATE OF MINNESOTA	WILDLIFE MANAGEMENT AREA	HYDROLOGIC FEATURES
	STATE OF MINNESOTA	RIVER OR STREAM (PERENNIAL)	LAKE, POND OR RESERVOIR
	STATE OF MINNESOTA	STREAM (INTERMITTENT)	DRAINAGE DITCH
	STATE OF MINNESOTA	WETLAND	ISLAND OR LAND
	STATE OF MINNESOTA	REGIONAL WATERSHED	

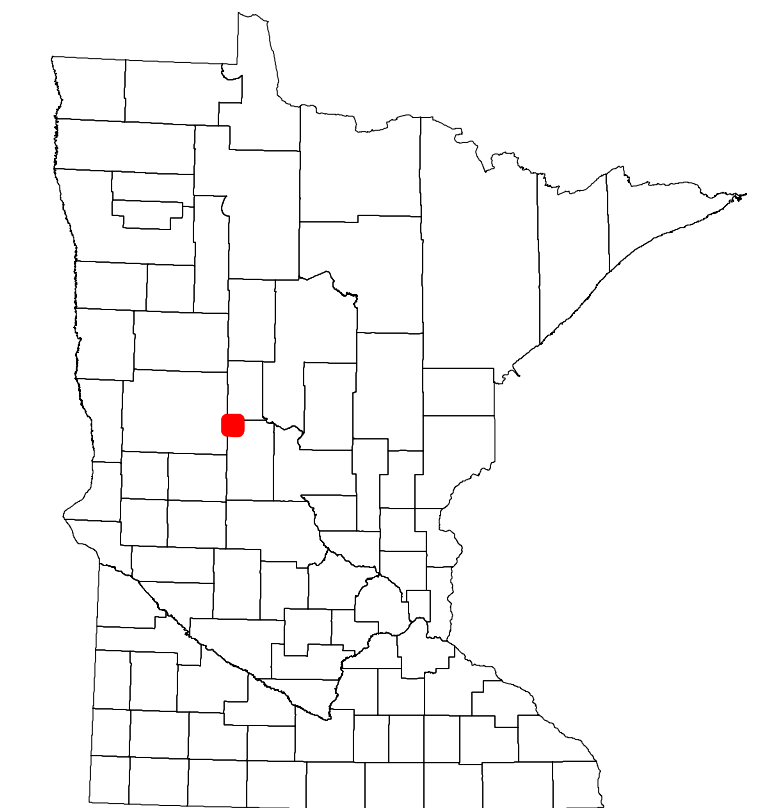

To request information from this document in an alternative format, call 651-366-4718 or 1-800-657-3774 (Greater Minnesota); 711 or 1-800-627-3529 (Minnesota Relay). You may also send an e-mail to ADarequest.dot@state.mn.us. (Please request at least one week in advance.)