

TOWNSHIP OF CHAMPION

PREPARED BY THE
MINNESOTA DEPARTMENT OF TRANSPORTATION
OFFICE OF TRANSPORTATION SYSTEM MANAGEMENT

IN COOPERATION WITH
U.S. DEPARTMENT OF TRANSPORTATION
FEDERAL HIGHWAY ADMINISTRATION



1 in = 1,600 ft
2023

Projection:
Transverse Mercator
NAD 1986
UTM Zone 15



ROAD AND ROADWAY FEATURES		AVIATION FEATURES	
INTERSTATE		CONCRETE	
US HIGHWAY		BITUMINOUS	
MN HIGHWAY		GRAVEL	
COUNTY STATE AID HIGHWAY		DIRT/UNIMPROVED	
COUNTY ROAD		OTHER	
TOWNSHIP ROAD		UNKNOWN	
UNORGANIZED TERRITORY ROAD		RAMP OR CONNECTOR	
OTHER ROADS		INTERSTATE EXIT	
Municipal		PRIVATE	
National Park		National Wildlife	
National Forest		State Park	
Military		Preserve	
RAILROAD AND RAILWAY FEATURES		BOUNDARY FEATURES	
EMPIRE BUILDER STATION (AMTRAK)		TRIBAL LAND	
NORTHSTAR STATION (COMPUTER)		STATE OF MINNESOTA	
LIGHT RAIL		COUNTY	
BLUE LINE		MUNICIPALITY	
GREEN LINE		UNORGANIZED TERRITORY	
LONG BRIDGE (200' OR GREATER SPAN)		FEDERAL ADJUSTED URBAN AREA (2014)	
MAJOR BRIDGE (20' TO 200' SPAN)		CIVIL TOWNSHIP	
MINOR BRIDGE (5' TO 20' SPAN)		CONGRESSIONAL TOWNSHIP	
DAM		SECTION	
LOCK-AND-DAM		MILITARY	
STATE CAPITAL		VOYAGEURS NATIONAL PARK	
COUNTY SEAT		BOUNDARY NATURAL SCIENCE AREA WILDERNESS	
CITY CENTER		STATE PARK	
UNINCORPORATED COMMUNITY		REGIONAL PARK	
MNDOT OFFICE		NATIONAL FOREST	
MNDOT TRUCK STATION		NATIONAL AND STATE FOREST	
HIGHWAY PATROL DISTRICT OFFICE		STATE FOREST	
STATE TRAVEL INFORMATION CENTER		NATIONAL TRAIL	
REST AREA (FULL SERVICE)		WILDLIFE REFUGUE AREA	
REST AREA (VAULT TOILET)		WILDLIFE MANAGEMENT AREA	
WAYSIDE (VAULT OR PIT TOILET)		HYDROLOGIC FEATURES	
PARK AND RIDE LOT		RIVER OR STREAM (PERENNIAL)	
PORT OF ENTRY		LAKE, POND OR RESERVOIR	
PUBLIC ACCESS POINT		STREAM (INTERMITTENT)	
MN STATE COLLEGE AND UNIVERSITY SYSTEM (MNSCU)		DRAINAGE DITCH	
UNIVERSITY OF MN SYSTEM		WETLAND	
FARMGROUNDS		ISLAND OR LAND	
STATE HISTORICAL MARKER		REGIONAL WATERSHED	
HISTORIC DISTRICT			
HISTORIC SITE			
MONUMENT			

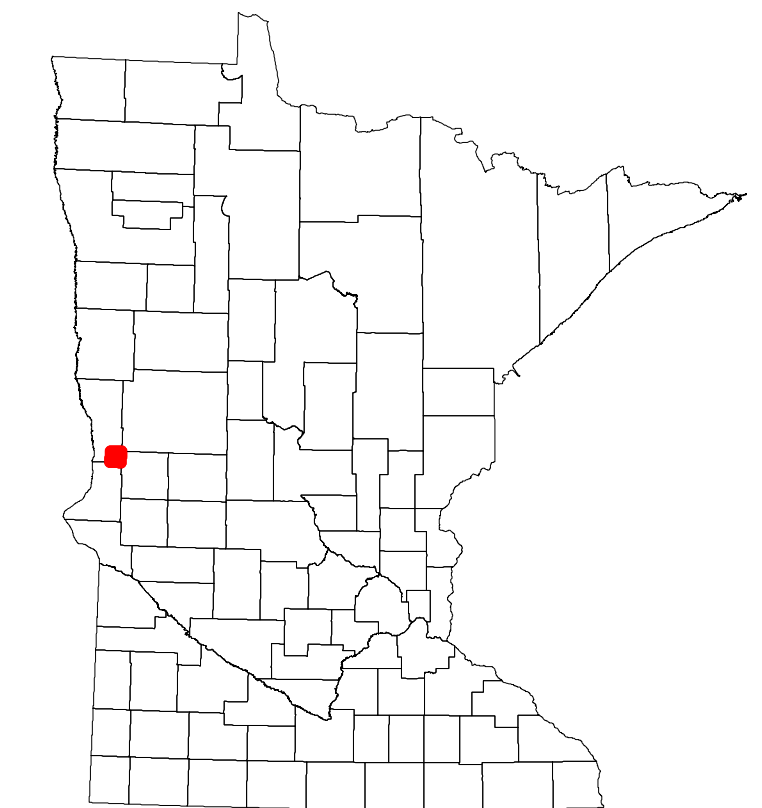

Population (U.S. Census 2010): 53

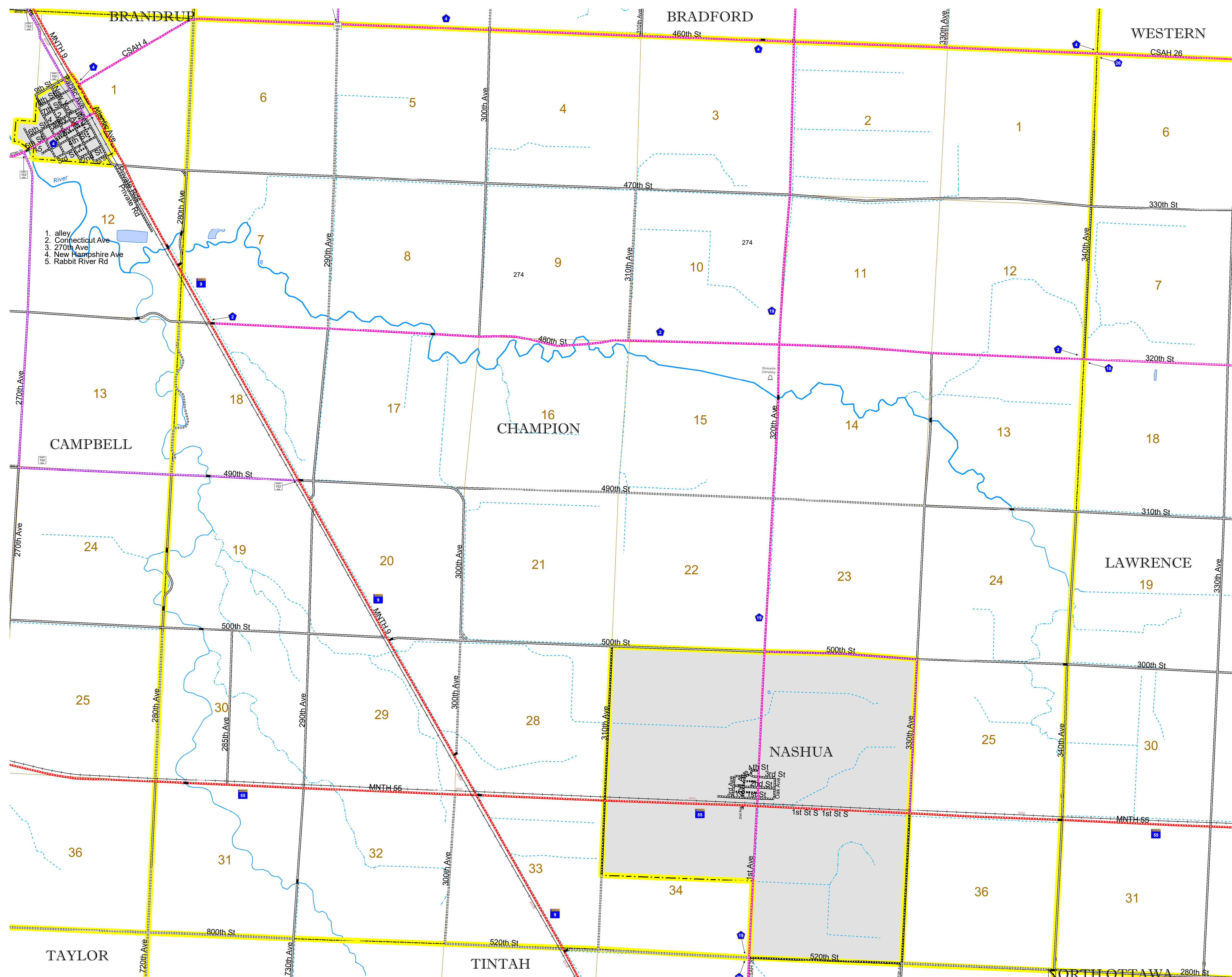

To request information from this document in an alternative format, call 651-366-4718 or 1-800-657-3774 (Greater Minnesota); 711 or 1-800-627-3529 (Minnesota Relay). You may also send an e-mail to ADArequest.dot@state.mn.us. (Please request at least one week in advance.)