

TOWNSHIP OF NORDICK

PREPARED BY THE
MINNESOTA DEPARTMENT OF TRANSPORTATION
OFFICE OF TRANSPORTATION SYSTEM MANAGEMENT

IN COOPERATION WITH
U.S. DEPARTMENT OF TRANSPORTATION
FEDERAL HIGHWAY ADMINISTRATION

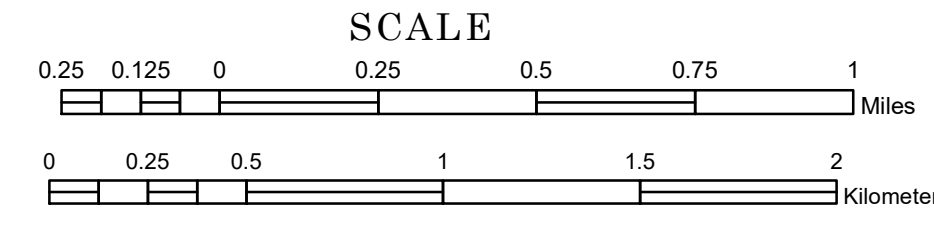

1 in = 1,600 ft
2023

Projection:
Transverse Mercator
NAD 1986
UTM Zone 15



North American Datum
of 1986

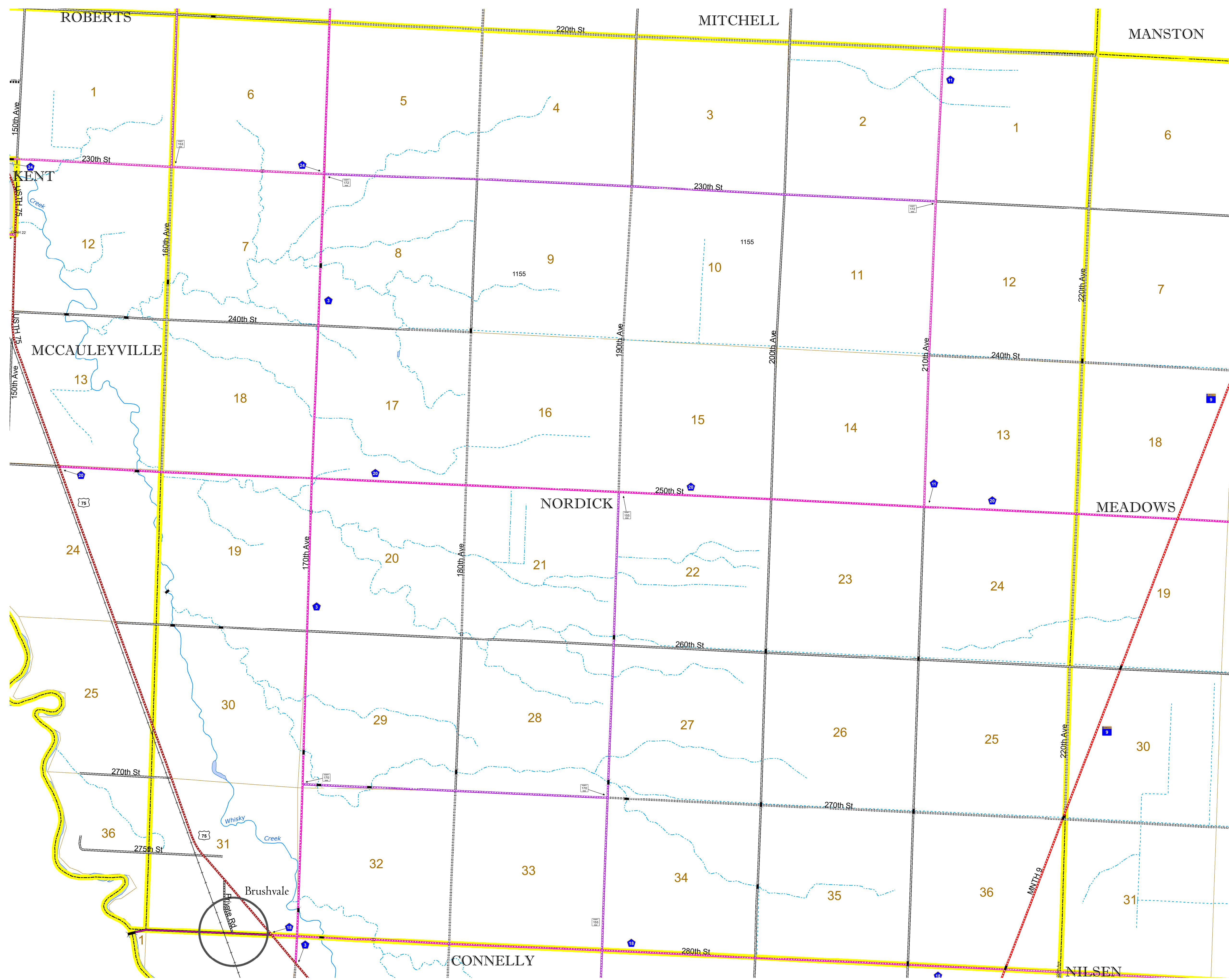

ROAD AND ROADWAY FEATURES	AVIATION FEATURES
INTERSTATE	COMMERCIAL AIRPORT
US HIGHWAY	GENERAL AIRPORT
MN HIGHWAY	AIRSTRIP
COUNTY STATE AID HIGHWAY	SEAPLANE
COUNTY ROAD	AIRPORT RUNWAY
TOWNSHIP ROAD	BOUNDARY FEATURES
UNORGANIZED TERRITORY ROAD	TRIBAL LAND
OTHER ROADS	STATE OF MINNESOTA
Municipal	COUNTY
Private	MUNICIPALITY
National Monument	UNORGANIZED TERRITORY
National Park	FEDERAL ADJUSTED URBAN AREA (2014)
National Wildlife Refuge	CIVIL TOWNSHIP
State Game Preserve	CONGRESSIONAL TOWNSHIP
	SECTION
	MILITARY
	VOYAGEURS NATIONAL PARK
	BOUNDARY WATERS CANOE AREA WILDERNESS
	STATE PARK
	REGIONAL PARK
	NATIONAL FOREST
	NATIONAL AND STATE FOREST
	STATE FOREST
	NATIONAL TRAIL
	WILDLIFE REFUGUE AREA
	WILDLIFE MANAGEMENT AREA
	HYDROLOGIC FEATURES
	RIVER OR STREAM (PERENNIAL)
	LAKE, POND OR RESERVOIR
	STREAM (INTERMITTENT)
	DRAINAGE DITCH
	WETLAND
	ISLAND OR LAND
	REGIONAL WATERSHED

RAILROAD AND RAILWAY FEATURES	CITY CENTERS
EMPIRE BUILDER STATION (AMTRAK)	STATE CAPITAL
NORTHSTAR STATION (COMPUTER)	COUNTY SEAT
LIGHT RAIL	CITY CENTER
BLUE LINE	UNINCORPORATED COMMUNITY
GREEN LINE	
INFRASTRUCTURE FEATURES	
LONG BRIDGE (300' OR GREATER SPAN)	
MAJOR BRIDGE (20' TO 300' SPAN)	
MINOR BRIDGE (5' TO 20' SPAN)	
DAM	
LOCK AND DAM	
PUBLIC SERVICE FEATURES	
MN DOT OFFICE	
MN DOT TRUCK STATION	
HIGHWAY PATROL DISTRICT OFFICE	
STATE TRAVEL INFORMATION CENTER	
REST AREA (FULL SERVICE)	
REST AREA (VAULT TOILET)	
WAYSIDE (VAULT OR PIT TOILET)	
PARK AND RIDE LOT	
PORT OF ENTRY	
PUBLIC ACCESS POINT	
MN STATE COLLEGE AND UNIVERSITY SYSTEM (MNSCU)	
UNIVERSITY OF MN SYSTEM	
FAIRGROUNDS	
CULTURAL FEATURES	
STATE HISTORICAL MARKER	
HISTORIC DISTRICT	
HISTORIC SITE	
MONUMENT	

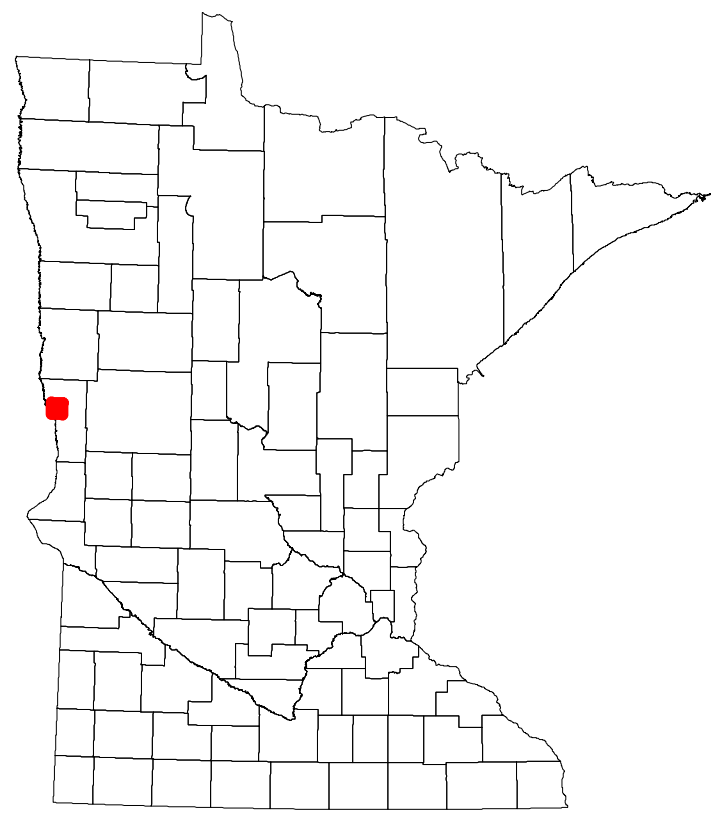

Population (U.S. Census 2010): 87

To request information from this document in an alternative format, call 651-366-4718 or 1-800-657-3774 (Greater Minnesota); 711 or 1-800-627-3529 (Minnesota Relay). You may also send an e-mail to ADRequest.dot@state.mn.us. (Please request at least one week in advance.)