

# TOWNSHIP OF ALBION

PREPARED BY THE  
MINNESOTA DEPARTMENT OF TRANSPORTATION  
OFFICE OF TRANSPORTATION SYSTEM MANAGEMENT

IN COOPERATION WITH  
U.S. DEPARTMENT OF TRANSPORTATION  
FEDERAL HIGHWAY ADMINISTRATION

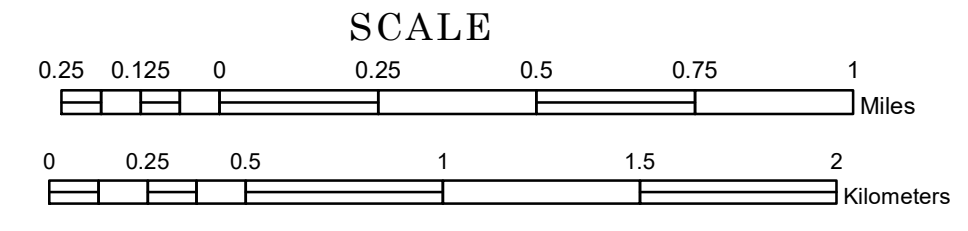

2024

Projection:  
Transverse Mercator  
NAD 1986  
UTM Zone 15

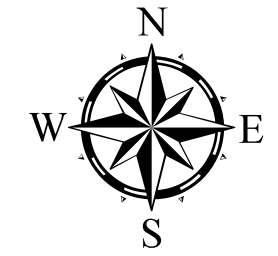

North American Datum  
of 1986

ROAD AND ROADWAY FEATURES	
INTERSTATE	CONCRETE
US HIGHWAY	BITUMINOUS
MN HIGHWAY	GRAVEL
COUNTY STATE AID HIGHWAY	DIRT/UNIMPROVED
COUNTY ROAD	OTHER
TOWNSHIP ROAD	UNKNOWN
UNORGANIZED TERRITORY ROAD	
OTHER ROADS	RAMP OR CONNECTOR
Municipal	Private
National Monument	State Forest
National Park	National Wildlife
National Forest	State Park
Present	State Park
RAILROAD AND RAILWAY FEATURES	AVIATION FEATURES
EMPIRE BUILDER STATION (AMTRAK)	GENERAL AIRPORT
NORTHSTAR STATION (COMMUTER)	AIRSTRIP
LIGHT RAIL	SEAPLANE
BLUE LINE	AIRPORT RUNWAY
GREEN LINE	BOUNDARY FEATURES
LONG BRIDGE (200' OR GREATER SPAN)	TRIBAL LAND
MAJOR BRIDGE (20' TO 200' SPAN)	STATE OF MINNESOTA
MINOR BRIDGE (5' TO 20' SPAN)	COUNTY
DAM	MUNICIPALITY
LOCK AND DAM	UNORGANIZED TERRITORY
	FEDERAL ADJUSTED URBAN AREA (2014)
	CITY TOWNSHIP
STATE CAPITAL	CITY CENTER
COUNTY SEAT	UNINCORPORATED COMMUNITY
	SECTION
	MILITARY
MNDOT OFFICE	VOYAGEURS NATIONAL PARK
MNDOT TRUCK STATION	BOUNDARY WATERS CANOE AREA WILDERNESS
HIGHWAY PATROL DISTRICT OFFICE	STATE PARK
STATE TRAVEL INFORMATION CENTER	NATIONAL FOREST
REST AREA (Full Service)	NATIONAL AND STATE FOREST
REST AREA (Vault Toilet)	STATE FOREST
WAYSIDE (Vault or Pit Toilet)	NATIONAL TRAIL
PARK AND RIDE LOT	WILDLIFE REFUGUE AREA
PORT OF ENTRY	WILDLIFE MANAGEMENT AREA
PUBLIC ACCESS POINT	HYDROLOGIC FEATURES
MN STATE COLLEGE AND UNIVERSITY SYSTEM (MNSCU)	RIVER OR STREAM (PERENNIAL)
UNIVERSITY OF MN SYSTEM	LAKE, POND OR RESERVOIR
FARMS	STREAM (INTERMITTENT)
	DRAINAGE DITCH
	WETLAND
STATE HISTORICAL MARKER	ISLAND OR LAND
HISTORIC DISTRICT	REGIONAL WATERSHED
HISTORIC SITE	
MONUMENT	

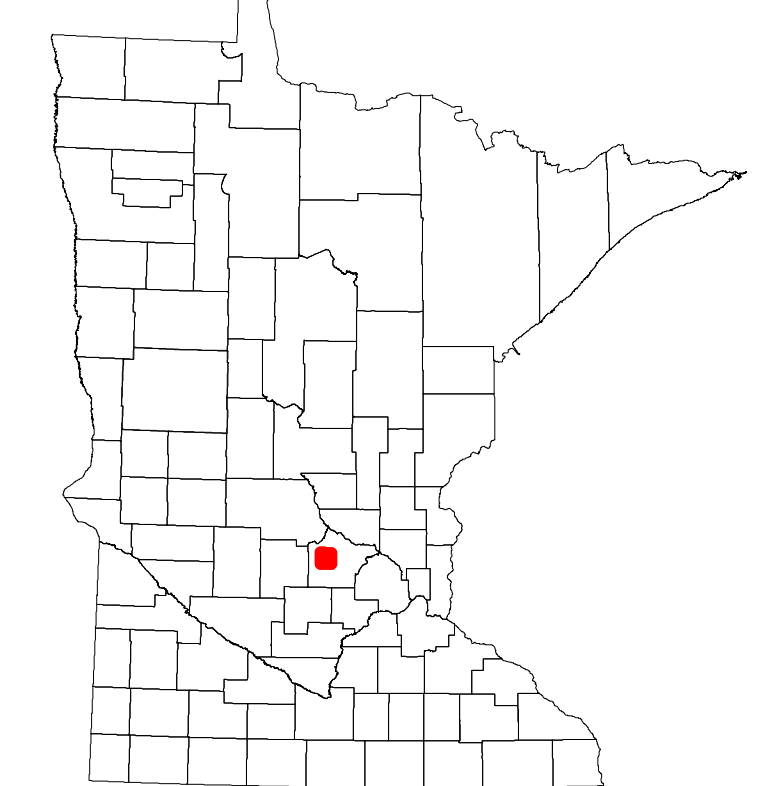

Population (U.S. Census 2010): 1255

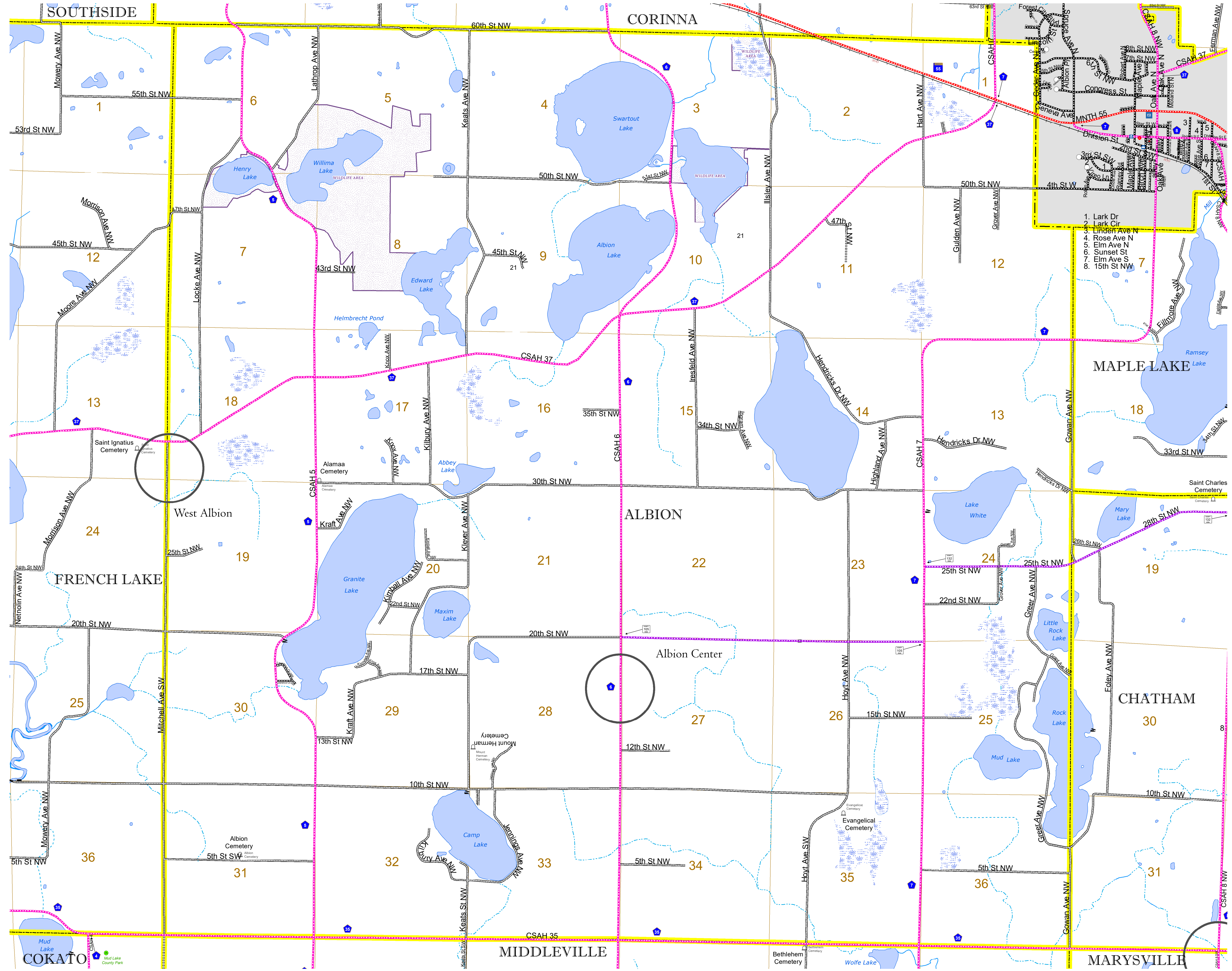

To request information from this document in an alternative format, call 651-366-4718 or 1-800-657-3774 (Greater Minnesota); 711 or 1-800-627-3529 (Minnesota Relay). You may also send an e-mail to ADARquest.dot@state.mn.us. (Please request at least one week in advance.)